

METRONOME™

Fig40



nienkämper

SHAPES, SIZES, SURFACE SHAPES, EDGE & BASE OPTIONS

2 SUPPORTS

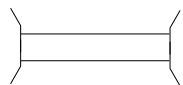

84" x 42" to 120" x 48"
note: 120" tops are in 2 pieces



48" x 48" to 72" x 72"
note: 66" & 72" tops are in 2 pieces



54" dia to 72" dia



3 SUPPORTS



132" x 48" to 216" x 60"



SURFACE SHAPES

Metronome Table top is 1¼" thick with overall table height 29"H.



super ellipse



boat



rectangle with radius corners



rectangle



square with radius corners



square



round

EDGE DETAILS



Taper Edge (TE)

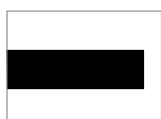

Self Edge (SE)

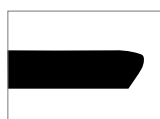

Facet Edge (FE)

FINISHES

All standard Nienkämper veneers and laminates.

On select finish types, 6" radius corners are available on rectangular shaped tops.

Where power troughs are located there are a number of finish options available for the inside surfaces of the trough.

BASE FINISHES

Metronome™ Tables are offered in a variety of finish options. Finishes can be matching in color and finish or mixed and matched to create a unique combination finish.

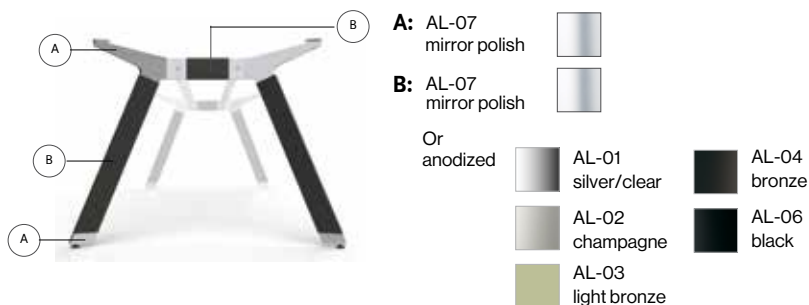

Base shown: illustrates combination finish. Matching finish consists of all components being visually equal.

The model number you select for the table base determines the finish of the base. For example: Model #39440/2 is a 120"x48" rectangular Metronome™ Table with a mirror polish finish. Model #39410/2 is the same shape and size with an anodized finish on portion "B" but with mirror polished finish on portion "A" as shown on above.

A & B in powder coat paint finish, see below options:



Metronome Table bases in red powder coat finish PC-09

For tables with bases in powder coat, list price is the same as anodized bases. To select powder coat finish, please use the model # of anodized bases and add "PC" at the end. For example, 39403PC/2 is a 84"Lx42"Dx29"H Metronome™ Table with no power trough and bases in powder coat finish.

Note: Stretcher rails are always silver anodized finish

VENEERS

All wood surfaces are protected with a durable polyurethane clear laquer with UV inhibitor. This finish is known for its exceptional durability, as well as abrasion, chemical, impact and scratch resistance. Standard sheen level is 45 degrees. Optional 10 and 35 degree sheen levels are available on request at no additional cost.

Wood Species	Order Code	Veneer/Stain	Upcharge
Maple	F-01	Natural Maple	No upcharge applies.
	F-02	Natural Curly Maple - Rotary Cut	Add 15%.
	F-03	Natural Bird's Eye Maple - Rotary Cut	Call Customer Service for pricing.
	F-04	Maple Stained Pear	No upcharge applies.
Cherry	F-05	Natural Cherry	No upcharge applies.
	F-06	Standard Cherry	No upcharge applies.
	F-07	Cherry Stained Amber	No upcharge applies.
	F-08	Cherry Stained Auburn	No upcharge applies.
	F-09	Cherry Stained Burgundy	No upcharge applies.
Mahogany	F-10	Light Mahogany	No upcharge applies.
	F-11	Medium Mahogany	No upcharge applies.
	F-12	Dark Mahogany	No upcharge applies.
	F-13	Red Mahogany	No upcharge applies.
Anagre	F-14	Natural Figured Anagre - Qtr. Cut Book-Match	Add 15%.
	F-15	Figured Anagre Stained Amber - Qtr. Cut Book-Match	Add 15%.
Sycamore	F-16	Natural Figured Sycamore - Qtr. Cut Book-Match	Add 15%.
Walnut	F-17	Burnt Walnut	No upcharge applies.
	F-19	Natural Walnut	No upcharge applies.
	F-24	Carbon Grey Walnut	No upcharge applies.
White Oak	F-18	Natural White Oak - Flat Cut Book-Match (10° sheen)	No upcharge applies.
		Natural White Oak - Rift Cut Slip-Match (10° sheen)	Add 5%
Sapele – Ribbon Stripe	F-20	Natural Ribbon Strip Sepele - Qtr. Cut Slip-Match	No upcharge applies.
Moabe (Cherry substitute)	F-21	Natural Moabe - Quarter - Qtr. Cut Book-Match	No upcharge applies.
Cape Coast Walnut	F-22	Dark Cape Coast Walnut - Qtr. Cut Slip-Match	No upcharge applies.
	F-23	Natural Cape Coast Walnut - Qtr. Cut Slip-Match	No upcharge applies.
Ash	F-25	Slate Grey Ash - Qtr. Cut Slip-Match	No upcharge applies.

VENEER GRAIN OPTIONS

Nienkamper products utilize the best quality veneers available, and, combined with Nienkämper's patented veneering systems, create work environments of incredible quality and beauty.

All veneer furniture comes standard with flat cut book-match veneer; flat cut slip-match veneer can also be specified. Quarter cut slip-match and quarter cut book-match veneers are available at a 5% upcharge. Figured Anagre and Figured Sycamore veneers are Quarter cut book-matched. Bird's Eye Maple and Curly Maple are rotary cut.

Facet Edge, Taper edge and Flowform edge tops with veneer are manufactured with a solid wood edge. All edges are then veneer wrapped to create a seamless profile top.

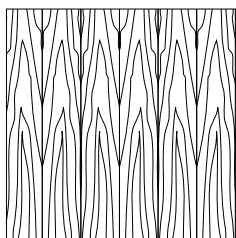

Standard Flat Cut Book-Match V1

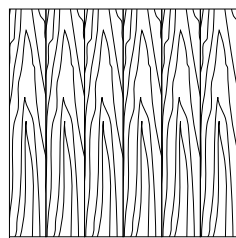

Flat Cut Slip-Match V2

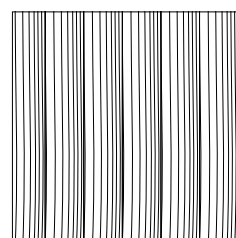

Quarter Cut Slip-Match Add 5% V3

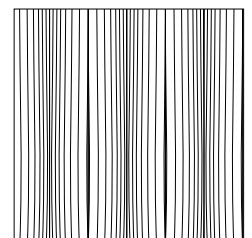

Quarter Cut Book-Match Add 5% V4

P-LAM

Wood grain plastic laminate surfaces are available on table tops with Facet and Taper edges.

These tops are manufactured with a solid wood edge that is applied prior to the laminate top surface. This method conceals the thickness of the wood edge, while providing the durability required. Wood edges are selected that most closely resemble both the species and the color of the laminate chosen

Nienkämper has pre-selected a number of standard wood grain plastic laminates that represent a cross section of both color and species. Simply include the order code with the model number to make these selections. Alternatively wood grain plastic laminates selected outside of Nienkämper's standard selection can be made by specifying the manufacturer as well as the description and model number of the laminate at the time of order. Note: for Facet edge tops the laminate must be a post-forming grade.

Wood Grain Plastic Laminate Surfaces	Order Code	Manufacturer #	Finish
Champagne Sagawood	WL1	Nevamar WM8349T	Textured
Hardrock Maple	WL2	Pionite WM791-SD	Textured/Suede
Amber Curly Maple	WL3	Pionite WM221-SD	Textured/Suede
Anagre	WL4	Pionite WX041-SD	Textured/Suede
Monticello Maple	WL5	Wilsonart 7925-38	Fine Velvet Texture
Millwork Cherry	WL7	Pionite WC431PV	PV-Polished Velvet
Figured Anagre	WL8	Formica7284-58	Matte
Huntington Maple	WL9	Wilsonart 7929-38	Fine Velvet Texture
Wild Cherry	WL10	Formica 5904.43	Artisan
Amber Cherry	WL11	Wilsonart 7919.38	Fine Velvet Texture
Figured Mahogany	WL12	Wilsonart 7040A-60	Matte
Fusion Maple	WL13	Wilsonart 7909-78	Fine Grain
New Age Oak	WL14	Wilsonart 7938-78	Fine Grain
Natural Pear	WL15	Wilsonart 7061-78	Fine Grain
Tuscan Walnut	WL16	Wilsonart 7921-78	Fine Grain
Nepal Teak	WL17	Wilsonart 7209-78	Fine Grain
Wild Cherry	WL18	Wilsonart 7054-78	Fine Grani
River Cherry	WL19	Wilsonart 7937-78	Fine Grain
Montana Walnut	WL20	Wilsonart 7110-78	Fine Grain
Sanara	WL21	Wilsonart 7932-78	Fine Grain
Windsor Mahogany	WL22	Wilsonart 7039-78	Fine Grain
Williamsburg Cherry	WL23	Wilsonart 7936-78	Fine Grain
Florence Walnut	WL25	Wilsonart 7993-78	Fine Grain
Skyline Walnut	WL26	Wilsonart 7964K-12	Soft Grain
Sterling Ash	WL27	Wilsonart 7995-78	Fine Grain

To specify the wood grain laminate required simply add the Order Code WL_ to the model number of the product.

Wood grain laminate samples are available from your local sales representative or by calling Nienkämper's customer service department at 1-800-668-9318.

P-LAM

COLOURED P-LAM

Both Taper and Facet edge profiles are available with a colored laminate top.

Laminate edging on Taper tops. Edging will match the top surface and is applied prior to the surface laminate. By applying the laminate in this way the seam is positioned horizontally, is much less conspicuous as well as more durable.

Wood edging on Facet and Taper Edge tops is applied prior to the laminate. By applying the wood edge in this way the thickness of the wood edge is concealed, while providing the durability required. Wood species and finishes for edging, can be selected from page 4.

For laminates specified outside of Nienkämper's standard selection, specify the manufacturer as well as the description and model number of the laminate selected at time of order. For Facet edge tops, the laminate must be a post forming grade.

Translucent edging on Taper edge tops is applied after the surface laminate. The translucent edge is very durable. Clear translucent edge provides a good match with most white colored laminates, while silver translucent edge provides a metallic look and contrast to colored plastic laminates.



Taper edge in clear translucent with white P-Lam top

Coloured Plastic Laminates Surface	Order Code	Manufacturer #	Finish
Grey (Nienkamper - Light Grey/Putty)	CL-01	Wilsonart 1500-60	Matte
Platinum Gray (Nienkamper - Medium Grey/Clay)	CL-02	Nevamar S6023T	Textured
Slate Grey (Nienkamper - Dark Grey)	CL-03	Wilsonart D91-60	Matte
Black	CL-04	Wilsonart 1595-60	Matte
Angel White	CL-05	Pionite SW-826SD	Textured/Suede
Frosty White	CL-06	Wilsonart 1573-60	Matte
White (for writable surface)	CL-07	Formica 949-90	Gloss

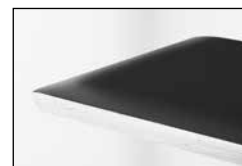

Add the order code behind the edge profile when specifying.

P-LAM

FINGERPRINT RESISTANCE P-LAM

Fingerprint Resistance Plastic Laminate is an innovative material created for interior design applications and is suitable for both vertical and horizontal interior applications on our nienkamper furniture.

The external surface of Fingerprint Resistance Plastic Laminate involves the use of nanotechnology made possible by next generation acrylic resins.

The unique composition offers extraordinary features coupled with a unique user experience. These include an ultra matt surface (eliminating glare), an ultra sofa feel, an anti-fingerprint surface, thermal healing of micro-scratches, increased durability as well as anti-bacterial and mold-resistant properties.

Edgeband with matching color to the Fingerprint Resistance Plastic Laminate is only available on taper edge. For 1" or 1-1/4" thick top with self edge, same Fingerprint Resistance Plastic Laminate can be specified for the self edge or it can be in clear/silver translucent edge.

There is a 10% upcharge on our standard plastic laminate table pricing for Fingerprint Resistance Plastic Laminate.

Colored "Fingerprint Resistance" Plastic Laminate Surface	Order Code	Finish
Black	RL-01	Matte
Gray	RL-02	Matte
Pure White	RL-03	Matte
Sand	RL-04	Matte
Bronze	RL-05	Matte

Edgeband to Match with Colored "Fingerprint Resistance" Plastic Laminate	Order Code
Black	RE-01
Gray	RE-02
Pure White	RE-03
Sand	RE-04
Bronze	RE-05

FORUM WIRING OPTIONS, CABLE MANAGEMENT

Metronome™ Tables have been developed to accommodate a surface mounted or trough mounted connectivity device installation.

surface-mounted connectivity

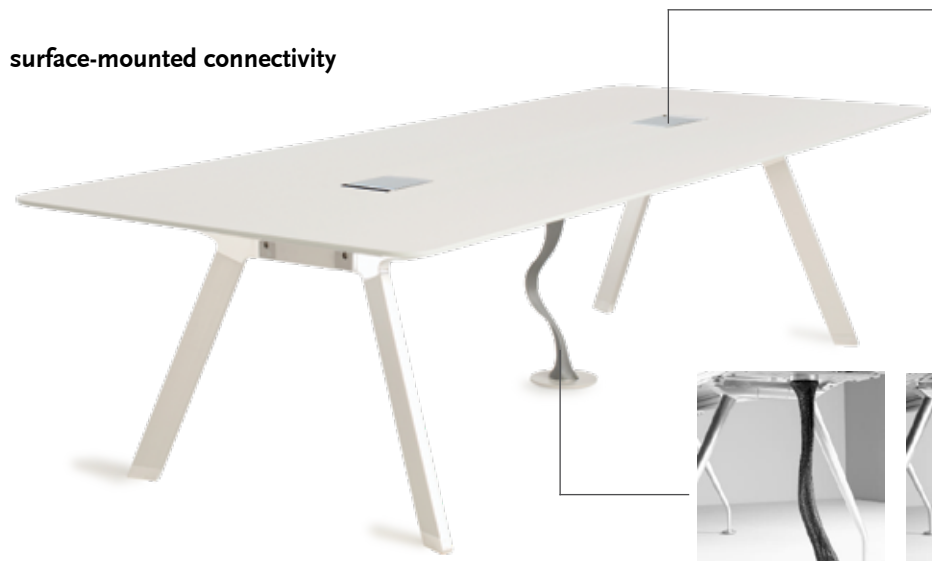

top mount
power/data options

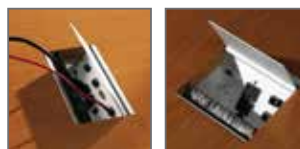

Vox® Forums are only available as a surface mount installation. Please consult customer service to determine which model best suits your needs. Vox® Forums are priced separately. See Vox® Forums configurator at www.nienkamper.com

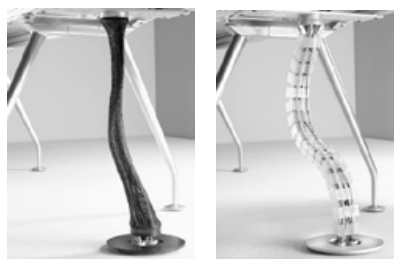

Expandable cable conduit Linked cable conduit

Cables are directed to the floor with either an expandable or linked cable conduit. Both solutions accommodate core drills with their large base ring. Wire capacity is 2"-4" dia for the expandable cable conduit and eighteen 16 GA cables for the linked. Both models are available in black, silver or clear.

surface-mounted connectivity wiring

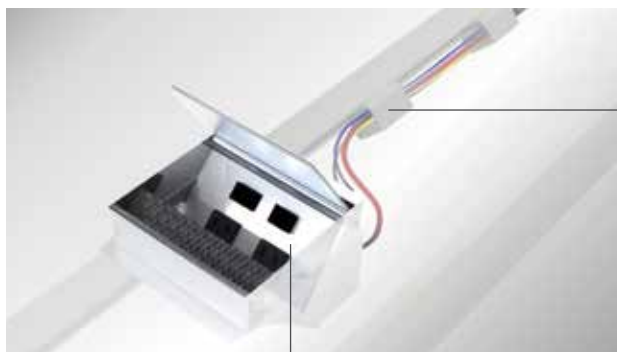

wire clip

Metronome™ Tables specified with Vox® Forums include plastic wire clips that guide cables from Forum to cable conduit.

Vox® forums

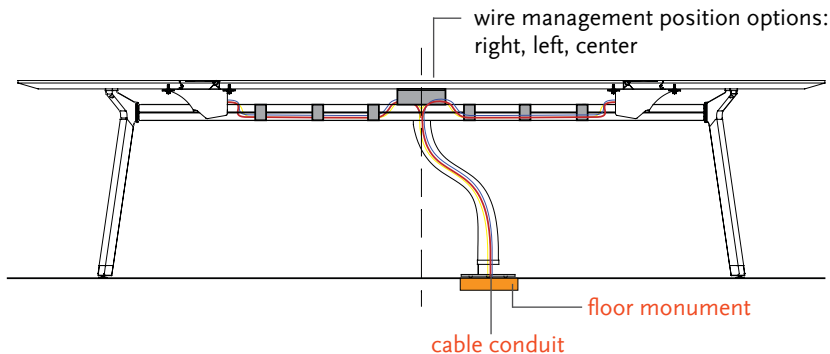

FORUM WIRING OPTIONS, CABLE MANAGEMENT

trough-mounted connectivity



Metronome troughs have two 6-port Simple Forum. See page 11-15 for Simple Forum options.

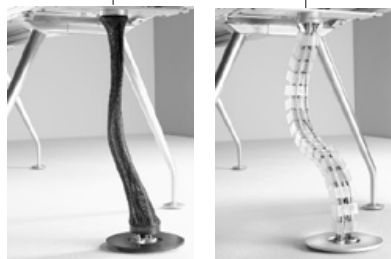

Expandable cable conduit

Linked cable conduit

Cables are directed to the floor with either an expandable or linked cable conduit. Both solutions accommodate core drills with their large base ring. Wire capacity is 2"-4" dia for the expandable cable conduit and eighteen 16 GA cables for the linked. Both models available in black, silver or clear color options.

trough-mounted connectivity wiring

Metronome™ Tables specified with a wire trough manage power box cables with an integrated lower cover. This directs the cables into the cable conduit.

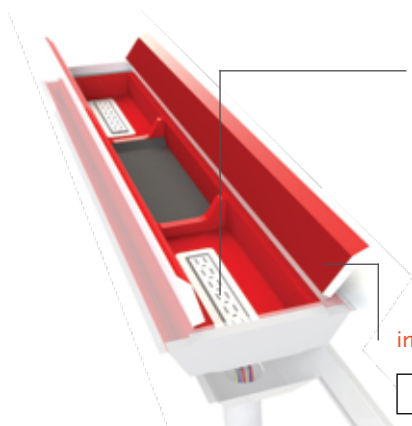

Simple Forum

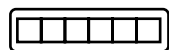

interior colors

- MT-01 Winter White
- MT-02 Ocean Blue
- MT-03 Lush Green
- MT-04 Passion Red
- MT-05 Midnight Black

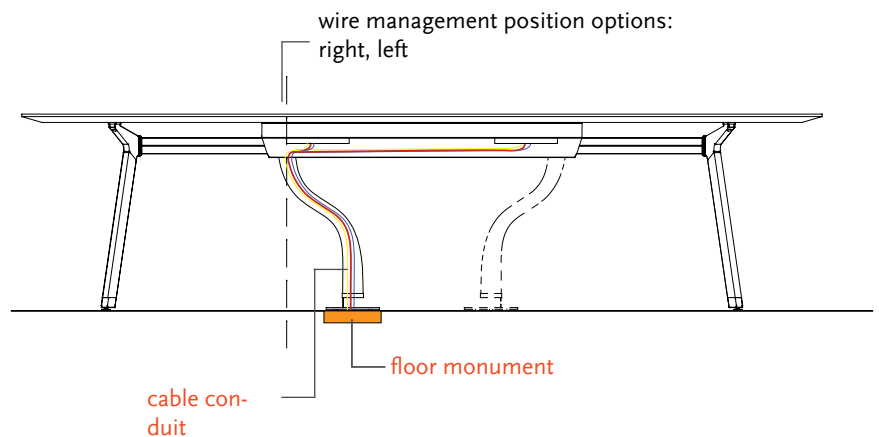

Contrasting interior finish for door and wire compartment is offered as standard. Trough door exterior material can be specified to match top, contrast to top or in brushed aluminum P-Lam (PL-25 Formica Deco Metal M2022) with upcharge. Contact customer service at 1 800 668 9318 for pricing.

WIRE TROUGH SPECIFICATION

Metronome™ Tables specified with wire troughs are pre-sized according to table length. Troughs are standard with 2 power boxes.

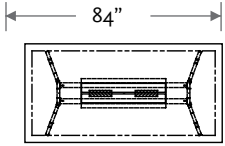

1-trough - 36"L
2-power/data boxes

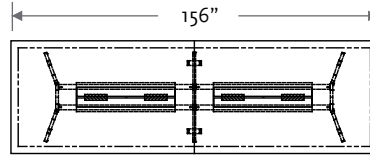

2-troughs - 42"L
4-power/data boxes

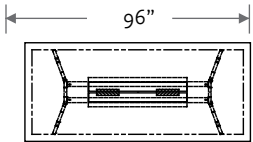

1-trough - 42"L
2-power/data boxes

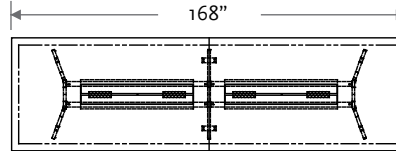

2-troughs - 48"L
4-power/data boxes

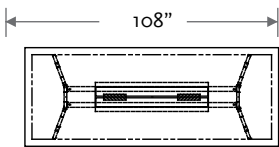

1-trough - 48"L
2-power/data boxes

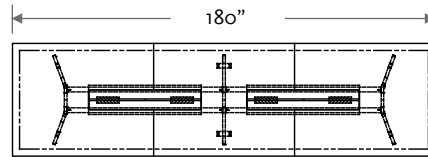

2-troughs - 48"L
4-power/data boxes

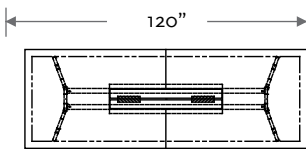

1-trough - 48"L
2-power/data boxes

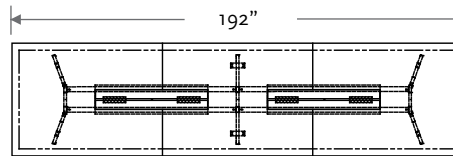

2-troughs - 48"L
4-power/data boxes

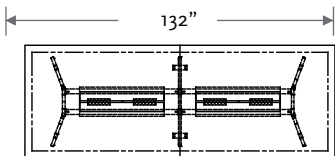

2-troughs - 36"L
4-power/data boxes

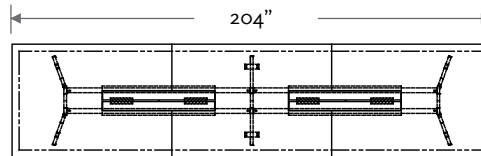

2-troughs - 48"L
4-power/data boxes

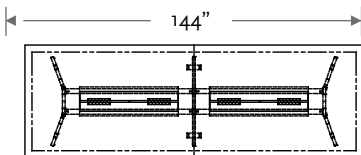

2-troughs - 42"L
4-power/data boxes

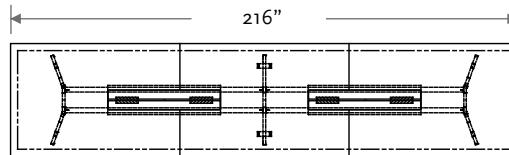

2-troughs - 48"L
4-power/data boxes

ELETRICS, POWER OPTIONS

List Price

Pre-configured simple forum

Model # 39941/5	pre-wired power	<table border="1"> <tr> <td>1P</td> <td>1P</td> <td>A0</td> <td>A0</td> <td>B</td> <td>B</td> </tr> </table>	1P	1P	A0	A0	B	B	\$585
1P	1P	A0	A0	B	B				
		<p>2 x pre-wired power with 10ft cord 2 x AMP CAT5E data with 9ft cord 2 x blank plate</p>							
Model # 39941/6	pre-wired power	<table border="1"> <tr> <td>1P</td> <td>1P</td> <td>A5</td> <td>A5</td> <td>B</td> <td>B</td> </tr> </table>	1P	1P	A5	A5	B	B	\$650
1P	1P	A5	A5	B	B				
		<p>2 x pre-wired power with 10ft cord 2 x SIEMON CAT6 data with 10ft cord 2 x blank plate</p>							
Model # 39942/5	site-wired power	<table border="1"> <tr> <td>1P-SW</td> <td>1P-SW</td> <td>A0</td> <td>A0</td> <td>B</td> <td>B</td> </tr> </table>	1P-SW	1P-SW	A0	A0	B	B	\$630
1P-SW	1P-SW	A0	A0	B	B				
		<p>2 x site-wired power with 6ft metallic shielded cable 2 x AMP CAT5E data with 9ft cord 2 x blank plate</p>							
Model # 39942/6	site-wired power	<table border="1"> <tr> <td>1P-SW</td> <td>1P-SW</td> <td>A5</td> <td>A5</td> <td>B</td> <td>B</td> </tr> </table>	1P-SW	1P-SW	A5	A5	B	B	\$705
1P-SW	1P-SW	A5	A5	B	B				
		<p>2 x site-wired power with 6ft metallic shielded cable 2 x SIEMON CAT6 data with 10ft cord 2 x blank plate</p>							
Model # 39943/5	pre-wired power	<table border="1"> <tr> <td>1P</td> <td>1P</td> <td>A0</td> <td>A0</td> <td>G</td> <td>C</td> </tr> </table>	1P	1P	A0	A0	G	C	\$720
1P	1P	A0	A0	G	C				
		<p>2 x pre-wired power with 10ft cord 2 x AMP CAT5E data with 9ft cord 1 x HD-DB15/VGA connector with 10ft cord 1 x audio 3.5mm mini stereo jack with 10 ft cord</p>							
Model # 39943/6	pre-wired power	<table border="1"> <tr> <td>1P</td> <td>1P</td> <td>A5</td> <td>A5</td> <td>G</td> <td>C</td> </tr> </table>	1P	1P	A5	A5	G	C	\$795
1P	1P	A5	A5	G	C				
		<p>2 x pre-wired power with 10ft cord 2 x SIEMON CAT6 data with 10ft cord 1 x HD-DB15/VGA connector with 10ft cord 1 x audio 3.5mm mini stereo jack with 10 ft cord</p>							
Model # 39944/5	site-wired power	<table border="1"> <tr> <td>1P-SW</td> <td>1P-SW</td> <td>A0</td> <td>A0</td> <td>G</td> <td>C</td> </tr> </table>	1P-SW	1P-SW	A0	A0	G	C	\$775
1P-SW	1P-SW	A0	A0	G	C				
		<p>2 x site-wired power with 6ft metallic shielded cable 2 x AMP CAT5E data with 9ft cord 1 x HD-DB15/VGA connector with 10ft cord 1 x audio 3.5mm mini stereo jack with 10ft cord</p>							

ELETRICS, POWER OPTIONS

List Price

Model # 39944/6 site-wired power

1P-SW	1P-SW	A5	A5	G	C
-------	-------	----	----	---	---

 \$845

2 x site-wired power with 6ft metallic shielded cable
 2 x SIEMON CAT6 data with 10ft cord
 1 x HD-DB15/VGA connector with 10ft cord
 1 x audio 3.5mm mini stereo jack with 10ft cord

Model # 39945/5 pre-wired power

1P	1P	A0	A0	HD	H
----	----	----	----	----	---

 \$735

2 x pre-wired power with 10ft cord
 2 x AMP CAT5E data with 9ft cord
 1 x HDMI coupler with 18" cord
 1 x USB port 3.0 with 10ft cord

Model # 39945/6 pre-wired power

1P	1P	A5	A5	HD	H
----	----	----	----	----	---

 \$810

2 x pre-wired power with 10ft cord
 2 x SIEMON CAT6 data with 10ft cord
 1 x HDMI coupler with 18" cord
 1 x USB port 3.0 with 10ft cord

Model # 39946/5 site-wired power

1P-SW	1P-SW	A0	A0	HD	H
-------	-------	----	----	----	---

 \$790

2 x site-wired power with 6ft metallic shielded cable
 2 x AMP CAT5E data with 9ft cord
 1 x HDMI coupler with 18" cord
 1 x USB port 3.0 with 10ft cord

Model # 39946/6 site-wired power

1P-SW	1P-SW	A5	A5	HD	H
-------	-------	----	----	----	---

 \$865

2 x site-wired power with 6ft metallic shielded cable
 2 x SIEMON CAT6 data with 10ft cord;
 1 x HDMI coupler with 18" cord
 1 x USB port 3.0 with 10ft cord

Model # 39947/5 pre-wired power

1P	1P	1P	A0	A0	A0
----	----	----	----	----	----

 \$655

3 x pre-wired power with 10ft cord
 3 x AMP CAT5E data with 9ft cord

Model # 39947/6 pre-wired power

1P	1P	1P	A5	A5	A5
----	----	----	----	----	----

 \$775

3 x pre-wired power with 10ft cord
 3 x SIEMON CAT6 data with 10ft cord

Model # 39948/5	site-wired power	<table border="1" style="border-collapse: collapse;"> <tr> <td style="padding: 2px;">1P-SW</td> <td style="padding: 2px;">1P-SW</td> <td style="padding: 2px;">1P-SW</td> <td style="padding: 2px;">A0</td> <td style="padding: 2px;">A0</td> <td style="padding: 2px;">A0</td> </tr> </table>	1P-SW	1P-SW	1P-SW	A0	A0	A0	\$710
1P-SW	1P-SW	1P-SW	A0	A0	A0				
		3 x site-wired power with 6ft metallic shielded cable 3 x AMP CAT5E data with 9ft cord							

Model # 39948/6	site-wired power	<table border="1" style="border-collapse: collapse;"> <tr> <td style="padding: 2px;">1P-SW</td> <td style="padding: 2px;">1P-SW</td> <td style="padding: 2px;">1P-SW</td> <td style="padding: 2px;">A5</td> <td style="padding: 2px;">A5</td> <td style="padding: 2px;">A5</td> </tr> </table>	1P-SW	1P-SW	1P-SW	A5	A5	A5	\$825
1P-SW	1P-SW	1P-SW	A5	A5	A5				
		3 x site-wired power with 6ft metallic shielded cable 3 x SIEMON CAT6 data with 10ft cord							

Pre-configured simple forum for client's own data fitting

Model # 39951	pre-wired power	<table border="1" style="border-collapse: collapse;"> <tr> <td style="padding: 2px;">1P</td> <td style="padding: 2px;">1P</td> <td style="padding: 2px;">O</td> <td style="padding: 2px;">O</td> <td style="padding: 2px;">O</td> <td style="padding: 2px;">O</td> </tr> </table>	1P	1P	O	O	O	O	\$475
1P	1P	O	O	O	O				
		2 x pre-wired power with 10ft cord 4 x open port/data adapter to fit in client's own data fitting and cord							

Model # 39952	site-wired power	<table border="1" style="border-collapse: collapse;"> <tr> <td style="padding: 2px;">1P-SW</td> <td style="padding: 2px;">1P-SW</td> <td style="padding: 2px;">O</td> <td style="padding: 2px;">O</td> <td style="padding: 2px;">O</td> <td style="padding: 2px;">O</td> </tr> </table>	1P-SW	1P-SW	O	O	O	O	\$500
1P-SW	1P-SW	O	O	O	O				
		2 x site-wired power with 6ft metallic shielded cable 4 x open port/data adapter to fit in client's own data fitting and cord							

Model # 39953	pre-wired power	<table border="1" style="border-collapse: collapse;"> <tr> <td style="padding: 2px;">1P</td> <td style="padding: 2px;">1P</td> <td style="padding: 2px;">1P</td> <td style="padding: 2px;">O</td> <td style="padding: 2px;">O</td> <td style="padding: 2px;">O</td> </tr> </table>	1P	1P	1P	O	O	O	\$490
1P	1P	1P	O	O	O				
		3 x pre-wired power with 10ft cord 3 x open port/data adapter to fit in client's own data fitting and cord							

Model # 39954	site-wired power	<table border="1" style="border-collapse: collapse;"> <tr> <td style="padding: 2px;">1P-SW</td> <td style="padding: 2px;">1P-SW</td> <td style="padding: 2px;">1P-SW</td> <td style="padding: 2px;">O</td> <td style="padding: 2px;">O</td> <td style="padding: 2px;">O</td> </tr> </table>	1P-SW	1P-SW	1P-SW	O	O	O	\$525
1P-SW	1P-SW	1P-SW	O	O	O				
		3 x site-wired power with 6ft metallic shielded cable 3 x open port/data adapter to fit in client's own data fitting and cord							

• Simple Forum is available in black or white finish.

ELETRICS, POWER OPTIONS

Each open port selected will be supplied with one set of data adapter kit contains 2 "AA", 2 "BB", 2 "CC", 2 "DD", 2 "EE", 2 "FF", 1 "GG" and 1 "HH". adapter. The data adapter can accommodate the following data fitting from manufacturer:

Adapter "AA"

Systemax/CommScope
Uniprise/CommScope

Adapter "BB"

L-Com Keystone Modular
Tyco SL/110 Connect Series Modular
Jacks
Siemon Keystone Style
Allen Tel Versa Tap Series
Leviton Quick Port® Series
Nordx Keystone Style
Tyco SL Conpler Series

Adapter "CC"

Krone 6000 Series/ADC
Hubbell Xcelerator™ Keystone
Series

Adapter "DD"

blank

Adapter "EE"

Ortronics TracJack Series

Adapter "FF"

Panduit Mini-Com Series

Adapter "GG"

microphone jack / 3pin XLR, solder type
only

Adapter "HH"

Adapter "HH" - video monitor jack / DB-15,
panel mount solder type.

- Snap in fitting adapters are also provide for 3-pin XLR microphone jack (solder type only) and DB-15 video monitor jack (panel mount solder style only)

TROUGH COMPONENT OPTIONS

List Price

Base Model For Simple Pop Up Forum





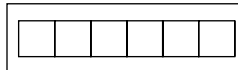





(6 Ports)

Model #: CX6P - _ _ _ _ _



\$280

Select the elements as per below:

	1P - 1 power receptacle with 10' white cord	\$105
	1P-SW - 1 power receptacle hard wired with a 6' whip	\$125
	A0- AMP CAT5E data fitting with 9' connector cable	\$120
	A5 - SIEMON CAT 6 data fitting with 10' connector cable	\$140
	C - Audio- 3.5mm Mini stereo Jack with 10' cord	\$65
	H - USB port 3.0 with 10ft cord	\$95
	2U - Stacked USB charger	\$130
	G - DB15HD, VGA connector, 10' cord	\$155
	HD - HDMI Coupler with 18" cord	\$155
	B - Blank plate	\$40
	O - Open port, for client's own data fitting. Each port selected will be supplied with one set of data adapter kit (see page 43)	\$40
	L - Belay 1" dia. hole opening rubber strain relief pass through cords	\$40

GROMMETS & CABLE CONDUITS

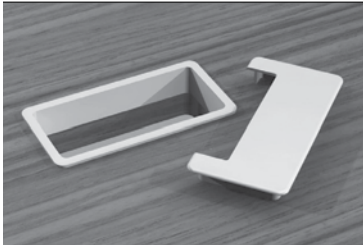
	Model Number	List Price	Product Description
	70286 (black)	\$55	<p>This large rectangular plastic grommet has capacity for the most demanding wire management needs. When not in use the hinged cover swings up to close the grommet. Overall dimension is 4" L x 2" W (interior clearance - 3⁵/₈" L x 1⁵/₈" W).</p> <p>Available in three colours to coordinate with a variety of top finishes.</p>
	70287 (cool grey)	\$55	
	70288 (warm grey)	\$55	

VOX® ALUMINUM GROMMET

Grommet for Power Cable

23416

\$260

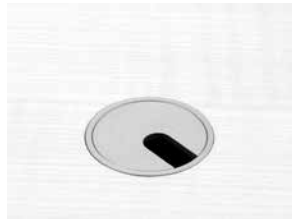

- Flush aluminum grommet accommodates two 16 gauge power cables and plugs, or 6 data/voice cables and plugs.
- Finished outside diameter 1⁵/₈", inside diameter is 1¹/₄".
- Available in five anodized aluminum colours: silver, champagne, light bronze, bronze and black.

Grommet for Large Power Cable

23418

\$350



- Flush aluminum grommet accommodates three 16 gauge power cables and plugs, or 10 data/voice cables and plugs.
- Finished outside diameter 2¹/₈", inside diameter is 2¹/₄".
- Suitable for international power plugs.
- Available in five anodized aluminum colours: silver, champagne, light bronze, bronze and black.

GROMMETS & CABLE CONDUITS

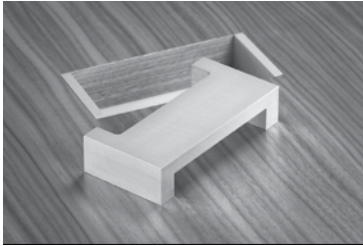
	Model Number	List Price	Product Description
	70277	\$280	<ul style="list-style-type: none"> • A high quality grommet option that offers a nice contrast to any top surface and are built to withstand many years of use. Made of a heavy gauge aluminum extrusion with a large access hole. • Covers will not pull out during use. Overall dimension is 5^{1/4}" L x 2^{1/4}" W (interior clearance – 4^{3/4}" L X 2^{1/4}" W). • Available in five anodized aluminum colours: silver, champagne, light bronze, bronze and black.

VOX® CABLE CONDUIT

Vox® Expandable Cable Conduit



55024-B black	\$940
55024-S silver	\$940
55024-C clear	\$940

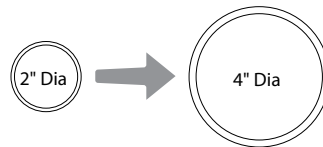

The Vox® Expandable Cable Conduit is made of woven, flexible plastic wire. Its unique properties allow it to expand and contract to allow for different cable capacities.

A "U" bracket at the top attaches to the support rail. An 8" diameter counter weight is incorporated at the base which can be positioned to accommodate core drills or receptacle positions. Inside hole diameter is 3.5".

Cable capacity range is from two inches to four inches.

Shipped with extra length, the Vox expandable cable conduit can easily be shortened on site if required.

Vox® Linked Cable Conduit



55025-B black	\$1,020
55025-S silver	\$1,020
55025-C clear	\$1,020

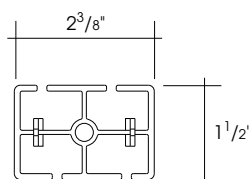

The Vox® Linked Cable Conduit is comprised of a series of plastic elements that are divided into 4 cavities.

As an assembly it bends in a single direction but may also be rotated about its top mount.

A "U" bracket at the top attaches to the support rail.

An 8" diameter counter weight is incorporated at the base which can be positioned to accommodate core drills or receptacle positions. Inside hole diameter is 3.5".

- 2" long segments can be removed to desired length.
- Wire capacity: eighteen 16 gauge cables.

CONNECTIVITY DEVICE TO FLOOR WIRE ROUTING DETAILS

Metronome™ Tables offer a variety of wire routing options that carry cables from the connectivity device to the floor monument.

Tables with surface-mounted connectivity

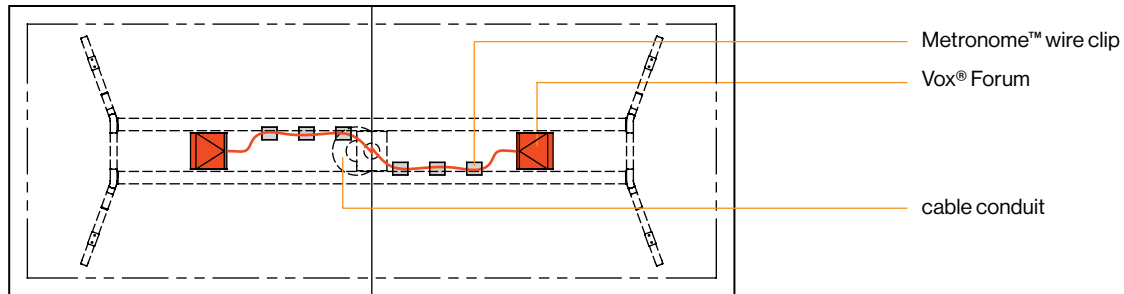

Tables with single wire trough

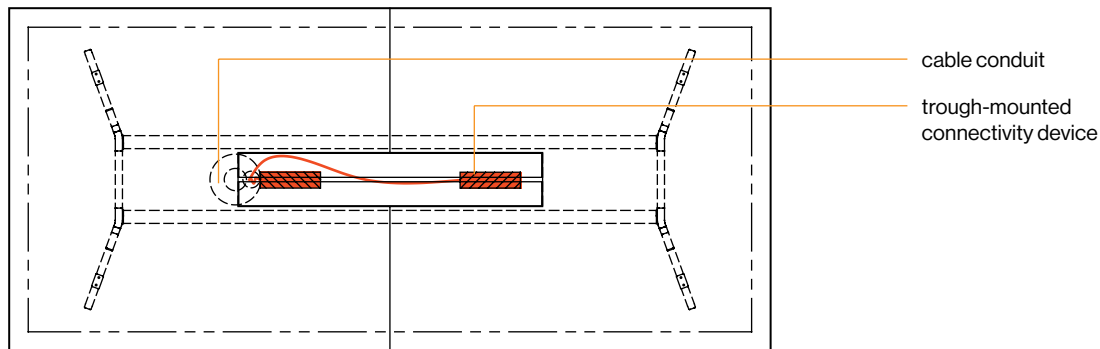

Tables with dual wire troughs – standard wiring requirements

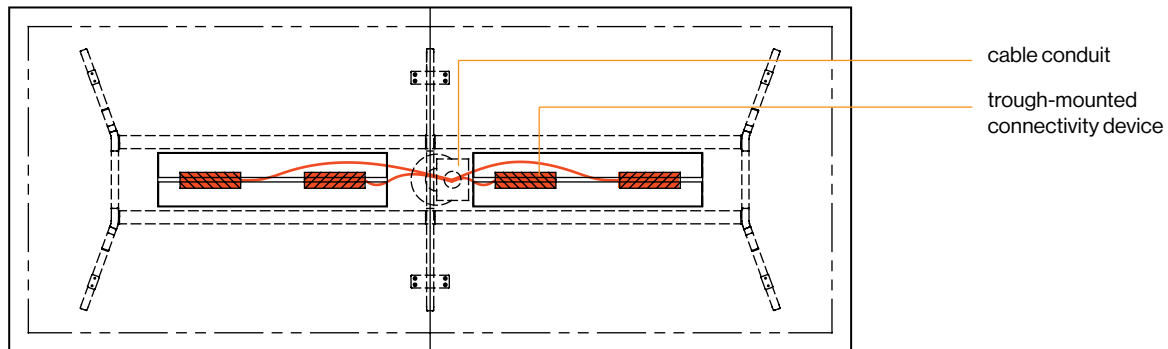

Tables with dual wire troughs – high capacity wiring requirements

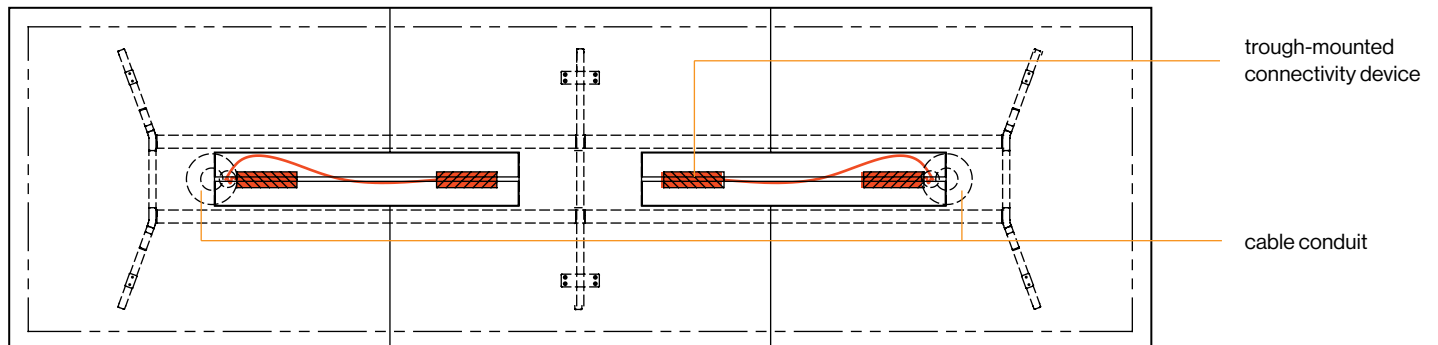

ROOM LAYOUT

Room 1

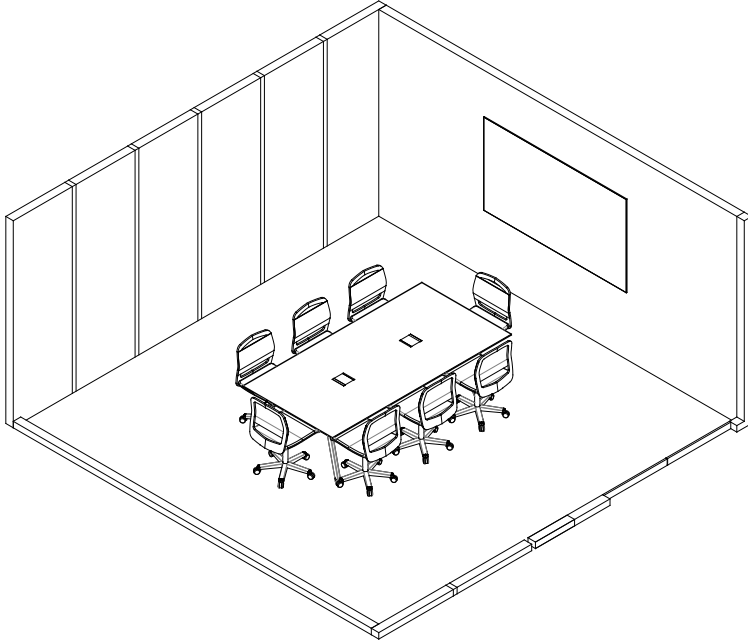

Product Name	Model Number	List Price
Metronome™ 96" x 48"	39406/5	4,765
M-Forums (2 qty)	M-1P-0F-1P	3,590
Glass Wall Board	52022	3,615
Nabu™ Chair (8 qty)	10604	7,390

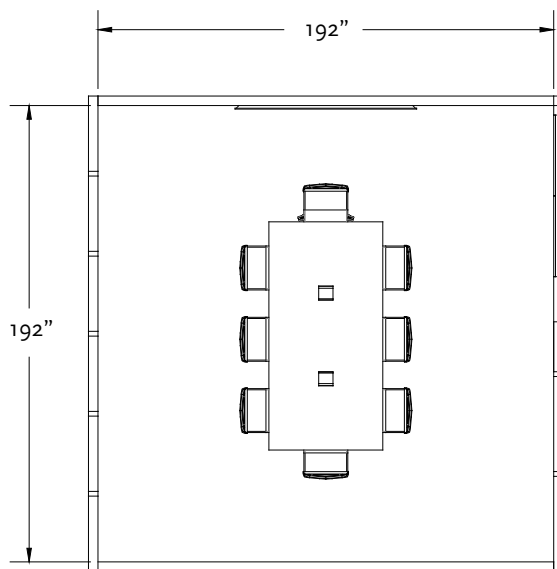

ROOM LAYOUT

Room 2

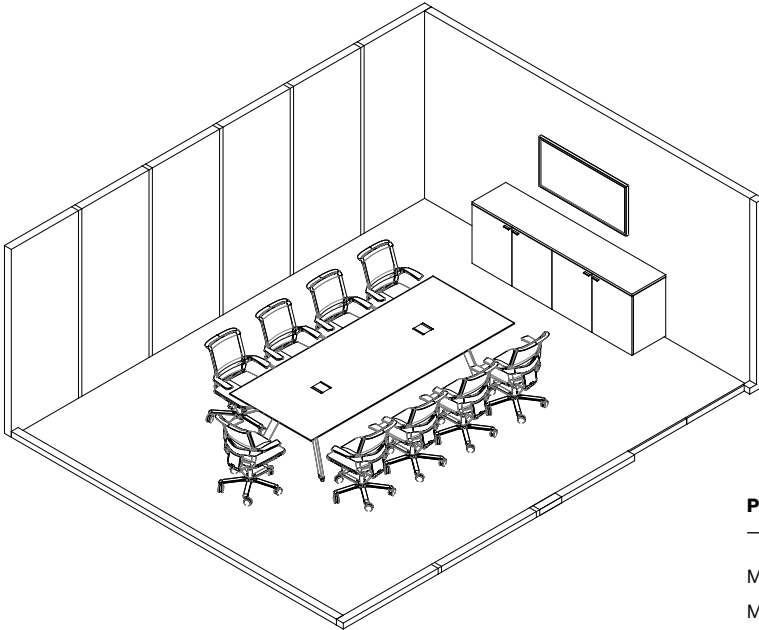

Product Name	Model Number	List Price
Metronome™ 120" x 48"	39410/5	5,170
M-Forums (2 qty)	M-1P-0F-1P	3,590
SIMPLE Credenza 94 ¹ / ₂ " x 20" x 34 ¹ / ₄ "	36104/5	5,345
Glass Wall Board	52022	3,615
Omada™ Chair (9 qty)	10926	8,310

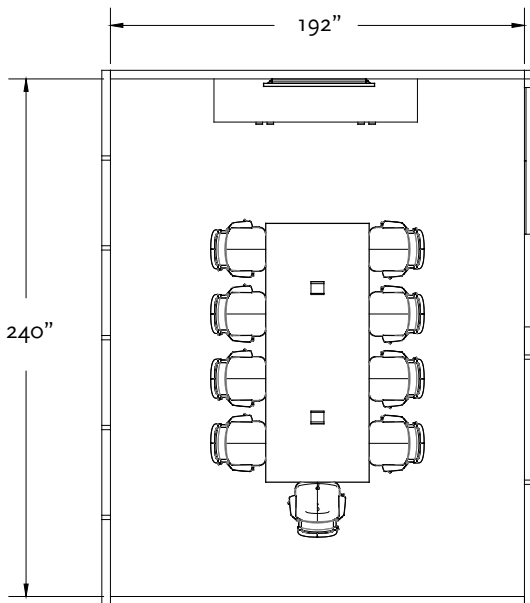

ROOM LAYOUT

Room 3

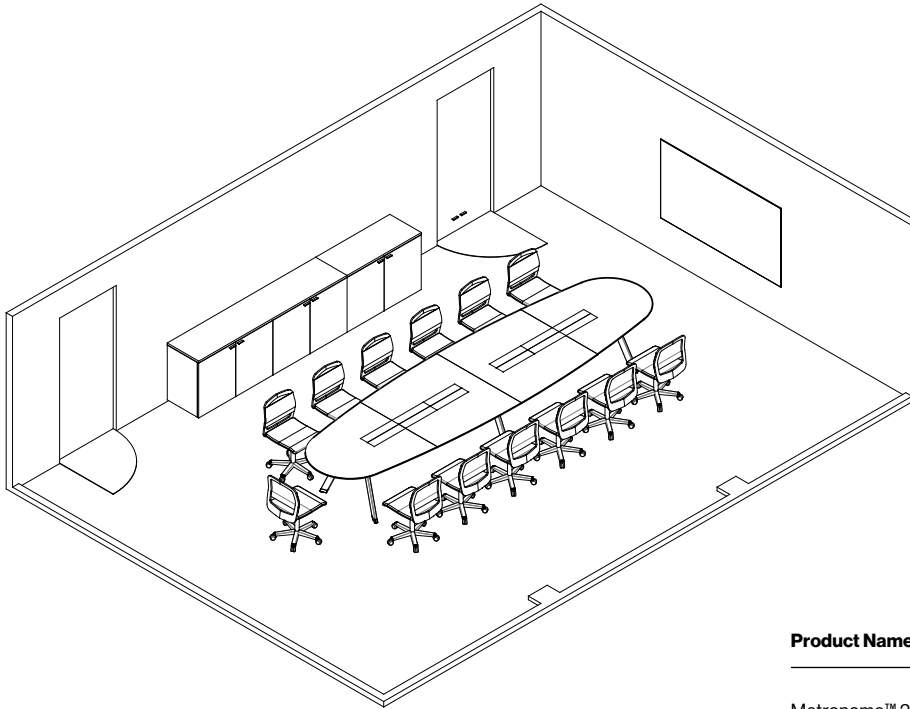

Product Name	Model Number	List Price
Metronome™ 204" x 54"	39847/2	15,880
Simple Forum (4 qty)	39947/5	2,615
Glass Wall Board	52023	4,615
Nabu™ Chair (13 qty)	10604	12,000

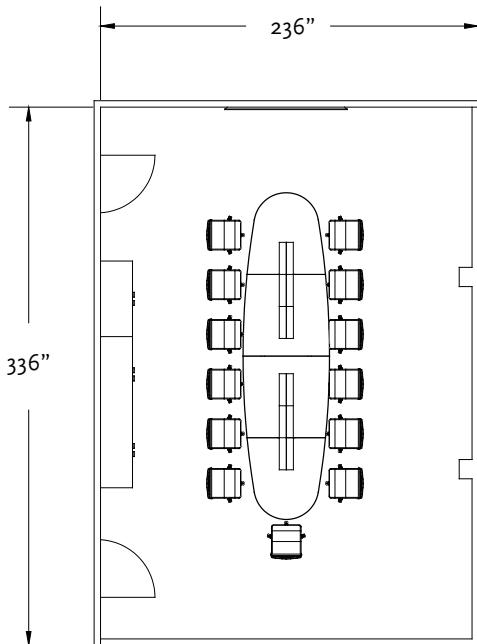

ROOM LAYOUT

Room 4

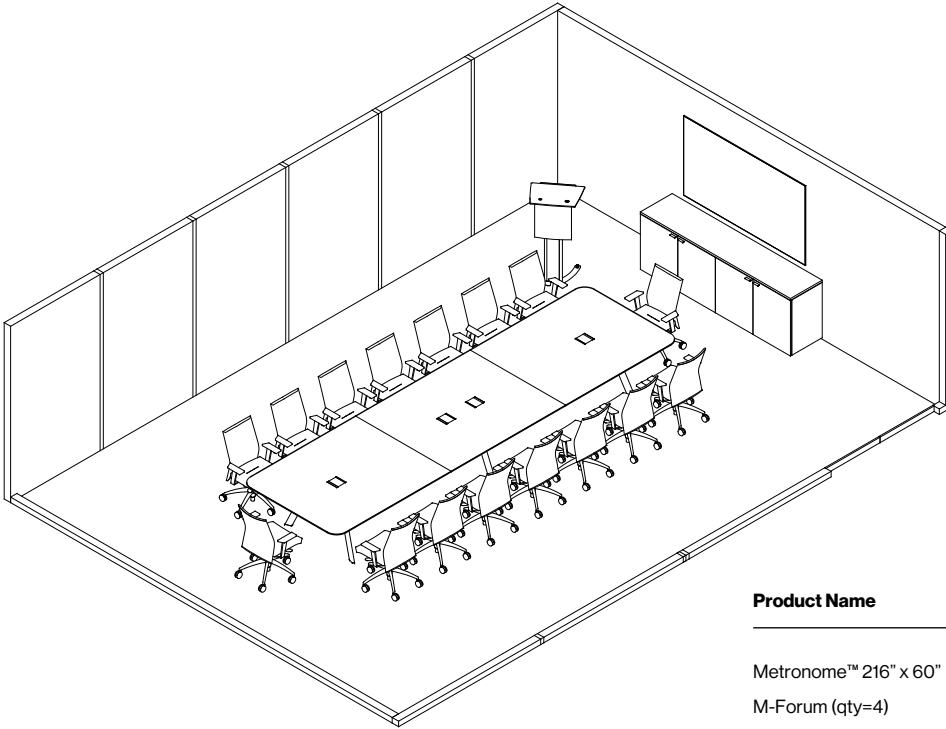

Product Name	Model Number	List Price
Metronome™ 216" x 60"	39550/2	13,190
M-Forum (qty=4)	M-1P-0F-1P	7,175
SIMPLE Credenza 4 door	36104/2	5,625
Vox® Keynote Lectern™	23469/2	3,865
Glass Wall Board	52023	4,615
Nienkamper NOW® Chair (qty=16)	13080	22,410

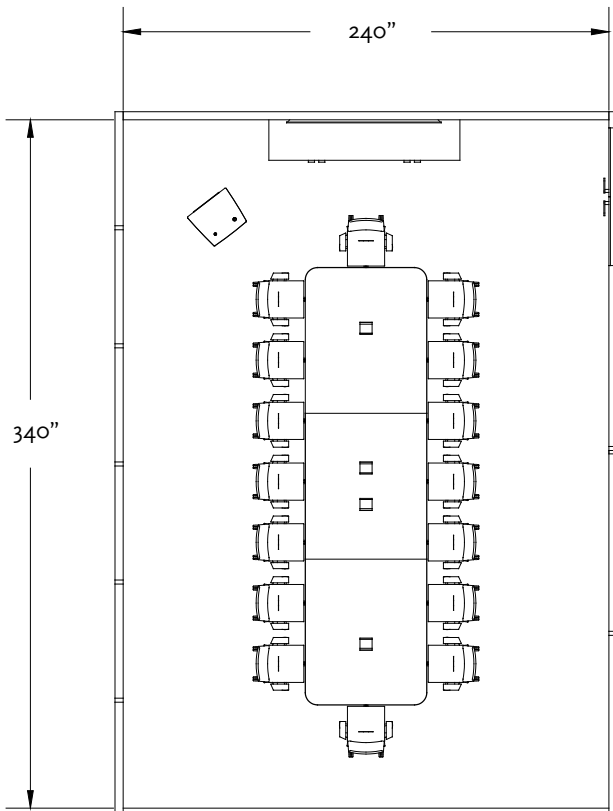

METRONOME™ TABLES



Table Top



Rectangle

No Power Trough

Table height = 29"

2 Supports

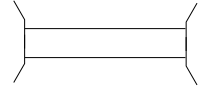

Specify edge type: add the two letter code after the model number



Taper Edge (TE)



Self Edge (SE)



Facet Edge (FE)

Note: For powder coat bases, please use model # of anodized bases and add "PC" at the end, e.g. 39403PC/2.

Anodized Bases

L"	x	D"	Sugg Seat Capacity *	Top Finish	Top Sections	Model Number	List Price
84		42	6-8	Veneer	1	39403/2	5,110
84		42	6-8	Laminate	1	39403/5	4,360
96		42	6-8	Veneer	1	39405/2	5,410
96		42	6-8	Laminate	1	39405/5	4,555
96		48	6-8	Veneer	1	39406/2	5,750
96		48	6-8	Laminate	1	39406/5	4,765
108		42	8-10	Veneer	1	39407/2	5,735
108		42	8-10	Laminate	1	39407/5	4,755
108		48	8-10	Veneer	1	39408/2	6,050
108		48	8-10	Laminate	1	39408/5	4,965
120		42	8-10	Veneer	2	39409/2	6,035
120		42	8-10	Laminate	2	39409/5	4,975
120		48	8-10	Veneer	2	39410/2	6,425
120		48	8-10	Laminate	2	39410/5	5,170
120		54	8-10	Veneer	2	39411/2	6,815
120		54	8-10	Laminate	2	39411/5	5,405

Polished Bases

L"	x	D"	Sugg Seat Capacity *	Top Finish	Top Sections	Model Number	List Price
84		42	6-8	Veneer	1	39433/2	5,430
84		42	6-8	Laminate	1	39433/5	4,685
96		42	6-8	Veneer	1	39435/2	5,735
96		42	6-8	Laminate	1	39435/5	4,880
96		48	6-8	Veneer	1	39436/2	6,080
96		48	6-8	Laminate	1	39436/5	5,070
108		42	8-10	Veneer	1	39437/2	6,065
108		42	8-10	Laminate	1	39437/5	5,080
108		48	8-10	Veneer	1	39438/2	6,350
108		48	8-10	Laminate	1	39438/5	5,280
120		42	8-10	Veneer	2	39439/2	6,330
120		42	8-10	Laminate	2	39439/5	5,300
120		48	8-10	Veneer	2	39440/2	6,730
120		48	8-10	Laminate	2	39440/5	5,505
120		54	8-10	Veneer	2	39441/2	7,135
120		54	8-10	Laminate	2	39441/5	5,730

* Based on a chair width of 25"

METRONOME™ TABLES



Table Top



Rectangle

No Power Trough

Table height = 29"

3 Supports



Specify edge type: add the two letter code after the model number



Taper Edge (TE)



Self Edge (SE)



Facet Edge (FE)

Note: For powder coat bases, please use model # of anodized bases and add "PC" at the end, e.g. 39403PC/2.

Anodized Bases

L" x D"	Sugg Seat Capacity *	Top Finish	Top Sections	Model Number	List Price
132 x 48	10-12	Veneer	2	39412/2	8,910
132 x 48	10-12	Laminate	2	39412/5	7,540
132 x 54	10-12	Veneer	2	39413/2	9,345
132 x 54	10-12	Laminate	2	39413/5	7,850
144 x 48	10-12	Veneer	2	39414/2	9,340
144 x 48	10-12	Laminate	2	39414/5	7,845
144 x 54	10-12	Veneer	2	39415/2	9,815
144 x 54	10-12	Laminate	2	39415/5	8,105
144 x 60	10-12	Veneer	2	39416/2	10,280
144 x 60	10-12	Laminate	2	39416/5	8,390
156 x 48	12-14	Veneer	2	39417/2	9,690
156 x 48	12-14	Laminate	2	39417/5	8,060
156 x 54	12-14	Veneer	2	39418/2	10,215
156 x 54	12-14	Laminate	2	39418/5	8,370
156 x 60	12-14	Veneer	2	39419/2	10,695
156 x 60	12-14	Laminate	2	39419/5	8,655
168 x 48	12-14	Veneer	2	39420/2	10,035
168 x 48	12-14	Laminate	2	39420/5	8,280
168 x 54	12-14	Veneer	2	39421/2	10,595
168 x 54	12-14	Laminate	2	39421/5	8,620
168 x 60	12-14	Veneer	2	39422/2	11,120
168 x 60	12-14	Laminate	2	39422/5	8,910
180 x 54	14-16	Veneer	3	39423/2	10,970
180 x 54	14-16	Laminate	3	39423/5	8,850
180 x 60	14-16	Veneer	3	39424/2	11,545
180 x 60	14-16	Laminate	3	39424/5	9,175
192 x 54	14-16	Veneer	3	39425/2	11,355
192 x 54	14-16	Laminate	3	39425/5	9,085
192 x 60	14-16	Veneer	3	39426/2	11,965
192 x 60	14-16	Laminate	3	39426/5	9,435
204 x 54	16-18	Veneer	3	39427/2	11,740
204 x 54	16-18	Laminate	3	39427/5	9,330
204 x 60	16-18	Veneer	3	39428/2	12,390
204 x 60	16-18	Laminate	3	39428/5	9,700
216 x 54	16-18	Veneer	3	39429/2	12,120
216 x 54	16-18	Laminate	3	39429/5	9,560
216 x 60	16-18	Veneer	3	39430/2	12,820
216 x 60	16-18	Laminate	3	39430/5	9,955

Polished Bases

L" x D"	Sugg Seat Capacity *	Top Finish	Top Sections	Model Number	List Price
132 x 48	10-12	Veneer	2	39442/2	9,550
132 x 48	10-12	Laminate	2	39442/5	8,190
132 x 54	10-12	Veneer	2	39443/2	10,000
132 x 54	10-12	Laminate	2	39443/5	8,500
144 x 48	10-12	Veneer	2	39444/2	9,990
144 x 48	10-12	Laminate	2	39444/5	8,485
144 x 54	10-12	Veneer	2	39445/2	10,460
144 x 54	10-12	Laminate	2	39445/5	8,745
144 x 60	10-12	Veneer	2	39446/2	10,920
144 x 60	10-12	Laminate	2	39446/5	9,035
156 x 48	12-14	Veneer	2	39447/2	10,335
156 x 48	12-14	Laminate	2	39447/5	8,705
156 x 54	12-14	Veneer	2	39448/2	10,860
156 x 54	12-14	Laminate	2	39448/5	9,030
156 x 60	12-14	Veneer	2	39449/2	11,350
156 x 60	12-14	Laminate	2	39449/5	9,305
168 x 48	12-14	Veneer	2	39450/2	10,685
168 x 48	12-14	Laminate	2	39450/5	8,920
168 x 54	12-14	Veneer	2	39451/2	11,240
168 x 54	12-14	Laminate	2	39451/5	9,265
168 x 60	12-14	Veneer	2	39452/2	11,765
168 x 60	12-14	Laminate	2	39452/5	9,560
180 x 54	14-16	Veneer	3	39453/2	11,615
180 x 54	14-16	Laminate	3	39453/5	9,500
180 x 60	14-16	Veneer	3	39454/2	12,195
180 x 60	14-16	Laminate	3	39454/5	9,820
192 x 54	14-16	Veneer	3	39455/2	11,995
192 x 54	14-16	Laminate	3	39455/5	9,735
192 x 60	14-16	Veneer	3	39456/2	12,620
192 x 60	14-16	Laminate	3	39456/5	10,090
204 x 54	16-18	Veneer	3	39457/2	12,390
204 x 54	16-18	Laminate	3	39457/5	9,980
204 x 60	16-18	Veneer	3	39458/2	13,035
204 x 60	16-18	Laminate	3	39458/5	10,345
216 x 54	16-18	Veneer	3	39459/2	12,785
216 x 54	16-18	Laminate	3	39459/5	10,215
216 x 60	16-18	Veneer	3	39460/2	13,460
216 x 60	16-18	Laminate	3	39460/5	10,605

* Based on a chair width of 25"

METRONOME™ TABLES



Table Top  **With Power Trough** Table height = 29"
 Rectangle

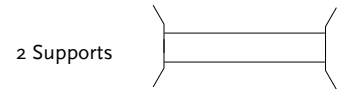

Specify edge type: add the two letter code after the model number



Note: For powder coat bases, please use model # of anodized bases and add "PC" at the end, e.g. 39403PC/2.

Anodized Bases

L" x D"	Sugg Seat Capacity *	Top Finish	Top Sections	Model Number	List Price
84 x 42	6-8	Veneer	1	39463/2	6,325
84 x 42	6-8	Laminate	1	39463/5	5,590
96 x 42	6-8	Veneer	1	39465/2	6,645
96 x 42	6-8	Laminate	1	39465/5	5,775
96 x 48	6-8	Veneer	1	39466/2	6,980
96 x 48	6-8	Laminate	1	39466/5	5,965
108 x 42	8-10	Veneer	1	39467/2	6,960
108 x 42	8-10	Laminate	1	39467/5	5,975
108 x 48	8-10	Veneer	1	39468/2	7,270
108 x 48	8-10	Laminate	1	39468/5	6,180
120 x 42	8-10	Veneer	2	39469/2	7,375
120 x 42	8-10	Laminate	2	39469/5	6,325
120 x 48	8-10	Veneer	2	39470/2	7,765
120 x 48	8-10	Laminate	2	39470/5	6,520
120 x 54	8-10	Veneer	2	39471/2	8,165
120 x 54	8-10	Laminate	2	39471/5	6,760

Polished Bases

L" x D"	Sugg Seat Capacity *	Top Finish	Top Sections	Model Number	List Price
84 x 42	6-8	Veneer	1	39493/2	6,660
84 x 42	6-8	Laminate	1	39493/5	5,910
96 x 42	6-8	Veneer	1	39495/2	6,960
96 x 42	6-8	Laminate	1	39495/5	6,110
96 x 48	6-8	Veneer	1	39496/2	7,305
96 x 48	6-8	Laminate	1	39496/5	6,295
108 x 42	8-10	Veneer	1	39497/2	7,285
108 x 42	8-10	Laminate	1	39497/5	6,300
108 x 48	8-10	Veneer	1	39498/2	7,590
108 x 48	8-10	Laminate	1	39498/5	6,505
120 x 42	8-10	Veneer	2	39499/2	7,705
120 x 42	8-10	Laminate	2	39499/5	6,660
120 x 48	8-10	Veneer	2	39500/2	8,095
120 x 48	8-10	Laminate	2	39500/5	6,850
120 x 54	8-10	Veneer	2	39501/2	8,490
120 x 54	8-10	Laminate	2	39501/5	7,085

* Based on a chair width of 25"

METRONOME™ TABLES

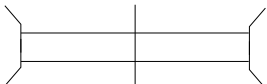

Table Top  **With Power Trough** Table height = 29"
 Rectangle

3 Supports 

Specify edge type: add the two letter code after the model number



Note: For powder coat bases, please use model # of anodized bases and add "PC" at the end, e.g. 39403PC/2.

Anodized Bases

L" x D"	Sugg Seat Capacity *	Top Finish	Top Sections	Model Number	List Price
132 48 10-12	Veneer	2	39472/2	10,275	
132 48 10-12	Laminate	2	39472/5	8,895	
132 54 10-12	Veneer	2	39473/2	10,710	
132 54 10-12	Laminate	2	39473/5	9,210	
144 48 10-12	Veneer	2	39474/2	10,695	
144 48 10-12	Laminate	2	39474/5	9,195	
144 54 10-12	Veneer	2	39475/2	11,180	
144 54 10-12	Laminate	2	39475/5	9,465	
144 60 10-12	Veneer	2	39476/2	11,625	
144 60 10-12	Laminate	2	39476/5	9,745	
156 48 12-14	Veneer	2	39477/2	12,135	
156 48 12-14	Laminate	2	39477/5	10,520	
156 54 12-14	Veneer	2	39478/2	12,665	
156 54 12-14	Laminate	2	39478/5	10,840	
156 60 12-14	Veneer	2	39479/2	13,150	
156 60 12-14	Laminate	2	39479/5	11,105	
168 48 12-14	Veneer	2	39480/2	12,485	
168 48 12-14	Laminate	2	39480/5	10,730	
168 54 12-14	Veneer	2	39481/2	13,045	
168 54 12-14	Laminate	2	39481/5	11,070	
168 60 12-14	Veneer	2	39482/2	13,580	
168 60 12-14	Laminate	2	39482/5	11,370	
180 54 14-16	Veneer	3	39483/2	13,545	
180 54 14-16	Laminate	3	39483/5	11,425	
180 60 14-16	Veneer	3	39484/2	14,125	
180 60 14-16	Laminate	3	39484/5	11,760	
192 54 14-16	Veneer	3	39485/2	13,935	
192 54 14-16	Laminate	3	39485/5	11,670	
192 60 14-16	Veneer	3	39486/2	14,550	
192 60 14-16	Laminate	3	39486/5	12,025	
204 54 16-18	Veneer	3	39487/2	14,320	
204 54 16-18	Laminate	3	39487/5	11,915	
204 60 16-18	Veneer	3	39488/2	14,970	
204 60 16-18	Laminate	3	39488/5	12,285	
216 54 16-18	Veneer	3	39489/2	14,710	
216 54 16-18	Laminate	3	39489/5	12,140	
216 60 16-18	Veneer	3	39490/2	15,380	
216 60 16-18	Laminate	3	39490/5	12,540	

Polished Bases

L" x D"	Sugg Seat Capacity *	Top Finish	Top Sections	Model Number	List Price
132 48 10-12	Veneer	2	39502/2	10,915	
132 48 10-12	Laminate	2	39502/5	9,540	
132 54 10-12	Veneer	2	39503/2	11,355	
132 54 10-12	Laminate	2	39503/5	9,855	
144 48 10-12	Veneer	2	39504/2	11,345	
144 48 10-12	Laminate	2	39504/5	9,840	
144 54 10-12	Veneer	2	39505/2	11,815	
144 54 10-12	Laminate	2	39505/5	10,115	
144 60 10-12	Veneer	2	39506/2	12,275	
144 60 10-12	Laminate	2	39506/5	10,395	
156 48 12-14	Veneer	2	39507/2	12,795	
156 48 12-14	Laminate	2	39507/5	11,170	
156 54 12-14	Veneer	2	39508/2	13,310	
156 54 12-14	Laminate	2	39508/5	11,475	
156 60 12-14	Veneer	2	39509/2	13,805	
156 60 12-14	Laminate	2	39509/5	11,750	
168 48 12-14	Veneer	2	39510/2	13,130	
168 48 12-14	Laminate	2	39510/5	11,385	
168 54 12-14	Veneer	2	39511/2	13,695	
168 54 12-14	Laminate	2	39511/5	11,725	
168 60 12-14	Veneer	2	39512/2	14,220	
168 60 12-14	Laminate	2	39512/5	12,015	
180 54 14-16	Veneer	3	39513/2	14,200	
180 54 14-16	Laminate	3	39513/5	12,080	
180 60 14-16	Veneer	3	39514/2	14,780	
180 60 14-16	Laminate	3	39514/5	12,415	
192 54 14-16	Veneer	3	39515/2	14,585	
192 54 14-16	Laminate	3	39515/5	12,310	
192 60 14-16	Veneer	3	39516/2	15,195	
192 60 14-16	Laminate	3	39516/5	12,665	
204 54 16-18	Veneer	3	39517/2	14,970	
204 54 16-18	Laminate	3	39517/5	12,555	
204 60 16-18	Veneer	3	39518/2	15,620	
204 60 16-18	Laminate	3	39518/5	12,925	
216 54 16-18	Veneer	3	39519/2	15,355	
216 54 16-18	Laminate	3	39519/5	12,805	
216 60 16-18	Veneer	3	39520/2	16,045	
216 60 16-18	Laminate	3	39520/5	13,195	

* Based on a chair width of 25"

METRONOME™ TABLES



Table Top



No Power Trough

Table height = 29"

Rectangle with soft corners

2 Supports



Specify edge type: add the two letter code after the model number



Taper Edge (TE)

Self Edge (SE)

Facet Edge (FE)

Note: For powder coat bases, please use model # of anodized bases and add "PC" at the end, e.g. 39403PC/2.

Anodized Bases

Polished Bases

L" x D"	Sugg Seat Capacity *	Top Finish	Top Sections	Model Number	List Price	L" x D"	Sugg Seat Capacity *	Top Finish	Top Sections	Model Number	List Price
84 x 42	6-8	Veneer	1	39523/2	5,265	84 x 42	6-8	Veneer	1	39553/2	5,595
84 x 42	6-8	Laminate	1	39523/5	4,490	84 x 42	6-8	Laminate	1	39553/5	4,830
96 x 42	6-8	Veneer	1	39525/2	5,570	96 x 42	6-8	Veneer	1	39555/2	5,910
96 x 42	6-8	Laminate	1	39525/5	4,690	96 x 42	6-8	Laminate	1	39555/5	5,030
96 x 48	6-8	Veneer	1	39526/2	5,925	96 x 48	6-8	Veneer	1	39556/2	6,265
96 x 48	6-8	Laminate	1	39526/5	4,880	96 x 48	6-8	Laminate	1	39556/5	5,220
108 x 42	8-10	Veneer	1	39527/2	5,910	108 x 42	8-10	Veneer	1	39557/2	6,250
108 x 42	8-10	Laminate	1	39527/5	4,895	108 x 42	8-10	Laminate	1	39557/5	5,225
108 x 48	8-10	Veneer	1	39528/2	6,230	108 x 48	8-10	Veneer	1	39558/2	6,540
108 x 48	8-10	Laminate	1	39528/5	5,110	108 x 48	8-10	Laminate	1	39558/5	5,435
120 x 42	8-10	Veneer	2	39529/2	6,220	120 x 42	8-10	Veneer	2	39559/2	6,530
120 x 42	8-10	Laminate	2	39529/5	5,125	120 x 42	8-10	Laminate	2	39559/5	5,465
120 x 48	8-10	Veneer	2	39530/2	6,615	120 x 48	8-10	Veneer	2	39560/2	6,935
120 x 48	8-10	Laminate	2	39530/5	5,335	120 x 48	8-10	Laminate	2	39560/5	5,665
120 x 54	8-10	Veneer	2	39531/2	7,020	120 x 54	8-10	Veneer	2	39561/2	7,345
120 x 54	8-10	Laminate	2	39531/5	5,565	120 x 54	8-10	Laminate	2	39561/5	5,905

* Based on a chair width of 25"

METRONOME™ TABLES

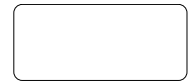

Table Top



No Power Trough

Table height = 29"

Rectangle with soft corners

3 Supports



Specify edge type: add the two letter code after the model number



Taper Edge (TE)



Self Edge (SE)



Facet Edge (FE)

Note: For powder coat bases, please use model # of anodized bases and add "PC" at the end, e.g. 39403PC/2.

Anodized Bases

L" x D"	Sugg Seat Capacity *	Top Finish	Top Sections	Model Number	List Price
132 48 10-12	Veneer	2	39532/2	9,175	
132 48 10-12	Laminate	2	39532/5	7,765	
132 54 10-12	Veneer	2	39533/2	9,630	
132 54 10-12	Laminate	2	39533/5	8,085	
144 48 10-12	Veneer	2	39534/2	9,620	
144 48 10-12	Laminate	2	39534/5	8,075	
144 54 10-12	Veneer	2	39535/2	10,115	
144 54 10-12	Laminate	2	39535/5	8,350	
144 60 10-12	Veneer	2	39536/2	10,585	
144 60 10-12	Laminate	2	39536/5	8,645	
156 48 12-14	Veneer	2	39537/2	9,985	
156 48 12-14	Laminate	2	39537/5	8,300	
156 54 12-14	Veneer	2	39538/2	10,525	
156 54 12-14	Laminate	2	39538/5	8,635	
156 60 12-14	Veneer	2	39539/2	11,020	
156 60 12-14	Laminate	2	39539/5	8,910	
168 48 12-14	Veneer	2	39540/2	10,340	
168 48 12-14	Laminate	2	39540/5	8,525	
168 54 12-14	Veneer	2	39541/2	10,915	
168 54 12-14	Laminate	2	39541/5	8,880	
168 60 12-14	Veneer	2	39542/2	11,455	
168 60 12-14	Laminate	2	39542/5	9,175	
180 54 14-16	Veneer	3	39543/2	11,300	
180 54 14-16	Laminate	3	39543/5	9,110	
180 60 14-16	Veneer	3	39544/2	11,890	
180 60 14-16	Laminate	3	39544/5	9,460	
192 54 14-16	Veneer	3	39545/2	11,700	
192 54 14-16	Laminate	3	39545/5	9,355	
192 60 14-16	Veneer	3	39546/2	12,325	
192 60 14-16	Laminate	3	39546/5	9,720	
204 54 16-18	Veneer	3	39547/2	12,090	
204 54 16-18	Laminate	3	39547/5	9,605	
204 60 16-18	Veneer	3	39548/2	12,755	
204 60 16-18	Laminate	3	39548/5	10,000	
216 54 16-18	Veneer	3	39549/2	12,485	
216 54 16-18	Laminate	3	39549/5	9,850	
216 60 16-18	Veneer	3	39550/2	13,190	
216 60 16-18	Laminate	3	39550/5	10,265	

Polished Bases

L" x D"	Sugg Seat Capacity *	Top Finish	Top Sections	Model Number	List Price
132 48 10-12	Veneer	2	39562/2	9,840	
132 48 10-12	Laminate	2	39562/5	8,440	
132 54 10-12	Veneer	2	39563/2	10,295	
132 54 10-12	Laminate	2	39563/5	8,745	
144 48 10-12	Veneer	2	39564/2	10,285	
144 48 10-12	Laminate	2	39564/5	8,735	
144 54 10-12	Veneer	2	39565/2	10,780	
144 54 10-12	Laminate	2	39565/5	9,020	
144 60 10-12	Veneer	2	39566/2	11,245	
144 60 10-12	Laminate	2	39566/5	9,310	
156 48 12-14	Veneer	2	39567/2	10,650	
156 48 12-14	Laminate	2	39567/5	8,965	
156 54 12-14	Veneer	2	39568/2	11,190	
156 54 12-14	Laminate	2	39568/5	9,305	
156 60 12-14	Veneer	2	39569/2	11,695	
156 60 12-14	Laminate	2	39569/5	9,575	
168 48 12-14	Veneer	2	39570/2	11,010	
168 48 12-14	Laminate	2	39570/5	9,195	
168 54 12-14	Veneer	2	39571/2	11,585	
168 54 12-14	Laminate	2	39571/5	9,540	
168 60 12-14	Veneer	2	39572/2	12,120	
168 60 12-14	Laminate	2	39572/5	9,850	
180 54 14-16	Veneer	3	39573/2	11,965	
180 54 14-16	Laminate	3	39573/5	9,780	
180 60 14-16	Veneer	3	39574/2	12,565	
180 60 14-16	Laminate	3	39574/5	10,120	
192 54 14-16	Veneer	3	39575/2	12,355	
192 54 14-16	Laminate	3	39575/5	10,020	
192 60 14-16	Veneer	3	39576/2	13,000	
192 60 14-16	Laminate	3	39576/5	10,395	
204 54 16-18	Veneer	3	39577/2	12,755	
204 54 16-18	Laminate	3	39577/5	10,275	
204 60 16-18	Veneer	3	39578/2	13,425	
204 60 16-18	Laminate	3	39578/5	10,665	
216 54 16-18	Veneer	3	39579/2	13,165	
216 54 16-18	Laminate	3	39579/5	10,525	
216 60 16-18	Veneer	3	39580/2	13,860	
216 60 16-18	Laminate	3	39580/5	10,925	

* Based on a chair width of 25"

METRONOME™ TABLES

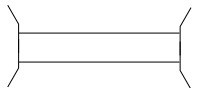

Table Top  **With Power Trough** Table height = 29"
 Rectangle with soft corners

2 Supports 

Specify edge type: add the two letter code after the model number



Note: For powder coat bases, please use model # of anodized bases and add "PC" at the end, e.g. 39403PC/2.

Anodized Bases

Polished Bases

L"	x	D"	Sugg Seat Capacity *	Top Finish	Top Sections	Model Number	List Price
84	42	6-8		Veneer	1	39583/2	6,490
84	42	6-8		Laminate	1	39583/5	5,720
96	42	6-8		Veneer	1	39585/2	6,810
96	42	6-8		Laminate	1	39585/5	5,915
96	48	6-8		Veneer	1	39586/2	7,155
96	48	6-8		Laminate	1	39586/5	6,110
108	42	8-10		Veneer	1	39587/2	7,135
108	42	8-10		Laminate	1	39587/5	6,120
108	48	8-10		Veneer	1	39588/2	7,450
108	48	8-10		Laminate	1	39588/5	6,325
120	42	8-10		Veneer	2	39589/2	7,565
120	42	8-10		Laminate	2	39589/5	6,485
120	48	8-10		Veneer	2	39590/2	7,960
120	48	8-10		Laminate	2	39590/5	6,680
120	54	8-10		Veneer	2	39591/2	8,365
120	54	8-10		Laminate	2	39591/5	6,920

L"	x	D"	Sugg Seat Capacity *	Top Finish	Top Sections	Model Number	List Price
84	42	6-8		Veneer	1	39613/2	6,825
84	42	6-8		Laminate	1	39613/5	6,060
96	42	6-8		Veneer	1	39615/2	7,135
96	42	6-8		Laminate	1	39615/5	6,265
96	48	6-8		Veneer	1	39616/2	7,485
96	48	6-8		Laminate	1	39616/5	6,450
108	42	8-10		Veneer	1	39617/2	7,465
108	42	8-10		Laminate	1	39617/5	6,455
108	48	8-10		Veneer	1	39618/2	7,775
108	48	8-10		Laminate	1	39618/5	6,665
120	42	8-10		Veneer	2	39619/2	7,885
120	42	8-10		Laminate	2	39619/5	6,825
120	48	8-10		Veneer	2	39620/2	8,295
120	48	8-10		Laminate	2	39620/5	7,020
120	54	8-10		Veneer	2	39621/2	8,705
120	54	8-10		Laminate	2	39621/5	7,265

* Based on a chair width of 25"

METRONOME™ TABLES



Table Top  **With Power Trough** Table height = 29"
 Rectangle with soft corners

3 Supports 

Specify edge type: add the two letter code after the model number



Note: For powder coat bases, please use model # of anodized bases and add "PC" at the end, e.g. 39403PC/2.

Anodized Bases							Polished Bases						
L" x D"	Sugg Seat Capacity *	Top Finish	Top Sections	Model Number	List Price	L" x D"	Sugg Seat Capacity *	Top Finish	Top Sections	Model Number	List Price		
132 48 10-12	Veneer	2	39592/2	10,535	132 48 10-12	Veneer	2	39622/2	11,200				
132 48 10-12	Laminate	2	39592/5	9,130	132 48 10-12	Laminate	2	39622/5	9,795				
132 54 10-12	Veneer	2	39593/2	10,985	132 54 10-12	Veneer	2	39623/2	11,650				
132 54 10-12	Laminate	2	39593/5	9,430	132 54 10-12	Laminate	2	39623/5	10,110				
144 48 10-12	Veneer	2	39594/2	10,975	144 48 10-12	Veneer	2	39624/2	11,630				
144 48 10-12	Laminate	2	39594/5	9,425	144 48 10-12	Laminate	2	39624/5	10,095				
144 54 10-12	Veneer	2	39595/2	11,465	144 54 10-12	Veneer	2	39625/2	12,130				
144 54 10-12	Laminate	2	39595/5	9,705	144 54 10-12	Laminate	2	39625/5	10,380				
144 60 10-12	Veneer	2	39596/2	11,940	144 60 10-12	Veneer	2	39626/2	12,615				
144 60 10-12	Laminate	2	39596/5	10,000	144 60 10-12	Laminate	2	39626/5	10,665				
156 48 12-14	Veneer	2	39597/2	12,440	156 48 12-14	Veneer	2	39627/2	13,095				
156 48 12-14	Laminate	2	39597/5	10,755	156 48 12-14	Laminate	2	39627/5	11,420				
156 54 12-14	Veneer	2	39598/2	12,985	156 54 12-14	Veneer	2	39628/2	13,640				
156 54 12-14	Laminate	2	39598/5	11,085	156 54 12-14	Laminate	2	39628/5	11,750				
156 60 12-14	Veneer	2	39599/2	13,470	156 60 12-14	Veneer	2	39629/2	14,140				
156 60 12-14	Laminate	2	39599/5	11,370	156 60 12-14	Laminate	2	39629/5	12,040				
168 48 12-14	Veneer	2	39600/2	12,800	168 48 12-14	Veneer	2	39630/2	13,460				
168 48 12-14	Laminate	2	39600/5	10,980	168 48 12-14	Laminate	2	39630/5	11,650				
168 54 12-14	Veneer	2	39601/2	13,375	168 54 12-14	Veneer	2	39631/2	14,040				
168 54 12-14	Laminate	2	39601/5	11,340	168 54 12-14	Laminate	2	39631/5	11,995				
168 60 12-14	Veneer	2	39602/2	13,905	168 60 12-14	Veneer	2	39632/2	14,580				
168 60 12-14	Laminate	2	39602/5	11,625	168 60 12-14	Laminate	2	39632/5	12,300				
180 54 14-16	Veneer	3	39603/2	13,875	180 54 14-16	Veneer	3	39633/2	14,550				
180 54 14-16	Laminate	3	39603/5	11,695	180 54 14-16	Laminate	3	39633/5	12,355				
180 60 14-16	Veneer	3	39604/2	14,470	180 60 14-16	Veneer	3	39634/2	15,150				
180 60 14-16	Laminate	3	39604/5	12,050	180 60 14-16	Laminate	3	39634/5	12,695				
192 54 14-16	Veneer	3	39605/2	14,280	192 54 14-16	Veneer	3	39635/2	14,935				
192 54 14-16	Laminate	3	39605/5	11,940	192 54 14-16	Laminate	3	39635/5	12,615				
192 60 14-16	Veneer	3	39606/2	14,910	192 60 14-16	Veneer	3	39636/2	15,575				
192 60 14-16	Laminate	3	39606/5	12,305	192 60 14-16	Laminate	3	39636/5	12,985				
204 54 16-18	Veneer	3	39607/2	14,670	204 54 16-18	Veneer	3	39637/2	15,335				
204 54 16-18	Laminate	3	39607/5	12,185	204 54 16-18	Laminate	3	39637/5	12,850				
204 60 16-18	Veneer	3	39608/2	15,335	204 60 16-18	Veneer	3	39638/2	16,005				
204 60 16-18	Laminate	3	39608/5	12,595	204 60 16-18	Laminate	3	39638/5	13,245				
216 54 16-18	Veneer	3	39609/2	15,070	216 54 16-18	Veneer	3	39639/2	15,730				
216 54 16-18	Laminate	3	39609/5	12,440	216 54 16-18	Laminate	3	39639/5	13,100				
216 60 16-18	Veneer	3	39610/2	15,765	216 60 16-18	Veneer	3	39640/2	16,445				
216 60 16-18	Laminate	3	39610/5	12,845	216 60 16-18	Laminate	3	39640/5	13,505				

* Based on a chair width of 25"

METRONOME™ TABLES

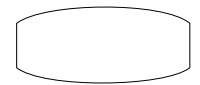
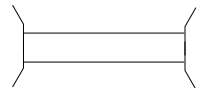

Table Top  **No Power Trough** Table height = 29"
Boat

2 Supports 

Specify edge type: add the two letter code after the model number



Note: For powder coat bases, please use model # of anodized bases and add "PC" at the end, e.g. 39403PC/2.

Anodized Bases

Polished Bases

L" x D"	Sugg Seat Capacity *	Top Finish	Top Sections	Model Number	List Price
84 x 42	6-8	Veneer	1	39643/2	5,520
84 x 42	6-8	Laminate	1	39643/5	4,710
96 x 42	6-8	Veneer	1	39645/2	5,860
96 x 42	6-8	Laminate	1	39645/5	4,910
96 x 48	6-8	Veneer	1	39646/2	6,225
96 x 48	6-8	Laminate	1	39646/5	5,120
108 x 42	8-10	Veneer	1	39647/2	6,200
108 x 42	8-10	Laminate	1	39647/5	5,135
108 x 48	8-10	Veneer	1	39648/2	6,515
108 x 48	8-10	Laminate	1	39648/5	5,360
120 x 42	8-10	Veneer	2	39649/2	6,500
120 x 42	8-10	Laminate	2	39649/5	5,375
120 x 48	8-10	Veneer	2	39650/2	6,920
120 x 48	8-10	Laminate	2	39650/5	5,590
120 x 54	8-10	Veneer	2	39651/2	7,345
120 x 54	8-10	Laminate	2	39651/5	5,855

L" x D"	Sugg Seat Capacity *	Top Finish	Top Sections	Model Number	List Price
84 x 42	6-8	Veneer	1	39673/2	5,875
84 x 42	6-8	Laminate	1	39673/5	5,055
96 x 42	6-8	Veneer	1	39675/2	6,200
96 x 42	6-8	Laminate	1	39675/5	5,270
96 x 48	6-8	Veneer	1	39676/2	6,555
96 x 48	6-8	Laminate	1	39676/5	5,480
108 x 42	8-10	Veneer	1	39677/2	6,535
108 x 42	8-10	Laminate	1	39677/5	5,490
108 x 48	8-10	Veneer	1	39678/2	6,875
108 x 48	8-10	Laminate	1	39678/5	5,705
120 x 42	8-10	Veneer	2	39679/2	6,850
120 x 42	8-10	Laminate	2	39679/5	5,725
120 x 48	8-10	Veneer	2	39680/2	7,275
120 x 48	8-10	Laminate	2	39680/5	5,930
120 x 54	8-10	Veneer	2	39681/2	7,705
120 x 54	8-10	Laminate	2	39681/5	6,180

* Based on a chair width of 25"

METRONOME™ TABLES

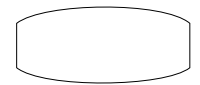
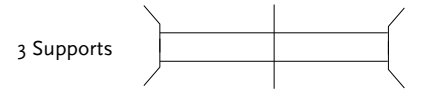

Table Top  **No Power Trough** Table height = 29"
Boat



Specify edge type: add the two letter code after the model number



Note: For powder coat bases, please use model # of anodized bases and add "PC" at the end, e.g. 39403PC/2.

Anodized Bases

L"	x	D"	Sugg Seat Capacity *	Top Finish	Top Sections	Model Number	List Price
132	48	10-12		Veneer	2	39652/2	9,625
132	48	10-12		Laminate	2	39652/5	8,145
132	54	10-12		Veneer	2	39653/2	10,105
132	54	10-12		Laminate	2	39653/5	8,475
144	48	10-12		Veneer	2	39654/2	10,080
144	48	10-12		Laminate	2	39654/5	8,470
144	54	10-12		Veneer	2	39655/2	10,595
144	54	10-12		Laminate	2	39655/5	8,745
144	60	10-12		Veneer	2	39656/2	11,095
144	60	10-12		Laminate	2	39656/5	9,055
156	48	12-14		Veneer	2	39657/2	10,460
156	48	12-14		Laminate	2	39657/5	8,705
156	54	12-14		Veneer	2	39658/2	11,035
156	54	12-14		Laminate	2	39658/5	9,055
156	60	12-14		Veneer	2	39659/2	11,550
156	60	12-14		Laminate	2	39659/5	9,345
168	48	12-14		Veneer	2	39660/2	10,840
168	48	12-14		Laminate	2	39660/5	8,945
168	54	12-14		Veneer	2	39661/2	11,440
168	54	12-14		Laminate	2	39661/5	9,315
168	60	12-14		Veneer	2	39662/2	12,005
168	60	12-14		Laminate	2	39662/5	9,625
180	54	14-16		Veneer	3	39663/2	11,845
180	54	14-16		Laminate	3	39663/5	9,540
180	60	14-16		Veneer	3	39664/2	12,465
180	60	14-16		Laminate	3	39664/5	9,910
192	54	14-16		Veneer	3	39665/2	12,260
192	54	14-16		Laminate	3	39665/5	9,810
192	60	14-16		Veneer	3	39666/2	12,910
192	60	14-16		Laminate	3	39666/5	10,195
204	54	16-18		Veneer	3	39667/2	12,670
204	54	16-18		Laminate	3	39667/5	10,070
204	60	16-18		Veneer	3	39668/2	13,380
204	60	16-18		Laminate	3	39668/5	10,485
216	54	16-18		Veneer	3	39669/2	13,095
216	54	16-18		Laminate	3	39669/5	10,325
216	60	16-18		Veneer	3	39670/2	13,825
216	60	16-18		Laminate	3	39670/5	10,760

Polished Bases

L"	x	D"	Sugg Seat Capacity *	Top Finish	Top Sections	Model Number	List Price
132	48	10-12		Veneer	2	39682/2	10,320
132	48	10-12		Laminate	2	39682/5	8,850
132	54	10-12		Veneer	2	39683/2	10,800
132	54	10-12		Laminate	2	39683/5	9,175
144	54	10-12		Veneer	2	39684/2	10,780
144	48	10-12		Laminate	2	39684/5	9,160
144	54	10-12		Veneer	2	39685/2	11,300
144	54	10-12		Laminate	2	39685/5	9,460
144	60	10-12		Veneer	2	39686/2	11,790
144	60	10-12		Laminate	2	39686/5	9,755
156	48	12-14		Veneer	2	39687/2	11,170
156	48	12-14		Laminate	2	39687/5	9,405
156	54	12-14		Veneer	2	39688/2	11,730
156	54	12-14		Laminate	2	39688/5	9,750
156	60	12-14		Veneer	2	39689/2	12,255
156	60	12-14		Laminate	2	39689/5	10,040
168	48	12-14		Veneer	2	39690/2	11,540
168	48	12-14		Laminate	2	39690/5	9,640
168	54	12-14		Veneer	2	39691/2	12,140
168	54	12-14		Laminate	2	39691/5	10,010
168	60	12-14		Veneer	2	39692/2	12,700
168	60	12-14		Laminate	2	39692/5	10,325
180	54	14-16		Veneer	3	39693/2	12,540
180	54	14-16		Laminate	3	39693/5	10,245
180	60	14-16		Veneer	3	39694/2	13,175
180	60	14-16		Laminate	3	39694/5	10,600
192	54	14-16		Veneer	3	39695/2	12,970
192	54	14-16		Laminate	3	39695/5	10,510
192	60	14-16		Veneer	3	39696/2	13,625
192	60	14-16		Laminate	3	39696/5	10,900
204	54	16-18		Veneer	3	39697/2	13,380
204	54	16-18		Laminate	3	39697/5	10,770
204	60	16-18		Veneer	3	39698/2	14,070
204	60	16-18		Laminate	3	39698/5	11,185
216	54	16-18		Veneer	3	39699/2	13,795
216	54	16-18		Laminate	3	39699/5	11,035
216	60	16-18		Veneer	3	39700/2	14,530
216	60	16-18		Laminate	3	39700/5	11,455

* Based on a chair width of 25"

METRONOME™ TABLES

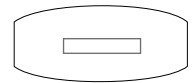
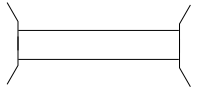

Table Top  **With Power Trough** Table height = 29"
Boat

2 Supports 

Specify edge type: add the two letter code after the model number



Note: For powder coat bases, please use model # of anodized bases and add "PC" at the end, e.g. 39403PC/2.

Anodized Bases

Polished Bases

L" x D"	Sugg Seat Capacity *	Top Finish	Top Sections	Model Number	List Price	L" x D"	Sugg Seat Capacity *	Top Finish	Top Sections	Model Number	List Price
84 x 42	6-8	Veneer	1	39703/2	6,740	84 x 42	6-8	Veneer	1	39733/2	7,090
84 x 42	6-8	Laminate	1	39703/5	5,930	84 x 42	6-8	Laminate	1	39733/5	6,285
96 x 42	6-8	Veneer	1	39705/2	7,070	96 x 42	6-8	Veneer	1	39735/2	7,425
96 x 42	6-8	Laminate	1	39705/5	6,135	96 x 42	6-8	Laminate	1	39735/5	6,495
96 x 48	6-8	Veneer	1	39706/2	7,445	96 x 48	6-8	Veneer	1	39736/2	7,795
96 x 48	6-8	Laminate	1	39706/5	6,335	96 x 48	6-8	Laminate	1	39736/5	6,695
108 x 42	8-10	Veneer	1	39707/2	7,425	108 x 42	8-10	Veneer	1	39737/2	7,760
108 x 42	8-10	Laminate	1	39707/5	6,350	108 x 42	8-10	Laminate	1	39737/5	6,705
108 x 48	8-10	Veneer	1	39708/2	7,750	108 x 48	8-10	Veneer	1	39738/2	8,100
108 x 48	8-10	Laminate	1	39708/5	6,585	108 x 48	8-10	Laminate	1	39738/5	6,925
120 x 42	8-10	Veneer	2	39709/2	7,860	120 x 42	8-10	Veneer	2	39739/2	8,210
120 x 42	8-10	Laminate	2	39709/5	6,720	120 x 42	8-10	Laminate	2	39739/5	7,075
120 x 48	8-10	Veneer	2	39710/2	8,280	120 x 48	8-10	Veneer	2	39740/2	8,625
120 x 48	8-10	Laminate	2	39710/5	6,940	120 x 48	8-10	Laminate	2	39740/5	7,290
120 x 54	8-10	Veneer	2	39711/2	8,705	120 x 54	8-10	Veneer	2	39741/2	9,060
120 x 54	8-10	Laminate	2	39711/5	7,200	120 x 54	8-10	Laminate	2	39741/5	7,540

* Based on a chair width of 25"

METRONOME™ TABLES



Table height = 29"

3 Supports



Specify edge type: add the two letter code after the model number



Taper Edge (TE) Self Edge (SE) Facet Edge (FE)

Note: For powder coat bases, please use model # of anodized bases and add "PC" at the end, e.g. 39403PC/2.

Anodized Bases

Polished Bases

L" x D"	Sugg Seat Capacity*	Top Finish	Top Sections	Model Number	List Price	L" x D"	Sugg Seat Capacity*	Top Finish	Top Sections	Model Number	List Price
132 x 48	10-12	Veneer	2	39712/2	10,980	132 x 48	10-12	Veneer	2	39742/2	11,685
132 x 48	10-12	Laminate	2	39712/5	9,505	132 x 48	10-12	Laminate	2	39742/5	10,195
132 x 54	10-12	Veneer	2	39713/2	11,455	132 x 54	10-12	Veneer	2	39743/2	12,145
132 x 54	10-12	Laminate	2	39713/5	9,825	132 x 54	10-12	Laminate	2	39743/5	10,535
144 x 48	10-12	Veneer	2	39714/2	11,435	144 x 48	10-12	Veneer	2	39744/2	12,130
144 x 48	10-12	Laminate	2	39714/5	9,820	144 x 48	10-12	Laminate	2	39744/5	10,525
144 x 54	10-12	Veneer	2	39715/2	11,950	144 x 54	10-12	Veneer	2	39745/2	12,650
144 x 54	10-12	Laminate	2	39715/5	10,110	144 x 54	10-12	Laminate	2	39745/5	10,810
144 x 60	10-12	Veneer	2	39716/2	12,455	144 x 60	10-12	Veneer	2	39746/2	13,150
144 x 60	10-12	Laminate	2	39716/5	10,415	144 x 60	10-12	Laminate	2	39746/5	11,110
156 x 48	12-14	Veneer	2	39717/2	12,905	156 x 48	12-14	Veneer	2	39747/2	13,615
156 x 48	12-14	Laminate	2	39717/5	11,170	156 x 48	12-14	Laminate	2	39747/5	11,865
156 x 54	12-14	Veneer	2	39718/2	13,480	156 x 54	12-14	Veneer	2	39748/2	14,185
156 x 54	12-14	Laminate	2	39718/5	11,515	156 x 54	12-14	Laminate	2	39748/5	12,220
156 x 60	12-14	Veneer	2	39719/2	14,005	156 x 60	12-14	Veneer	2	39749/2	14,705
156 x 60	12-14	Laminate	2	39719/5	11,800	156 x 60	12-14	Laminate	2	39749/5	12,490
168 x 48	12-14	Veneer	2	39720/2	13,285	168 x 48	12-14	Veneer	2	39750/2	13,995
168 x 48	12-14	Laminate	2	39720/5	11,395	168 x 48	12-14	Laminate	2	39750/5	12,095
168 x 54	12-14	Veneer	2	39721/2	13,895	168 x 54	12-14	Veneer	2	39751/2	14,605
168 x 54	12-14	Laminate	2	39721/5	11,765	168 x 54	12-14	Laminate	2	39751/5	12,465
168 x 60	12-14	Veneer	2	39722/2	14,465	168 x 60	12-14	Veneer	2	39752/2	15,165
168 x 60	12-14	Laminate	2	39722/5	12,080	168 x 60	12-14	Laminate	2	39752/5	12,790
180 x 54	14-16	Veneer	3	39723/2	14,430	180 x 54	14-16	Veneer	3	39753/2	15,130
180 x 54	14-16	Laminate	3	39723/5	12,125	180 x 54	14-16	Laminate	3	39753/5	12,835
180 x 60	14-16	Veneer	3	39724/2	15,050	180 x 60	14-16	Veneer	3	39754/2	15,750
180 x 60	14-16	Laminate	3	39724/5	12,485	180 x 60	14-16	Laminate	3	39754/5	13,190
192 x 54	14-16	Veneer	3	39725/2	14,840	192 x 54	14-16	Veneer	3	39755/2	15,535
192 x 54	14-16	Laminate	3	39725/5	12,405	192 x 54	14-16	Laminate	3	39755/5	13,085
192 x 60	14-16	Veneer	3	39726/2	15,505	192 x 60	14-16	Veneer	3	39756/2	16,200
192 x 60	14-16	Laminate	3	39726/5	12,790	192 x 60	14-16	Laminate	3	39756/5	13,475
204 x 54	16-18	Veneer	3	39727/2	15,255	204 x 54	16-18	Veneer	3	39757/2	15,960
204 x 54	16-18	Laminate	3	39727/5	12,650	204 x 54	16-18	Laminate	3	39757/5	13,360
204 x 60	16-18	Veneer	3	39728/2	15,960	204 x 60	16-18	Veneer	3	39758/2	16,665
204 x 60	16-18	Laminate	3	39728/5	13,060	204 x 60	16-18	Laminate	3	39758/5	13,770
216 x 54	16-18	Veneer	3	39729/2	15,685	216 x 54	16-18	Veneer	3	39759/2	16,375
216 x 54	16-18	Laminate	3	39729/5	12,900	216 x 54	16-18	Laminate	3	39759/5	13,615
216 x 60	16-18	Veneer	3	39730/2	16,405	216 x 60	16-18	Veneer	3	39760/2	17,110
216 x 60	16-18	Laminate	3	39730/5	13,345	216 x 60	16-18	Laminate	3	39760/5	14,040

* Based on a chair width of 25"

METRONOME™ TABLES

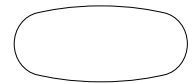
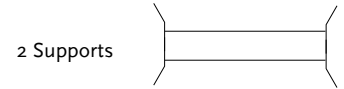

Table Top  **No Power Trough** Table height = 29"
Super Ellipse



Specify edge type: add the two letter code after the model number



Note: For powder coat bases, please use model # of anodized bases and add "PC" at the end, e.g. 39403PC/2.

Anodized Bases

Polished Bases

L" x D"	Sugg Seat Capacity *	Top Finish	Top Sections	Model Number	List Price	L" x D"	Sugg Seat Capacity *	Top Finish	Top Sections	Model Number	List Price
84 x 42	6-8	Veneer	1	39763/2	5,785	84 x 42	6-8	Veneer	1	39793/2	5,970
84 x 42	6-8	Laminate	1	39763/5	4,935	84 x 42	6-8	Laminate	1	39793/5	5,150
96 x 42	6-8	Veneer	1	39765/2	6,125	96 x 42	6-8	Veneer	1	39795/2	6,305
96 x 42	6-8	Laminate	1	39765/5	5,160	96 x 42	6-8	Laminate	1	39795/5	5,370
96 x 48	6-8	Veneer	1	39766/2	6,510	96 x 48	6-8	Veneer	1	39796/2	6,680
96 x 48	6-8	Laminate	1	39766/5	5,375	96 x 48	6-8	Laminate	1	39796/5	5,570
108 x 42	8-10	Veneer	1	39767/2	6,495	108 x 42	8-10	Veneer	1	39797/2	6,665
108 x 42	8-10	Laminate	1	39767/5	5,380	108 x 42	8-10	Laminate	1	39797/5	5,580
108 x 48	8-10	Veneer	1	39768/2	6,840	108 x 48	8-10	Veneer	1	39798/2	7,000
108 x 48	8-10	Laminate	1	39768/5	5,620	108 x 48	8-10	Laminate	1	39798/5	5,810
120 x 42	8-10	Veneer	2	39769/2	6,830	120 x 42	8-10	Veneer	2	39799/2	6,980
120 x 42	8-10	Laminate	2	39769/5	5,640	120 x 42	8-10	Laminate	2	39799/5	5,835
120 x 48	8-10	Veneer	2	39770/2	7,270	120 x 48	8-10	Veneer	2	39800/2	7,415
120 x 48	8-10	Laminate	2	39770/5	5,870	120 x 48	8-10	Laminate	2	39800/5	6,055
120 x 54	8-10	Veneer	2	39771/2	7,710	120 x 54	8-10	Veneer	2	39801/2	7,850
120 x 54	8-10	Laminate	2	39771/5	6,120	120 x 54	8-10	Laminate	2	39801/5	6,295

* Based on a chair width of 25"

METRONOME™ TABLES

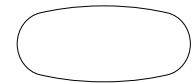
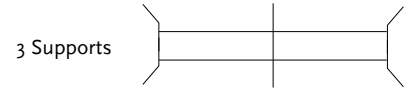

Table Top  **No Power Trough**
Super Ellipse

Table height = 29"



Specify edge type: add the two letter code after the model number



Note: For powder coat bases, please use model # of anodized bases and add "PC" at the end, e.g. 39403PC/2.

Anodized Bases							Polished Bases								
L"	x	D"	Sugg Seat Capacity *	Top Finish	Top Sections	Model Number	List Price	L"	x	D"	Sugg Seat Capacity *	Top Finish	Top Sections	Model Number	List Price
132	48	10-12		Veneer	2	39772/2	10,095	132	48	10-12		Veneer	2	39802/2	10,520
132	48	10-12		Laminate	2	39772/5	8,540	132	48	10-12		Laminate	2	39802/5	9,005
132	54	10-12		Veneer	2	39773/2	10,590	132	54	10-12		Veneer	2	39803/2	11,000
132	54	10-12		Laminate	2	39773/5	8,885	132	54	10-12		Laminate	2	39803/5	9,345
144	48	10-12		Veneer	2	39774/2	10,580	144	48	10-12		Veneer	2	39804/2	10,980
144	48	10-12		Laminate	2	39774/5	8,880	144	48	10-12		Laminate	2	39804/5	9,335
144	54	10-12		Veneer	2	39775/2	11,120	144	54	10-12		Veneer	2	39805/2	11,515
144	54	10-12		Laminate	2	39775/5	9,180	144	54	10-12		Laminate	2	39805/5	9,630
144	60	10-12		Veneer	2	39776/2	11,630	144	60	10-12		Veneer	2	39806/2	12,005
144	60	10-12		Laminate	2	39776/5	9,505	144	60	10-12		Laminate	2	39806/5	9,935
156	48	12-14		Veneer	2	39777/2	10,975	156	48	12-14		Veneer	2	39807/2	11,370
156	48	12-14		Laminate	2	39777/5	9,135	156	48	12-14		Laminate	2	39807/5	9,575
156	54	12-14		Veneer	2	39778/2	11,575	156	54	12-14		Veneer	2	39808/2	11,945
156	54	12-14		Laminate	2	39778/5	9,500	156	54	12-14		Laminate	2	39808/5	9,930
156	60	12-14		Veneer	2	39779/2	12,115	156	60	12-14		Veneer	2	39809/2	12,475
156	60	12-14		Laminate	2	39779/5	9,805	156	60	12-14		Laminate	2	39809/5	10,230
168	48	12-14		Veneer	2	39780/2	11,370	168	48	12-14		Veneer	2	39810/2	11,745
168	48	12-14		Laminate	2	39780/5	9,380	168	48	12-14		Laminate	2	39810/5	9,820
168	54	12-14		Veneer	2	39781/2	12,000	168	54	12-14		Veneer	2	39811/2	12,370
168	54	12-14		Laminate	2	39781/5	9,760	168	54	12-14		Laminate	2	39811/5	10,190
168	60	12-14		Veneer	2	39782/2	12,610	168	60	12-14		Veneer	2	39812/2	12,945
168	60	12-14		Laminate	2	39782/5	10,095	168	60	12-14		Laminate	2	39812/5	10,525
180	54	14-16		Veneer	3	39783/2	12,425	180	54	14-16		Veneer	3	39813/2	12,790
180	54	14-16		Laminate	3	39783/5	10,015	180	54	14-16		Laminate	3	39813/5	10,440
180	60	14-16		Veneer	3	39784/2	13,070	180	60	14-16		Veneer	3	39814/2	13,415
180	60	14-16		Laminate	3	39784/5	10,400	180	60	14-16		Laminate	3	39814/5	10,805
192	54	14-16		Veneer	3	39785/2	12,855	192	54	14-16		Veneer	3	39815/2	13,205
192	54	14-16		Laminate	3	39785/5	10,295	192	54	14-16		Laminate	3	39815/5	10,700
192	60	14-16		Veneer	3	39786/2	13,560	192	60	14-16		Veneer	3	39816/2	13,870
192	60	14-16		Laminate	3	39786/5	10,695	192	60	14-16		Laminate	3	39816/5	11,095
204	54	16-18		Veneer	3	39787/2	13,290	204	54	16-18		Veneer	3	39817/2	13,630
204	54	16-18		Laminate	3	39787/5	10,565	204	54	16-18		Laminate	3	39817/5	10,970
204	60	16-18		Veneer	3	39788/2	14,035	204	60	16-18		Veneer	3	39818/2	14,340
204	60	16-18		Laminate	3	39788/5	11,000	204	60	16-18		Laminate	3	39818/5	11,385
216	54	16-18		Veneer	3	39789/2	13,740	216	54	16-18		Veneer	3	39819/2	14,050
216	54	16-18		Laminate	3	39789/5	10,840	216	54	16-18		Laminate	3	39819/5	11,235
216	60	16-18		Veneer	3	39790/2	14,500	216	60	16-18		Veneer	3	39820/2	14,805
216	60	16-18		Laminate	3	39790/5	11,285	216	60	16-18		Laminate	3	39820/5	11,670

* Based on a chair width of 25"

METRONOME™ TABLES

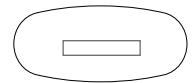
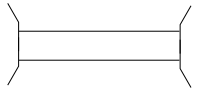

Table Top  **With Power Trough** Table height = 29"
Super Ellipse

2 Supports 

Specify edge type: add the two letter code after the model number



Note: For powder coat bases, please use model # of anodized bases and add "PC" at the end, e.g. 39403PC/2.

Anodized Bases

Polished Bases

L" x D"	Sugg Seat Capacity *	Top Finish	Top Sections	Model Number	List Price	L" x D"	Sugg Seat Capacity *	Top Finish	Top Sections	Model Number	List Price
84 x 42	6-8	Veneer	1	39823/2	7,020	84 x 42	6-8	Veneer	1	39853/2	7,205
84 x 42	6-8	Laminate	1	39823/5	6,150	84 x 42	6-8	Laminate	1	39853/5	6,370
96 x 42	6-8	Veneer	1	39825/2	7,350	96 x 42	6-8	Veneer	1	39855/2	7,535
96 x 42	6-8	Laminate	1	39825/5	6,390	96 x 42	6-8	Laminate	1	39855/5	6,605
96 x 48	6-8	Veneer	1	39826/2	7,740	96 x 48	6-8	Veneer	1	39856/2	7,915
96 x 48	6-8	Laminate	1	39826/5	6,610	96 x 48	6-8	Laminate	1	39856/5	6,810
108 x 42	8-10	Veneer	1	39827/2	7,720	108 x 42	8-10	Veneer	1	39857/2	7,885
108 x 42	8-10	Laminate	1	39827/5	6,615	108 x 42	8-10	Laminate	1	39857/5	6,815
108 x 48	8-10	Veneer	1	39828/2	8,065	108 x 48	8-10	Veneer	1	39858/2	8,225
108 x 48	8-10	Laminate	1	39828/5	6,845	108 x 48	8-10	Laminate	1	39858/5	7,045
120 x 42	8-10	Veneer	2	39829/2	8,185	120 x 42	8-10	Veneer	2	39859/2	9,535
120 x 42	8-10	Laminate	2	39829/5	7,000	120 x 42	8-10	Laminate	2	39859/5	8,350
120 x 48	8-10	Veneer	2	39830/2	8,620	120 x 48	8-10	Veneer	2	39860/2	9,985
120 x 48	8-10	Laminate	2	39830/5	7,220	120 x 48	8-10	Laminate	2	39860/5	8,570
120 x 54	8-10	Veneer	2	39831/2	9,070	120 x 54	8-10	Veneer	2	39861/2	10,420
120 x 54	8-10	Laminate	2	39831/5	7,480	120 x 54	8-10	Laminate	2	39861/5	8,840

* Based on a chair width of 25"

METRONOME™ TABLES

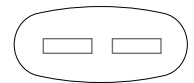

Table Top



With Power Trough

Table height = 29"

3 Supports



Specify edge type: add the two letter code after the model number



Taper Edge (TE)



Self Edge (SE)



Facet Edge (FE)

Note: For powder coat bases, please use model # of anodized bases and add "PC" at the end, e.g. 39403PC/2.

Anodized Bases

L" x D"	Sugg Seat Capacity *	Top Finish	Top Sections	Model Number	List Price
132 x 48	10-12	Veneer	2	39832/2	11,445
132 x 48	10-12	Laminate	2	39832/5	9,900
132 x 54	10-12	Veneer	2	39833/2	11,945
132 x 54	10-12	Laminate	2	39833/5	10,240
144 x 48	10-12	Veneer	2	39834/2	11,935
144 x 48	10-12	Laminate	2	39834/5	10,235
144 x 54	10-12	Veneer	2	39835/2	12,475
144 x 54	10-12	Laminate	2	39835/5	10,540
144 x 60	10-12	Veneer	2	39836/2	13,000
144 x 60	10-12	Laminate	2	39836/5	10,855
156 x 48	12-14	Veneer	2	39837/2	13,425
156 x 48	12-14	Laminate	2	39837/5	11,585
156 x 54	12-14	Veneer	2	39838/2	14,025
156 x 54	12-14	Laminate	2	39838/5	11,945
156 x 60	12-14	Veneer	2	39839/2	14,565
156 x 60	12-14	Laminate	2	39839/5	12,260
168 x 48	12-14	Veneer	2	39840/2	13,820
168 x 48	12-14	Laminate	2	39840/5	11,830
168 x 54	12-14	Veneer	2	39841/2	14,460
168 x 54	12-14	Laminate	2	39841/5	12,230
168 x 60	12-14	Veneer	2	39842/2	15,055
168 x 60	12-14	Laminate	2	39842/5	12,540
180 x 54	14-16	Veneer	3	39843/2	15,000
180 x 54	14-16	Laminate	3	39843/5	12,610
180 x 60	14-16	Veneer	3	39844/2	15,655
180 x 60	14-16	Laminate	3	39844/5	12,990
192 x 54	14-16	Veneer	3	39845/2	15,440
192 x 54	14-16	Laminate	3	39845/5	12,870
192 x 60	14-16	Veneer	3	39846/2	16,130
192 x 60	14-16	Laminate	3	39846/5	13,275
204 x 54	16-18	Veneer	3	39847/2	15,880
204 x 54	16-18	Laminate	3	39847/5	13,150
204 x 60	16-18	Veneer	3	39848/2	16,610
204 x 60	16-18	Laminate	3	39848/5	13,585
216 x 54	16-18	Veneer	3	39849/2	16,320
216 x 54	16-18	Laminate	3	39849/5	13,420
216 x 60	16-18	Veneer	3	39850/2	17,090
216 x 60	16-18	Laminate	3	39850/5	13,870

Polished Bases

L" x D"	Sugg Seat Capacity *	Top Finish	Top Sections	Model Number	List Price
132 x 48	10-12	Veneer	2	39862/2	12,810
132 x 48	10-12	Laminate	2	39862/5	11,250
132 x 54	10-12	Veneer	2	39863/2	13,295
132 x 54	10-12	Laminate	2	39863/5	11,595
144 x 54	10-12	Veneer	2	39864/2	13,285
144 x 48	10-12	Laminate	2	39864/5	11,590
144 x 54	10-12	Veneer	2	39865/2	13,830
144 x 54	10-12	Laminate	2	39865/5	11,895
144 x 60	10-12	Veneer	2	39866/2	14,345
144 x 60	10-12	Laminate	2	39866/5	12,225
156 x 48	12-14	Veneer	2	39867/2	15,880
156 x 48	12-14	Laminate	2	39867/5	14,040
156 x 54	12-14	Veneer	2	39868/2	16,480
156 x 54	12-14	Laminate	2	39868/5	14,405
156 x 60	12-14	Veneer	2	39869/2	17,025
156 x 60	12-14	Laminate	2	39869/5	14,710
168 x 48	12-14	Veneer	2	39870/2	16,275
168 x 48	12-14	Laminate	2	39870/5	14,285
168 x 54	12-14	Veneer	2	39871/2	16,910
168 x 54	12-14	Laminate	2	39871/5	14,670
168 x 60	12-14	Veneer	2	39872/2	17,505
168 x 60	12-14	Laminate	2	39872/5	15,000
180 x 54	14-16	Veneer	3	39873/2	15,360
180 x 54	14-16	Laminate	3	39873/5	13,025
180 x 60	14-16	Veneer	3	39874/2	15,995
180 x 60	14-16	Laminate	3	39874/5	13,390
192 x 54	14-16	Veneer	3	39875/2	15,785
192 x 54	14-16	Laminate	3	39875/5	13,280
192 x 60	14-16	Veneer	3	39876/2	16,460
192 x 60	14-16	Laminate	3	39876/5	13,675
204 x 54	16-18	Veneer	3	39877/2	16,205
204 x 54	16-18	Laminate	3	39877/5	13,545
204 x 60	16-18	Veneer	3	39878/2	16,920
204 x 60	16-18	Laminate	3	39878/5	13,970
216 x 54	16-18	Veneer	3	39879/2	16,640
216 x 54	16-18	Laminate	3	39879/5	13,820
216 x 60	16-18	Veneer	3	39880/2	17,385
216 x 60	16-18	Laminate	3	39880/5	14,255

* Based on a chair width of 25"

METRONOME™ TABLES

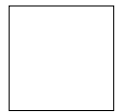



Table Top  **No Power Trough** Table height = 29"
 Square

2 Supports 

Specify edge type: add the two letter code after the model number



Note: For powder coat bases, please use model # of anodized bases and add "PC" at the end, e.g. 39403PC/2.

Anodized Bases

Polished Bases

L" x D"	Sugg Seat Capacity *	Top Finish	Top Sections	Model Number	List Price
48 x 48	2-4	Veneer	1	39881/2	3,220
48 x 48	2-4	Laminate	1	39881/5	2,730
54 x 54	4-6	Veneer	1	39882/2	3,890
54 x 54	4-6	Laminate	1	39882/5	3,280
60 x 60	6-8	Veneer	1	39883/2	4,670
60 x 60	6-8	Laminate	1	39883/5	3,890
66 x 66	6-8	Veneer	2	39884/2	5,765
66 x 66	6-8	Laminate	2	39884/5	4,670
72 x 72	6-8	Veneer	2	39885/2	6,425
72 x 72	6-8	Laminate	2	39885/5	5,280

L" x D"	Sugg Seat Capacity *	Top Finish	Top Sections	Model Number	List Price
48 x 48	2-4	Veneer	1	39886/2	3,280
48 x 48	2-4	Laminate	1	39886/5	2,830
54 x 54	4-6	Veneer	1	39887/2	3,990
54 x 54	4-6	Laminate	1	39887/5	3,375
60 x 60	6-8	Veneer	1	39888/2	4,735
60 x 60	6-8	Laminate	1	39888/5	3,990
66 x 66	6-8	Veneer	2	39889/2	5,900
66 x 66	6-8	Laminate	2	39889/5	4,800
72 x 72	6-8	Veneer	2	39890/2	6,475
72 x 72	6-8	Laminate	2	39890/5	5,380

* Based on a chair width of 25"

METRONOME™ TABLES

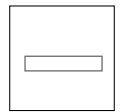



Table Top  **With Power Trough** Table height = 29"
 Square

2 Supports 

Specify edge type: add the two letter code after the model number



Note: For powder coat bases, please use model # of anodized bases and add "PC" at the end, e.g. 39403PC/2.

Anodized Bases

Polished Bases

L" x D"	Sugg Seat Capacity *	Top Finish	Top Sections	Model Number	List Price
48 x 48	2-4	Veneer	1	39901/2	4,245
48 x 48	2-4	Laminate	1	39901/5	3,765
54 x 54	4-6	Veneer	1	39902/2	4,920
54 x 54	4-6	Laminate	1	39902/5	4,315
60 x 60	6-8	Veneer	1	39903/2	5,705
60 x 60	6-8	Laminate	1	39903/5	4,920
66 x 66	6-8	Veneer	2	39904/2	6,810
66 x 66	6-8	Laminate	2	39904/5	5,705
72 x 72	6-8	Veneer	2	39905/2	7,450
72 x 72	6-8	Laminate	2	39905/5	6,310

L" x D"	Sugg Seat Capacity *	Top Finish	Top Sections	Model Number	List Price
48 x 48	2-4	Veneer	1	39906/2	4,315
48 x 48	2-4	Laminate	1	39906/5	3,860
54 x 54	4-6	Veneer	1	39907/2	5,025
54 x 54	4-6	Laminate	1	39907/5	4,410
60 x 60	6-8	Veneer	1	39908/2	5,765
60 x 60	6-8	Laminate	1	39908/5	5,025
66 x 66	6-8	Veneer	2	39909/2	6,925
66 x 66	6-8	Laminate	2	39909/5	5,835
72 x 72	6-8	Veneer	2	39910/2	7,505
72 x 72	6-8	Laminate	2	39910/5	6,425

METRONOME™ TABLES

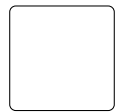

Table Top  **No Power Trough** Table height = 29"
 Square with soft corners

2 Supports 

Specify edge type: add the two letter code after the model number



Note: For powder coat bases, please use model # of anodized bases and add "PC" at the end, e.g. 39403PC/2.

Anodized Bases

Polished Bases

L" x D"	Sugg Seat Capacity *	Top Finish	Top Sections	Model Number	List Price
48 x 48	2-4	Veneer	1	39891/2	3,320
48 x 48	2-4	Laminate	1	39891/5	2,815
54 x 54	4-6	Veneer	1	39892/2	4,010
54 x 54	4-6	Laminate	1	39892/5	3,375
60 x 60	6-8	Veneer	1	39893/2	4,820
60 x 60	6-8	Laminate	1	39893/5	4,010
66 x 66	6-8	Veneer	2	39894/2	5,935
66 x 66	6-8	Laminate	2	39894/5	4,820
72 x 72	6-8	Veneer	2	39895/2	6,615
72 x 72	6-8	Laminate	2	39895/5	5,435

L" x D"	Sugg Seat Capacity *	Top Finish	Top Sections	Model Number	List Price
48 x 48	2-4	Veneer	1	39896/2	3,375
48 x 48	2-4	Laminate	1	39896/5	2,915
54 x 54	4-6	Veneer	1	39897/2	4,105
54 x 54	4-6	Laminate	1	39897/5	3,480
60 x 60	6-8	Veneer	1	39898/2	4,875
60 x 60	6-8	Laminate	1	39898/5	4,105
66 x 66	6-8	Veneer	2	39899/2	6,075
66 x 66	6-8	Laminate	2	39899/5	4,945
72 x 72	6-8	Veneer	2	39900/2	6,670
72 x 72	6-8	Laminate	2	39900/5	5,540

* Based on a chair width of 25"

METRONOME™ TABLES

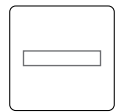

Table Top  **With Power Trough** Table height = 29"
 Square with soft corners

2 Supports



Specify edge type: add the two letter code after the model number



Note: For powder coat bases, please use model # of anodized bases and add "PC" at the end, e.g. 39403PC/2.

Anodized Bases

Polished Bases

L" x D"	Sugg Seat Capacity *	Top Finish	Top Sections	Model Number	List Price
48 x 48	4-6	Veneer	1	39911/2	4,350
48 x 48	4-6	Laminate	1	39911/5	3,850
54 x 54	4-6	Veneer	1	39912/2	5,045
54 x 54	4-6	Laminate	1	39912/5	4,410
60 x 60	6-8	Veneer	1	39913/2	5,860
60 x 60	6-8	Laminate	1	39913/5	5,045
66 x 66	6-8	Veneer	2	39914/2	6,970
66 x 66	6-8	Laminate	2	39914/5	5,860
72 x 72	6-8	Veneer	2	39915/2	7,640
72 x 72	6-8	Laminate	2	39915/5	6,470

L" x D"	Sugg Seat Capacity *	Top Finish	Top Sections	Model Number	List Price
48 x 48	4-6	Veneer	1	39916/2	4,410
48 x 48	4-6	Laminate	1	39916/5	3,945
54 x 54	4-6	Veneer	1	39917/2	5,140
54 x 54	4-6	Laminate	1	39917/5	4,510
60 x 60	6-8	Veneer	1	39918/2	5,910
60 x 60	6-8	Laminate	1	39918/5	5,140
66 x 66	6-8	Veneer	2	39919/2	7,100
66 x 66	6-8	Laminate	2	39919/5	5,970
72 x 72	6-8	Veneer	2	39920/2	7,705
72 x 72	6-8	Laminate	2	39920/5	6,565

* Based on a chair width of 25"

METRONOME™ TABLES

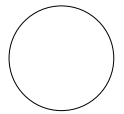

Table height = 29"

2 Supports



Specify edge type: add the two letter code after the model number



Note: For powder coat bases, please use model # of anodized bases and add "PC" at the end, e.g. 39403PC/2.

Anodized Bases

Polished Bases

L" x D"	Sugg Seat Capacity *	Top Finish	Top Sections	Model Number	List Price
48 x 48		Veneer	1	39921/2	3,320
48 x 48		Laminate	1	39921/5	2,815
54 x 54		Veneer	1	39922/2	4,010
54 x 54		Laminate	1	39922/5	3,375
60 x 60		Veneer	1	39923/2	4,820
60 x 60		Laminate	1	39923/5	4,010
66 x 66		Veneer	2	39924/2	5,935
66 x 66		Laminate	2	39924/5	4,820
72 x 72		Veneer	2	39925/2	6,615
72 x 72		Laminate	2	39925/5	5,435

L" x D"	Sugg Seat Capacity *	Top Finish	Top Sections	Model Number	List Price
48 x 48		Veneer	1	39926/2	3,375
48 x 48		Laminate	1	39926/5	2,915
54 x 54		Veneer	1	39927/2	4,105
54 x 54		Laminate	1	39927/5	3,480
60 x 60		Veneer	1	39928/2	4,875
60 x 60		Laminate	1	39928/5	4,105
66 x 66		Veneer	2	39929/2	6,075
66 x 66		Laminate	2	39929/5	4,945
72 x 72		Veneer	2	39930/2	6,670
72 x 72		Laminate	2	39930/5	5,540

* Based on a chair width of 25"

METRONOME™ TABLES

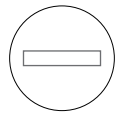



Table Top  **With Power Trough** Table height = 29"
 Round

2 Supports 

Specify edge type: add the two letter code after the model number



Note: For powder coat bases, please use model # of anodized bases and add "PC" at the end, e.g. 39403PC/2.

L" x D"	Sugg Seat Capacity *	Top Finish	Top Sections	Model Number	List Price	L" x D"	Sugg Seat Capacity *	Top Finish	Top Sections	Model Number	List Price
48 x 48		Veneer	1	39931/2	4,350	48 x 48		Veneer	1	39936/2	4,410
48 x 48		Laminate	1	39931/5	3,850	48 x 48		Laminate	1	39936/5	3,945
54 x 54		Veneer	1	39932/2	5,045	54 x 54		Veneer	1	39937/2	5,140
54 x 54		Laminate	1	39932/5	4,410	54 x 54		Laminate	1	39937/5	4,510
60 x 60		Veneer	1	39933/2	5,860	60 x 60		Veneer	1	39938/2	5,910
60 x 60		Laminate	1	39933/5	5,045	60 x 60		Laminate	1	39938/5	5,140
66 x 66		Veneer	2	39934/2	6,970	66 x 66		Veneer	2	39939/2	7,100
66 x 66		Laminate	2	39934/5	5,860	66 x 66		Laminate	2	39939/5	5,970
72 x 72		Veneer	2	39935/2	7,640	72 x 72		Veneer	2	39940/2	7,705
72 x 72		Laminate	2	39935/5	6,470	72 x 72		Laminate	2	39940/5	6,565

* Based on a chair width of 25"

