

Vox[®] FlipTop[™]

Mark Muller



nienkämper

Prices include freight charges, blanket wrapped, dock delivered, from the manufacturing source to any location in the contiguous United States. Packing and/or crating are available, if required, upcharges apply.

TABLE OF CONTENTS

REPRESENTATIVES	4-5
WOOD VENEER/FINISHES	6
WOOD GRAIN PLASTIC LAMINATE SURFACES	7
BASE & STORAGE INFORMATION	8
FLIPTOP™ MODESTY PANEL PHOTOGRAPHS	9
FORUM INFORMATION	10
VOX®FLIPTOP™ CABLING PHOTOGRAPHY	13
VOX®FLIPTOP™ MEETING TABLES PHOTOGRAPHY	14
VOX®FLIPTOP™ MEETING TABLES WITH FLUSH LEGS	15-21
Tables for Meeting Room Applications	15-18
Meeting Room Layouts	19-21
VOX®FLIPTOP™ MEETING TABLES WITH INSET LEGS	22-29
Planning with FlipTop™ Tables	23
Tables for Meeting Room Applications	24-26
Meeting Room Layouts	27-29
VOX®FLIPTOP™ CONFERENCE TABLES	30-37
Edge Details	31
Forum Information	32
FlipTop™ Infill FlipTop™ Tables used with Conference Tables	33
Vox®Conference™ Tables used with Infill FlipTop™ Tables	34-35
Conference Room Layouts	36-37
TERMS AND CONDITIONS OF SALE	38

REPRESENTATIVES

For updated information on Nienkämper representatives visit our web site at www.nienkamper.com.

CORPORATE OFFICE, FACTORY & SHOWROOM TORONTO

Nienkämper Furniture & Accessories Inc.
257 Finchdene Square, Toronto, ON M1X 1B9
mail@nienkamper.com

Tel (416) 298-5700
Fax (416) 298-9535
Customer Service Tel 1-800-668-9318
Customer Service Fax (416) 298-9386

NIENKAMPER SHOWROOMS BOSTON

112 Beach Street, Unit A, Boston, MA 02111

Tel (617) 439-0800
Fax (617) 439-4466

CHICAGO

365 Merchandise Mart, Chicago, IL 60654

Tel (312) 222-0160
Fax (312) 222-9839

DALLAS

150 Turtle Creek Blvd, Suite 103, Dallas, Texas 75207
Kendra Madison: KendraM@icfgroup.com

Tel (469) 518-8400

NEW YORK

320 Fifth Ave., Suite 802, New York, NY 10001
Derek Ocasio: dereko@unikavaev.com

Tel (212) 388-1000 x 2125

US REPRESENTATIVES

ALABAMA

Tennessee, Florida (Panhandle territories)
Mississippi

MB Design Elements, LLC (Megan Brown)
1827 First Ave. North, Suite 212, Birmingham, AL 35203

Tel (205) 746 5269

ARIZONA

New Mexico (El Paso, TX)

Contract Furniture Associates (Dan Lynn)
430 E Taro Lane, Phoenix, AZ 85024
cntrctfurn@aol.com

Tel (480) 684 4400

Contract Furniture Associates (Resa Anaya)
808 Palmas Altas Dr. SE, Rio Rancho, NM 87124
ressa.cfa@gmail.com

Tel (505) 288 1057

CALIFORNIA (Los Angeles, San Diego)
South of Fresno, Hawaii

LGS Group (Laura Goldman-Shubb)
15531 Morrison St. # 100, Sherman Oaks, CA 91403
laura@lgsgroup.com

Tel (818) 990 8985
Fax (818) 990 8983

CALIFORNIA

Oakland, San Jose, Sacramento, Bay Area,
Northern California, San Francisco

Linked (Rob Jones)
2528 Qume Drive, Unit 6, San Jose, CA 95131
rob@linkedreps.com

Tel (925) 786 0178

COLORADO

Utah, Wyoming

UnEk Environments (Wendi Harris)
2633 Meade St., Denver, CO 80211
wendi@unek-environments.com

Tel (303) 994 9746

CONNECTICUT

Westchester County

Ritz - CT (Dennis Votta)
25 Hamilton Drive, East Greenwich, RI 02818
dennis@ritzinc.com

Tel (401) 440 9883

FLORIDA (North, Central & South)

MacPhee Contract Solutions, LLC (Mark MacPhee)
6039 Cypress Gardens Blvd. #292, Winter Haven, FL 33884
mdmacphee@gmail.com

Tel (863) 409 0951

GEORGIA

Purser & Partners (Russell Purser)
25208 Plantation Drive, NE, Atlanta, GA 30324
pandpinc@mindspring.com

Tel (404) 941 9335
Cell (404) 822 6199

ILLINOIS

North of Springfield, Wisconsin (Appleton,
Madison & Milwaukee)

The Ruder Group (Matt Ruder)
346 Merchandise Mart, Chicago, IL 60654
matt@therudergroup.com

Tel (312) 222 0161
Fax (312) 222 9839

KANSAS

(S. Illinois, Iowa, Missouri, Nebraska)

Kopmeyer & Associates, Inc. (John and Matt Kopmeyer)
3518 west 92nd St., Leawood, Kansas 66206
jpkope@aol.com; mkopes@hotmail.com

Tel (913) 381 8915

MASSACHUSETTS

(Maine, New Hampshire, Vermont)

Ritz Associates (Kiki Gross)
112 Beach Street, Boston, MA 02111
kiki@ritzinc.com

Tel (617) 439 0800
Fax (617) 439 4466

MICHIGAN

Look Reps (William Keller)
1471 Shadyview Dr. SE, Grand Rapids, MI 49546
williamkeller@gmail.com

Tel (616) 366 2477

MINNESOTA

North Dakota, South Dakota,
Wisconsin (north of Madison &
Milwaukee)

The Ruder Group (Alyssia Magnuson)
8801 N Pelham Parkway, Bayside, WI 53217
alyssia@therudergroup.com

Tel (312) 496 3075
Cell (715) 271 3069

NEW JERSEY

Robin Poole
147 Beechwood Drive, Wayne, NJ 07470
rpadesignlines@gmail.com

Tel (201) 400 2357
Fax (973) 696 9260

NEW YORK

NYC, Manhattan, Brooklyn, Queens
Staten Island, Bronx, Long Island

ICF Group NY (Janie Blum)
320 Fifth Ave. Ste 802, New York, NY 10001
janieb@nienkamper.com

Tel (212) 388 1000
Fax (212) 673 1921

NEW YORK

Upstate

Commercial Design Interiors (Joey Matula / Robin Long)
joey@commercialdesigninteriors.com;
robin@commercialdesigninteriors.com

Tel (518) 522 7072
Tel (518) 496 6883

NORTH CAROLINA

(Raleigh, Durham, Chapel Hill,
Eastern N.C)

Allure Contract (Suzanne Blanke)
4213 Omni Place, Raleigh, NC 27613
suzanne@ac-carolinas.com

Tel (505) 366 4680

REPRESENTATIVES

For updated information on Nienkämper representatives visit our web site at www.nienkämper.com.

OHIO Kentucky, Indiana, Pennsylvania (Pittsburgh)	The Dorsey Group (Connal Dorsey, Mike Hardin) 1491 Polaris Parkway, Ste. 317, Columbus, OH 43240 customerservice@dorseygroup.net	Tel (740) 881 9955 Fax (740) 881 9956
PENNSYLVANIA Eastern PA, Delaware Southern New Jersey (Princeton & South)	Krug Associates (Sue Krug / Ivy Krug) 227 Essick Rd. Pottstown, PA. 19465 sue@krugassoc.com ; ivy@krugassoc.com	Tel (610) 469 9180 Fax (610) 469 9183
SOUTH CAROLINA	Allure Contract (Ashley Joyner) 112 Eston Drive, Goose Creek, SC 29445 ashley@ac-carolinas.com	Tel (804) 400 5443
TEXAS (Dallas) Oklahoma, Arkansas, Northern Louisiana	Robin Martin 610 Copper Ridge, Richardson, TX 75080 robinm@nienkamper.com	Tel (214) 236 7272
TEXAS (Houston) South of Temple, South Louisiana	Stites Gorman Associates (Ryan Stites) 4456 N. Braeswood Blvd., Unit 4040, Houston, TX 77096 ryan@stitesgormanlp.com frances@stitesgormanlp.com	Tel (713) 522 0707 Fax (713) 522 8512
WASHINGTON, DC DC, Maryland, Virginia, West Virginia	PT Sales Inc (Richard Benn) 11828 Coakley Circle, Rockville MD 20852 rbenn@ptsalesinc.com	Tel (301) 468 1331
WASHINGTON Alaska, Idaho, Montana, Oregon	Don & Kymmberly Myrick 8750 Woodbank Dr. N.E., Bainbridge Island, Washington, 98110 donmyrick@dlmyrick.com ; kmyrick@dlmyrick.com	Tel (206) 842 1846 Cell (206) 954 1276

CANADIAN INDEPENDENT REPRESENTATIVES

ALBERTA	Brass Tacks Design Resource Inc. (Carolyn Turner) 568 Auburn Bay Heights SE, Calgary, AB T3M 1L1 carolyn@brasstacksdesign.ca	Tel (587) 888 2128
MANITOBA	HUT K (Nina Quark) 200 Princess Street, Winnipeg, MB R3B 1L2 nina@hutk.ca	Tel (204) 952 8898
BRITISH COLUMBIA	Brook Charles 4921 Angus Drive, Vancouver, BC V6M 3M6 brook@brookcharlesgroup.com	Tel (604) 568 6164
EASTERN CANADA New Brunswick, Nova Scotia, PEI & NFLD	H2 Atlantic Agencies (Chris Holland / Scott Hipson) 250 Brownlow Ave., Suite 18, Dartmouth, NS B3B 1W9 cholland@h2atlantic.com ; shipson@h2atlantic.com	Tel (902) 789 2900 Fax (902) 499 4211
ONTARIO Toronto	Brenda Magnusson & Associates Inc. 300 King St. East, Toronto, ON M5A 1K4 brendam@nienkamper.com	Tel (416) 738 1267
ONTARIO Toronto	Workhive Inc. (Deborah Noble) deborah@nienkamper.com	Tel (647) 292 4456
ONTARIO Ottawa	Lee Anne Cunnington 565 Churchill Avenue, Ottawa, ON K1Z 5E6 laottawa@yahoo.ca	Tel (613) 728 5181
QUEBEC	Julien Cote et Fils (Benoit LaDouceur) 9655 LaSalle Blvd., LaSalle, QC H8R 2N7	Tel (514) 486 2292 Fax (514) 486 3377

INTERNATIONAL INDEPENDENT REPRESENTATIVES & DISTRIBUTORS

ENGLAND	Brands Limited (Ruth Ainger) 99 St. John Street, London, EC1M 4AS England ruth@brands-ltd.com	Tel (44) 20 7017 1670 Fax (44) 20 7017 1671
FRANCE	Agency Cabantous (Frédéric Cabantous) 170 rue Blomet, Paris, France 75015 mobafc@aol.com	Tel (33) 01 4250 4266 Fax (33) 01 4250 4342
MEXICO	PAPSA Torre Comercial Aerica Piso 9 Batallon de San Patricio #111-9 Col. Valle Oriente, San Petro Garza Garcia N.L. Mex direccionmx@papsa.com	Tel (52) 55 1105 3700 Fax (52) 55 5257 0413
	Conceptos Corporativos de Mexico, S.A. de C.V. (Terry Randazzo) Guillermo Gonzalez Camarena 800, P.B. Col. Zedec Santa Fe Mexico, D.F., 01210 Mexico info@conceptoscorporativos.com ; terryrandazzo@conceptoscorporativos.com	Tel (52) 55 5292 1240 Fax (52) 55 5292 1366
MIDDLE EAST	Trans Seas (Ramez Ayoub / Nader Ayoub / Kerry Scott) Prism Tower - Business Bay, 17th Floor, Suite 1709 Dubai, UAE ramez@transseas.com ; nader@transseas.com ; ks@transseas.com	Tel (971) 4 329 5358 Fax (971) 4 329- 5359
HONG KONG	MCV Asia (David Loi) Workshop B1, 3/F, Wing Fung Industrial Building, No. 40-50 Sha Tsui Road, Tsuen Wan, N.T., Hong Kong info@mcvasia.com	Tel (852) 2189 7068 Fax (852) 2189 7065

VENEERS

All wood surfaces are protected with a durable polyurethane clear laquer with UV inhibitor. This finish is known for its exceptional durability, as well as abrasion, chemical, impact and scratch resistance. Standard sheen level is 45 degrees. Optional 10 and 35 degree sheen levels are available on request at no additional cost.

Wood Species	Order Code	Veneer/Stain	Upcharge
Maple	F-01	Natural Maple	No upcharge applies.
	F-02	Natural Curly Maple - Rotary Cut	Add 15%.
	F-03	Natural Bird's Eye Maple - Rotary Cut	Call Customer Service for pricing.
	F-04	Maple Stained Pear	No upcharge applies.
Cherry	F-05	Natural Cherry	No upcharge applies.
	F-06	Standard Cherry	No upcharge applies.
	F-07	Cherry Stained Amber	No upcharge applies.
	F-08	Cherry Stained Auburn	No upcharge applies.
	F-09	Cherry Stained Burgundy	No upcharge applies.
Mahogany	F-10	Light Mahogany	No upcharge applies.
	F-11	Medium Mahogany	No upcharge applies.
	F-12	Dark Mahogany	No upcharge applies.
	F-13	Red Mahogany	No upcharge applies.
Anagre	F-14	Natural Figured Anagre - Qtr. Cut Book-Match	Add 15%.
	F-15	Figured Anagre Stained Amber - Qtr. Cut Book-Match	Add 15%.
Sycamore	F-16	Natural Figured Sycamore - Qtr. Cut Book-Match	Add 15%.
Walnut	F-17	Burnt Walnut	No upcharge applies.
	F-19	Natural Walnut	No upcharge applies.
	F-24	Carbon Grey Walnut	No upcharge applies.
White Oak	F-18	Natural White Oak - Flat Cut Book-Match (10° sheen)	No upcharge applies.
		Natural White Oak - Rift Cut Slip-Match (10° sheen)	Add 5%
Sapele – Ribbon Stripe	F-20	Natural Ribbon Strip Sepele - Qtr. Cut Slip-Match	No upcharge applies.
Moabe (Cherry substitute)	F-21	Natural Moabe - Quarter - Qtr. Cut Book-Match	No upcharge applies.
Cape Coast Walnut	F-22	Dark Cape Coast Walnut - Qtr. Cut Slip-Match	No upcharge applies.
	F-23	Natural Cape Coast Walnut - Qtr. Cut Slip-Match	No upcharge applies.
Ash	F-25	Slate Grey Ash - Qtr. Cut Slip-Match	No upcharge applies.

VENEER GRAIN OPTIONS

Nienkamper products utilize the best quality veneers available, and, combined with Nienkämper's patented veneering systems, create work environments of incredible quality and beauty.

All veneer furniture comes standard with flat cut book-match veneer; flat cut slip-match veneer can also be specified. Quarter cut slip-match and quarter cut book-match veneers are available at a 5% upcharge. Figured Anagre and Figured Sycamore veneers are Quarter cut book-matched. Bird's Eye Maple and Curly Maple are rotary cut.

Facet Edge, Taper edge and Flowform edge tops with veneer are manufactured with a solid wood edge. All edges are then veneer wrapped to create a seamless profile top.

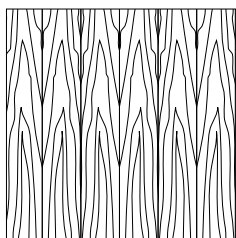

Standard Flat Cut Book-Match V1

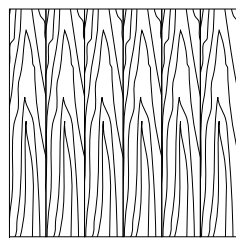

Flat Cut Slip-Match V2

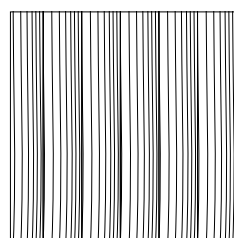

Quarter Cut Slip-Match Add 5% V3

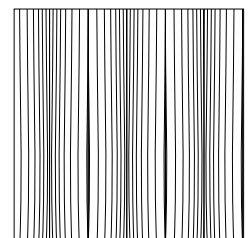

Quarter Cut Book-Match Add 5% V4

P-LAM

Wood grain plastic laminate surfaces are available on table tops with Facet and Taper edges.

These tops are manufactured with a solid wood edge that is applied prior to the laminate top surface. This method conceals the thickness of the wood edge, while providing the durability required. Wood edges are selected that most closely resemble both the species and the color of the laminate chosen

Nienkämper has pre-selected a number of standard wood grain plastic laminates that represent a cross section of both color and species. Simply include the order code with the model number to make these selections. Alternatively wood grain plastic laminates selected outside of Nienkämper's standard selection can be made by specifying the manufacturer as well as the description and model number of the laminate at the time of order. Note: for Facet edge tops the laminate must be a post-forming grade.

Wood Grain Plastic Laminate Surfaces	Order Code	Manufacturer #	Finish
Champagne Sagawood	WL1	Nevamar WM8349T	Textured
Hardrock Maple	WL2	Pionite WM791-SD	Textured/Suede
Amber Curly Maple	WL3	Pionite WM221-SD	Textured/Suede
Anagre	WL4	Pionite WX041-SD	Textured/Suede
Monticello Maple	WL5	Wilsonart 7925-38	Fine Velvet Texture
Millwork Cherry	WL7	Pionite WC431PV	PV-Polished Velvet
Figured Anagre	WL8	Formica7284-58	Matte
Huntington Maple	WL9	Wilsonart 7929-38	Fine Velvet Texture
Wild Cherry	WL10	Formica 5904.43	Artisan
Amber Cherry	WL11	Wilsonart 7919.38	Fine Velvet Texture
Figured Mahogany	WL12	Wilsonart 7040A-60	Matte
Fusion Maple	WL13	Wilsonart 7909-78	Fine Grain
New Age Oak	WL14	Wilsonart 7938-78	Fine Grain
Natural Pear	WL15	Wilsonart 7061-78	Fine Grain
Tuscan Walnut	WL16	Wilsonart 7921-78	Fine Grain
Nepal Teak	WL17	Wilsonart 7209-78	Fine Grain
Wild Cherry	WL18	Wilsonart 7054-78	Fine Grani
River Cherry	WL19	Wilsonart 7937-78	Fine Grain
Montana Walnut	WL20	Wilsonart 7110-78	Fine Grain
Sanara	WL21	Wilsonart 7932-78	Fine Grain
Windsor Mahogany	WL22	Wilsonart 7039-78	Fine Grain
Williamsburg Cherry	WL23	Wilsonart 7936-78	Fine Grain
Florence Walnut	WL25	Wilsonart 7993-78	Fine Grain
Skyline Walnut	WL26	Wilsonart 7964K-12	Soft Grain
Sterling Ash	WL27	Wilsonart 7995-78	Fine Grain

To specify the wood grain laminate required simply add the Order Code WL_ to the model number of the product.

Wood grain laminate samples are available from your local sales representative or by calling Nienkämper's customer service department at 1-800-668-9318.

P-LAM

COLOURED P-LAM

Both Taper and Facet edge profiles are available with a colored laminate top.

Laminate edging on Taper tops. Edging will match the top surface and is applied prior to the surface laminate. By applying the laminate in this way the seam is positioned horizontally, is much less conspicuous as well as more durable.

Wood edging on Facet and Taper Edge tops is applied prior to the laminate. By applying the wood edge in this way the thickness of the wood edge is concealed, while providing the durability required. Wood species and finishes for edging, can be selected from page 4.

For laminates specified outside of Nienkämper's standard selection, specify the manufacturer as well as the description and model number of the laminate selected at time of order. For Facet edge tops, the laminate must be a post forming grade.

Translucent edging on Taper edge tops is applied after the surface laminate. The translucent edge is very durable. Clear translucent edge provides a good match with most white colored laminates, while silver translucent edge provides a metallic look and contrast to colored plastic laminates.



Taper edge in clear translucent with white P-Lam top

Coloured Plastic Laminates Surface	Order Code	Manufacturer #	Finish
Grey (Nienkamper - Light Grey/Putty)	CL-01	Wilsonart 1500-60	Matte
Plantinum Gray (Nienkamper - Medium Grey/Clay)	CL-02	Nevamar S6023T	Textured
Slate Grey (Nienkamper - Dark Grey)	CL-03	Wilsonart D91-60	Matte
Black	CL-04	Wilsonart 1595-60	Matte
Angel White	CL-05	Pionite SW-826SD	Textured/Suede
Frosty White	CL-06	Wilsonart 1573-60	Matte
White (for writable surface)	CL-07	Formica 949-90	Gloss



Add the order code behind the edge profile when specifying.

P-LAM

FINGERPRINT RESISTANCE P-LAM

Fingerprint Resistance Plastic Laminate is an innovative material created for interior design applications and is suitable for both vertical and horizontal interior applications on our nienkamper furniture.

The external surface of Fingerprint Resistance Plastic Laminate involves the use of nanotechnology made possible by next generation acrylic resins.

The unique composition offers extraordinary features coupled with a unique user experience. These include an ultra matt surface (eliminating glare), an ultra sofa feel, an anti-fingerprint surface, thermal healing of micro-scratches, increased durability as well as anti-bacterial and mold-resistant properties.

Edgeband with matching color to the Fingerprint Resistance Plastic Laminate is only available on taper edge. For 1" or 1-1/4" thick top with self edge, same Fingerprint Resistance Plastic Laminate can be specified for the self edge or it can be in clear/silver translucent edge.

There is a 10% upcharge on our standard plastic laminate table pricing for Fingerprint Resistance Plastic Laminate.

Colored "Fingerprint Resistance" Plastic Laminate Surface	Order Code	Finish
Black	RL-01	Matte
Gray	RL-02	Matte
Pure White	RL-03	Matte
Sand	RL-04	Matte
Bronze	RL-05	Matte

Edgeband to Match with Colored "Fingerprint Resistance" Plastic Laminate	Order Code
Black	RE-01
Gray	RE-02
Pure White	RE-03
Sand	RE-04
Bronze	RE-05

VOX® FLIPTOP™ MEETING TABLES

BASE AND STORAGE INFORMATION DESIGN - MARK MÜLLER

Vox FlipTop™ Base Design - This versatile design allows the top of the table to rotate into a vertical position for storage.

Each leg is independently locked at the top of the leg with a small catch. Moving the catch to one side locks or unlocks the base from the top. A small colored mark indicates the catch is in an unlocked position.

Low profile plastic casters are individually locked by depressing with the tip of a foot.

Hollow leg assemblies house gas cylinders that provide a neutral balance to the top. A stabilizer rail runs between the leg assemblies providing both structure and wire management.

Flush Legs - This option (pages 13-20) allows multiple tables to be joined together while maximizing knee space to the users. Seams between tables are never used as work areas.

Inset Legs - This option (pages 21-28) maximizes the number of users allowing seating at the end of tables

Flush Leg Style

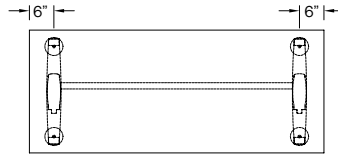

Inset Leg Style

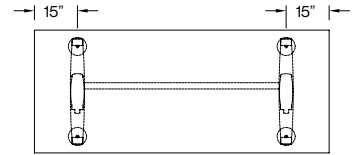

Description

STANDARD VOX FLIPTOP T-BASE

Base Width “

24” Base for 24” deep tops

26” Base for 30” & 36” deep tops

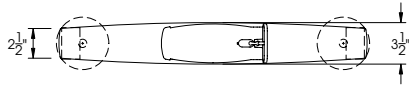

PLAN VIEW

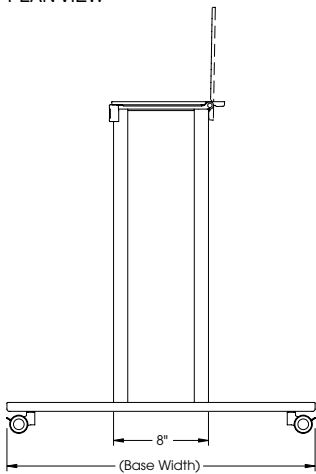

END ELEVATION

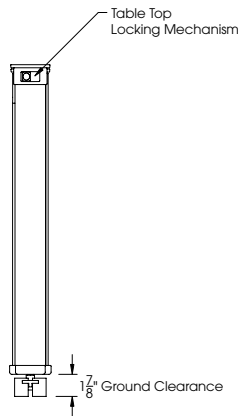

FRONT ELEVATION



Flush leg shown

STORAGE REQUIREMENTS

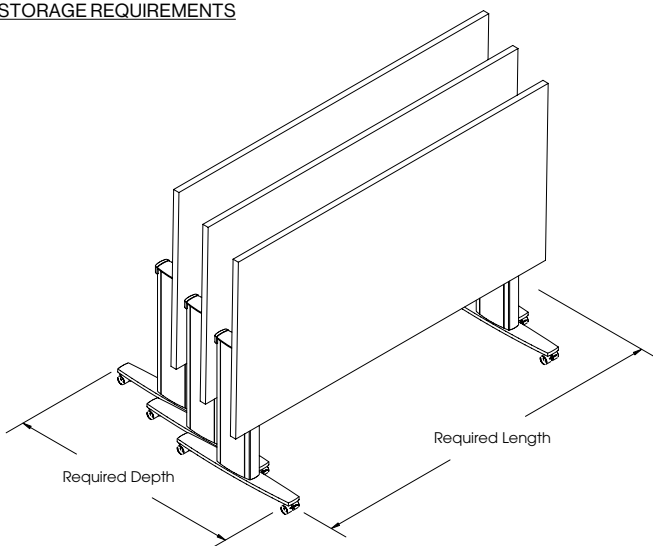

Table Length	Floor Space Required When Nested (L" x D")		
	4 Tables	8 Tables	12 Tables
For 24" to 27" Deep Tops			
60	72x55	87x96	102x137
66	78x55	93x96	108x137
72	84x55	99x96	114x137
78	90x55	105x96	120x137
84	96x55	111x96	126x137
90	102x55	117x96	132x137
For 30" to 36" Deep Tops			
60	72x57	87x98	102x139
66	78x57	93x98	108x139
72	84x57	99x98	114x139
78	90x57	105x98	120x139
84	96x57	111x98	126x139
90	102x57	117x98	132x139

VOX® FLIPTOP™ MODESTY PANELS

PHOTOGRAPHY DESIGN – MARK MÜLLER

Vox® FlipTop tables can be specified with modesty panels. Standard options include veneer to match the top, laminate with translucent edging to match the top, or anodized-aluminum.

A unique flexible hinge joins the modesty panel to the tabletop. When the top is flipped up, the panel aligns with the top and swivels out of the way.



Tables shown with natural cherry veneer and aluminum modesty panels



Table and modesty panel shown in rift cut walnut



Table and modesty panel shown in wood grain laminate WL-1

FORUM INFORMATION

DESIGN – MARK MÜLLER

Vox® FlipTop™ tables can be specified with optional Vox® Forums. Pre-wired “S-Series” Forums as well as “T-Series” Forums are available.

“T-Series” Forums have an added benefit of removing voice/data/power cords directly from the Forum, to be connected when required. This feature also gives the user the option of specifying longer cables when needed.

“S-Series” Forums offer a broad range of pre-wired connections in a slightly larger format than T-Series Forums.

A rail joining the two table legs acts as a stabilizer for the table and along with wire management clips provide a convenient place to store cables.

For complete Vox® Forum™ details refer to the 2007 Vox® Conference™ Price List or simply download the information at: www.nienkamper.com/downloads/Price%20List/US_VoxForums.pdf

FlipTop Tables (1" top thickness)

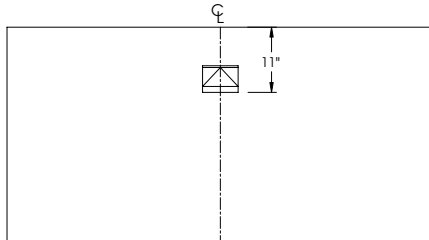

Rectangular Shape

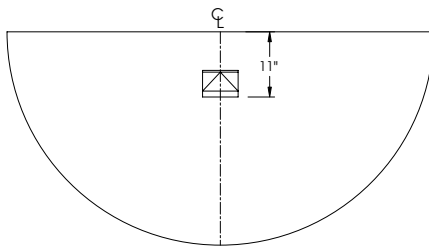

Half-Round Shape

“T” Series Forum

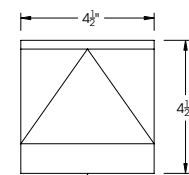

Models TR-A and TR-B

“T” Series Forum

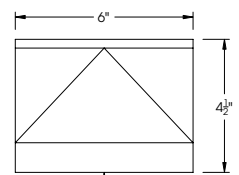

Models TR-C and TR-D

“S” Series Forum

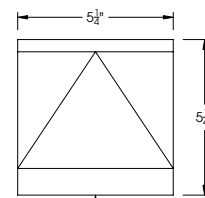

Models A, B, C, G and H

“S” Series Vox® Forums

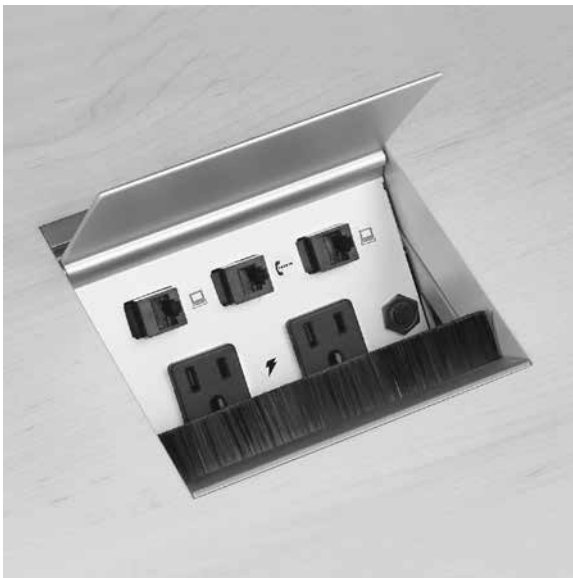

The “S-Series” Forum is available in 2 sizes: 5 1/4” W or 12” W. Fourteen models from A to I with eight data configurations to satisfy most requirements.

“T” Series Vox® Meeting Forums



The “T-Series” Forum is available in 2 sizes 4 1/2” long and 6” long. Power, voice, and data cables can be detached from this Forum for ease of reconfiguring multiple tables or for applying longer cords.

VOX®FLIPTOP™ CABLING

PHOTOGRAPHY DESIGN – MARK MÜLLER



When Vox®FlipTop tables include Vox Forums, cables are routed along the length of the aluminum rail and held in place with plastic wire management clips provided.

This method allows cabling to be located to either side of the table, and connect to the most convenient outlet.

When tables are not in use the same cabling can be easily stowed along the rail with the wire management clips.

Once cables have been located to either leg they can be discretely routed to the floor inside a wire chase that runs up the centre of the interior of each leg. A continuous flexible rubber strip holds the cables in place terminating at the base of the leg with a slot that allows the cables to exit the leg.

VOX®FLIPTOP™ MEETING TABLES

PHOTOGRAPHY DESIGN – MARK MÜLLER



**VOX® FLIPTOP™ MEETING TABLES
WITH FLUSH LEGS**

VOX® FLIPTOP™ MEETING TABLE

FLUSH LEGS

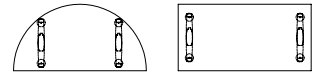

On this page:

Wood veneer tables are standard with a 1/8" solid wood edge that has a slight radius.

P-lam tables are standard with a 1/8" translucent edging that has a slight radius.

Mirror-polished

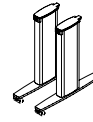

Anodized Finish

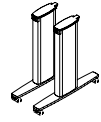

Tops are 1" Thick

	L" x D" x H"	Top Finish	Model Number	2 T-Bases	List Price	Model Number	2 T-Bases	List Price
RECTANGLE TABLES								
<p>"Shown Flipped Down"</p>	60 x 24 x 29	Wood	56101/2	(2-24")	4,745	56111/2	(2-24")	4,245
	60 x 24 x 29	P-Lam	56102/5	(2-24")	4,540	56112/5	(2-24")	4,045
	66 x 24 x 29	Wood	56103/2	(2-24")	4,840	56113/2	(2-24")	4,345
	66 x 24 x 29	P-Lam	56104/5	(2-24")	4,625	56114/5	(2-24")	4,130
	72 x 24 x 29	Wood	56105/2	(2-24")	4,965	56115/2	(2-24")	4,480
	72 x 24 x 29	P-Lam	56106/5	(2-24")	4,725	56116/5	(2-24")	4,235
	78 x 24 x 29	Wood	56107/2	(2-24")	5,060	56117/2	(2-24")	4,570
	78 x 24 x 29	P-Lam	56108/5	(2-24")	4,805	56118/5	(2-24")	4,315
	84 x 24 x 29	Wood	56109/2	(2-24")	5,160	56119/2	(2-24")	4,670
	84 x 24 x 29	P-Lam	56110/5	(2-24")	4,880	56120/5	(2-24")	4,390
<p>"Shown Flipped Up"</p>	90 x 24 x 29	Wood	56180/2	(2-24")	5,265	56182/2	(2-24")	4,760
	90 x 24 x 29	P-Lam	56181/5	(2-24")	4,960	56183/5	(2-24")	4,470
	60 x 30 x 29	Wood	56121/2	(2-26")	5,025	56131/2	(2-26")	4,525
	60 x 30 x 29	P-Lam	56122/5	(2-26")	4,760	56132/5	(2-26")	4,270
	66 x 30 x 29	Wood	56123/2	(2-26")	5,135	56133/2	(2-26")	4,635
	66 x 30 x 29	P-Lam	56124/5	(2-26")	4,860	56134/5	(2-26")	4,355
	72 x 30 x 29	Wood	56125/2	(2-26")	5,295	56135/2	(2-26")	4,800
	72 x 30 x 29	P-Lam	56126/5	(2-26")	5,000	56136/5	(2-26")	4,500
	78 x 30 x 29	Wood	56127/2	(2-26")	5,415	56137/2	(2-26")	4,920
	78 x 30 x 29	P-Lam	56128/5	(2-26")	5,095	56138/5	(2-26")	4,595
84 x 30 x 29	Wood	56129/2	(2-26")	5,515	56139/2	(2-26")	5,020	
84 x 30 x 29	P-Lam	56130/5	(2-26")	5,160	56140/5	(2-26")	4,670	
90 x 30 x 29	Wood	56184/2	(2-26")	5,605	56186/2	(2-26")	5,115	
90 x 30 x 29	P-Lam	56185/5	(2-26")	5,235	56187/5	(2-26")	4,745	
60 x 36 x 29	Wood	56141/2	(2-26")	5,300	56151/2	(2-26")	4,805	
60 x 36 x 29	P-Lam	56142/5	(2-26")	4,985	56152/5	(2-26")	4,495	
66 x 36 x 29	Wood	56143/2	(2-26")	5,425	56153/2	(2-26")	4,935	
66 x 36 x 29	P-Lam	56144/5	(2-26")	5,085	56154/5	(2-26")	4,585	
72 x 36 x 29	Wood	56145/2	(2-26")	5,620	56155/2	(2-26")	5,125	
72 x 36 x 29	P-Lam	56146/5	(2-26")	5,265	56156/5	(2-26")	4,760	
78 x 36 x 29	Wood	56147/2	(2-26")	5,765	56157/2	(2-26")	5,280	
78 x 36 x 29	P-Lam	56148/5	(2-26")	5,375	56158/5	(2-26")	4,880	
84 x 36 x 29	Wood	56149/2	(2-26")	5,865	56159/2	(2-26")	5,365	
84 x 36 x 29	P-Lam	56150/5	(2-26")	5,440	56160/5	(2-26")	4,945	
90 x 36 x 29	Wood	56188/2	(2-26")	5,950	56190/2	(2-26")	5,460	
90 x 36 x 29	P-Lam	56189/5	(2-26")	5,525	56191/5	(2-26")	5,025	
HALF-ROUND TABLES								
<p>"Shown Flipped Down"</p>	30 x 60 x 29	Wood	56161/2	(2-24")	5,025	56171/2	(2-24")	4,525
	30 x 60 x 29	P-Lam	56162/5	(2-24")	4,760	56172/5	(2-24")	4,270
<p>"Shown Flipped Up"</p>	36 x 72 x 29	Wood	56163/2	(2-26")	5,295	56173/2	(2-26")	4,800
	36 x 72 x 29	P-Lam	56164/5	(2-26")	5,000	56174/5	(2-26")	4,500

VOX® FLIPTOP™ MEETING TABLE

FLUSH LEGS WITH WOOD OR P-LAM MODESTY PANEL



On this page:

Wood veneer tables are standard with a 1/8" solid wood edge that has a slight radius and a wood veneer modesty panel that is self edged

P-lam tables are standard with a 1/8" translucent edging that has a slight radius and a plastic laminate modesty panel with translucent edging to match the top

Tops are 1" Thick

Mirror-polished

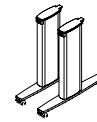

Anodized Finish

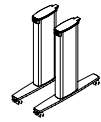

	L"	x	D"	x	H"	Top Finish	Model Number	2 T-Bases	List Price	Model Number	2 T-Bases	List Price
RECTANGLE TABLES	60		24		29	Wood	56101/2P	(2-24")	5,500	56111/2P	(2-24")	5,000
	60		24		29	P-Lam	56102/5P	(2-24")	5,220	56112/5P	(2-24")	4,725
	66		24		29	Wood	56103/2P	(2-24")	5,590	56113/2P	(2-24")	5,100
	66		24		29	P-Lam	56104/5P	(2-24")	5,315	56114/5P	(2-24")	4,825
	72		24		29	Wood	56105/2P	(2-24")	5,730	56115/2P	(2-24")	5,225
	72		24		29	P-Lam	56106/5P	(2-24")	5,425	56116/5P	(2-24")	4,935
	78		24		29	Wood	56107/2P	(2-24")	5,850	56117/2P	(2-24")	5,350
	78		24		29	P-Lam	56108/5P	(2-24")	5,515	56118/5P	(2-24")	5,020
	84		24		29	Wood	56109/2P	(2-24")	5,935	56119/2P	(2-24")	5,450
	84		24		29	P-Lam	56110/5P	(2-24")	5,590	56120/5P	(2-24")	5,100
	90		24		29	Wood	56180/2P	(2-24")	6,060	56182/2P	(2-24")	5,550
	90		24		29	P-Lam	56181/5P	(2-24")	5,685	56183/5P	(2-24")	5,185
	60		30		29	Wood	56121/2P	(2-26")	5,760	56131/2P	(2-26")	5,275
	60		30		29	P-Lam	56122/5P	(2-26")	5,450	56132/5P	(2-26")	4,950
	66		30		29	Wood	56123/2P	(2-26")	5,895	56133/2P	(2-26")	5,385
	66		30		29	P-Lam	56124/5P	(2-26")	5,545	56134/5P	(2-26")	5,050
	72		30		29	Wood	56125/2P	(2-26")	6,065	56135/2P	(2-26")	5,555
	72		30		29	P-Lam	56126/5P	(2-26")	5,700	56136/5P	(2-26")	5,200
	78		30		29	Wood	56127/2P	(2-26")	6,180	56137/2P	(2-26")	5,705
	78		30		29	P-Lam	56128/5P	(2-26")	5,790	56138/5P	(2-26")	5,300
	84		30		29	Wood	56129/2P	(2-26")	6,290	56139/2P	(2-26")	5,790
	84		30		29	P-Lam	56130/5P	(2-26")	5,880	56140/5P	(2-26")	5,375
	90		30		29	Wood	56184/2P	(2-26")	6,410	56186/2P	(2-26")	5,905
	90		30		29	P-Lam	56185/5P	(2-26")	5,950	56187/5P	(2-26")	5,460
	60		36		29	Wood	56141/2P	(2-26")	6,060	56151/2P	(2-26")	5,550
	60		36		29	P-Lam	56142/5P	(2-26")	5,680	56152/5P	(2-26")	5,180
	66		36		29	Wood	56143/2P	(2-26")	6,165	56153/2P	(2-26")	5,690
	66		36		29	P-Lam	56144/5P	(2-26")	5,765	56154/5P	(2-26")	5,280
	72		36		29	Wood	56145/2P	(2-26")	6,370	56155/2P	(2-26")	5,895
	72		36		29	P-Lam	56146/5P	(2-26")	5,950	56156/5P	(2-26")	5,460
	78		36		29	Wood	56147/2P	(2-26")	6,540	56157/2P	(2-26")	6,065
	78		36		29	P-Lam	56148/5P	(2-26")	6,085	56158/5P	(2-26")	5,580
	84		36		29	Wood	56149/2P	(2-26")	6,640	56159/2P	(2-26")	6,140
	84		36		29	P-Lam	56150/5P	(2-26")	6,145	56160/5P	(2-26")	5,665
	90		36		29	Wood	56188/2P	(2-26")	6,740	56190/2P	(2-26")	6,255
	90		36		29	P-Lam	56189/5P	(2-26")	6,245	56191/5P	(2-26")	5,740

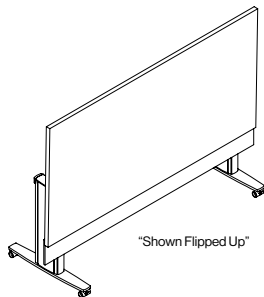
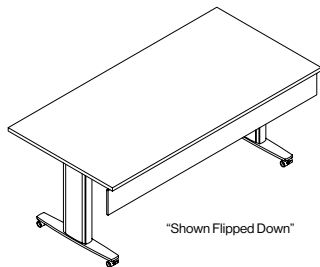

Flat steel swivel latches allow unlimited positioning for ganging Vox FlipTop tables together.

VOX® FLIPTOP™ MEETING TABLE

FLUSH LEGS WITH ALUMINUM MODESTY PANEL



On this page

Wood veneer tables are standard with a 1/8" solid wood edge that has a slight radius and an aluminium modesty panel with grey plastic edging

P-lam tables are standard with a 1/8" translucent edging that has a slight radius and an aluminium modesty panel with grey plastic edging

Tops are 1" Thick

Mirror-polished

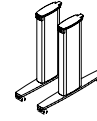

Anodized Finish

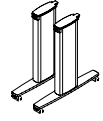

	L"	x	D"	x	H"	Top Finish	Model Number	2 T-Bases	List Price	Model Number	2 T-Bases	List Price
RECTANGLE TABLES	60		24		29	Wood	56101/2AP	(2-24")	5,530	56111/2AP	(2-24")	5,030
	60		24		29	P-Lam	56102/5AP	(2-24")	5,265	56112/5AP	(2-24")	4,760
	66		24		29	Wood	56103/2AP	(2-24")	5,625	56113/2AP	(2-24")	5,135
	66		24		29	P-Lam	56104/5AP	(2-24")	5,355	56114/5AP	(2-24")	4,860
	72		24		29	Wood	56105/2AP	(2-24")	5,755	56115/2AP	(2-24")	5,270
	72		24		29	P-Lam	56106/5AP	(2-24")	5,460	56116/5AP	(2-24")	4,965
	78		24		29	Wood	56107/2AP	(2-24")	5,880	56117/2AP	(2-24")	5,375
	78		24		29	P-Lam	56108/5AP	(2-24")	5,545	56118/5AP	(2-24")	5,050
	84		24		29	Wood	56109/2AP	(2-24")	5,970	56119/2AP	(2-24")	5,480
	84		24		29	P-Lam	56110/5AP	(2-24")	5,625	56120/5AP	(2-24")	5,135
	90		24		29	Wood	56180/2AP	(2-24")	6,085	56182/2AP	(2-24")	5,580
	90		24		29	P-Lam	56181/5AP	(2-24")	5,715	56183/5AP	(2-24")	5,215
	60		30		29	Wood	56121/2AP	(2-26")	5,800	56131/2AP	(2-26")	5,305
	60		30		29	P-Lam	56122/5AP	(2-26")	5,480	56132/5AP	(2-26")	4,985
	66		30		29	Wood	56123/2AP	(2-26")	5,920	56133/2AP	(2-26")	5,425
	66		30		29	P-Lam	56124/5AP	(2-26")	5,575	56134/5AP	(2-26")	5,085
	72		30		29	Wood	56125/2AP	(2-26")	6,090	56135/2AP	(2-26")	5,590
	72		30		29	P-Lam	56126/5AP	(2-26")	5,730	56136/5AP	(2-26")	5,225
	78		30		29	Wood	56127/2AP	(2-26")	6,240	56137/2AP	(2-26")	5,735
	78		30		29	P-Lam	56128/5AP	(2-26")	5,835	56138/5AP	(2-26")	5,340
	84		30		29	Wood	56129/2AP	(2-26")	6,320	56139/2AP	(2-26")	5,835
	84		30		29	P-Lam	56130/5AP	(2-26")	5,910	56140/5AP	(2-26")	5,410
	90		30		29	Wood	56184/2AP	(2-26")	6,435	56186/2AP	(2-26")	5,930
	90		30		29	P-Lam	56185/5AP	(2-26")	5,985	56187/5AP	(2-26")	5,505
	60		36		29	Wood	56141/2AP	(2-26")	6,085	56151/2AP	(2-26")	5,580
	60		36		29	P-Lam	56142/5AP	(2-26")	5,710	56152/5AP	(2-26")	5,210
	66		36		29	Wood	56143/2AP	(2-26")	6,230	56153/2AP	(2-26")	5,720
	66		36		29	P-Lam	56144/5AP	(2-26")	5,810	56154/5AP	(2-26")	5,315
	72		36		29	Wood	56145/2AP	(2-26")	6,425	56155/2AP	(2-26")	5,920
	72		36		29	P-Lam	56146/5AP	(2-26")	5,985	56156/5AP	(2-26")	5,505
	78		36		29	Wood	56147/2AP	(2-26")	6,585	56157/2AP	(2-26")	6,090
	78		36		29	P-Lam	56148/5AP	(2-26")	6,110	56158/5AP	(2-26")	5,620
	84		36		29	Wood	56149/2AP	(2-26")	6,675	56159/2AP	(2-26")	6,165
	84		36		29	P-Lam	56150/5AP	(2-26")	6,170	56160/5AP	(2-26")	5,700
	90		36		29	Wood	56188/2AP	(2-26")	6,785	56190/2AP	(2-26")	6,285
	90		36		29	P-Lam	56189/5AP	(2-26")	6,270	56191/5AP	(2-26")	5,765

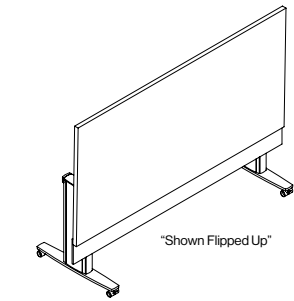
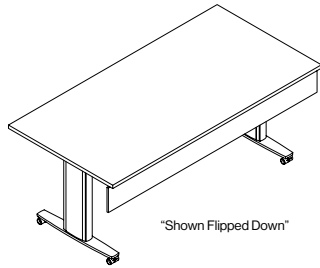

Vox FlipTop tables with aluminum modesty panels.

VOX® MEETING ROOM LAYOUTS

FLUSH LEGS **DRAWINGS NOT TO SCALE**

ROOM1-LAYOUT A1

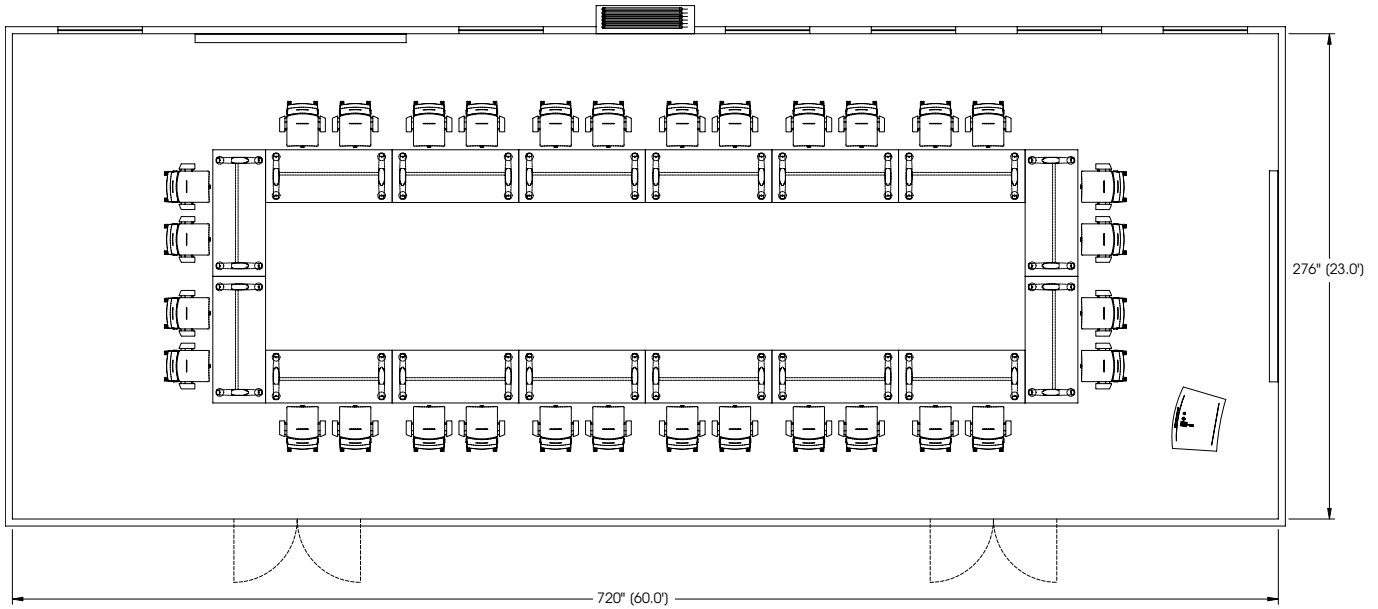

ROOM1-LAYOUT A2

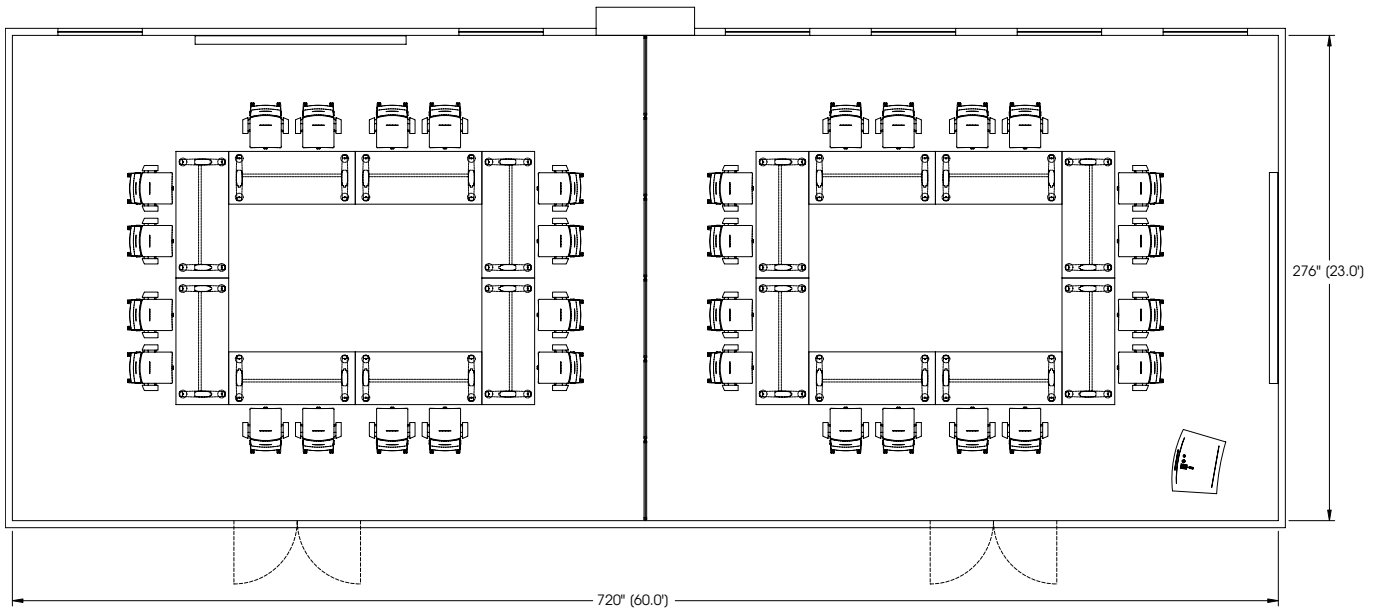

Product Name	Model Number	List Price
16-Vox® FlipTop™ 72" x 30" tables	56135/2	76,725
1-Vox® Presenter's Lectern	23465	9,685
2-120" Vox® Presentation Walls	23494/2	16,810
32-NOW® Conference Chairs, with casters	13022	67,900
Total		171,120

VOX® MEETING ROOM LAYOUTS

FLUSH LEGS DRAWINGS NOT TO SCALE

ROOM1-LAYOUT A3

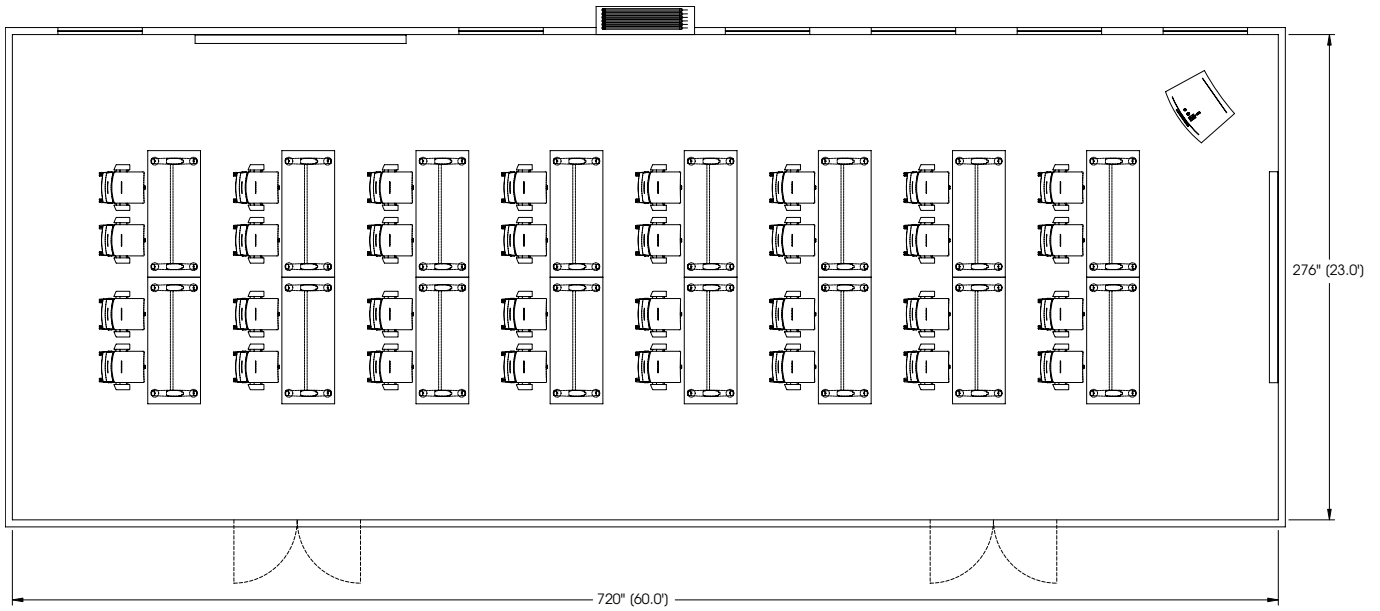

ROOM1-LAYOUT A4

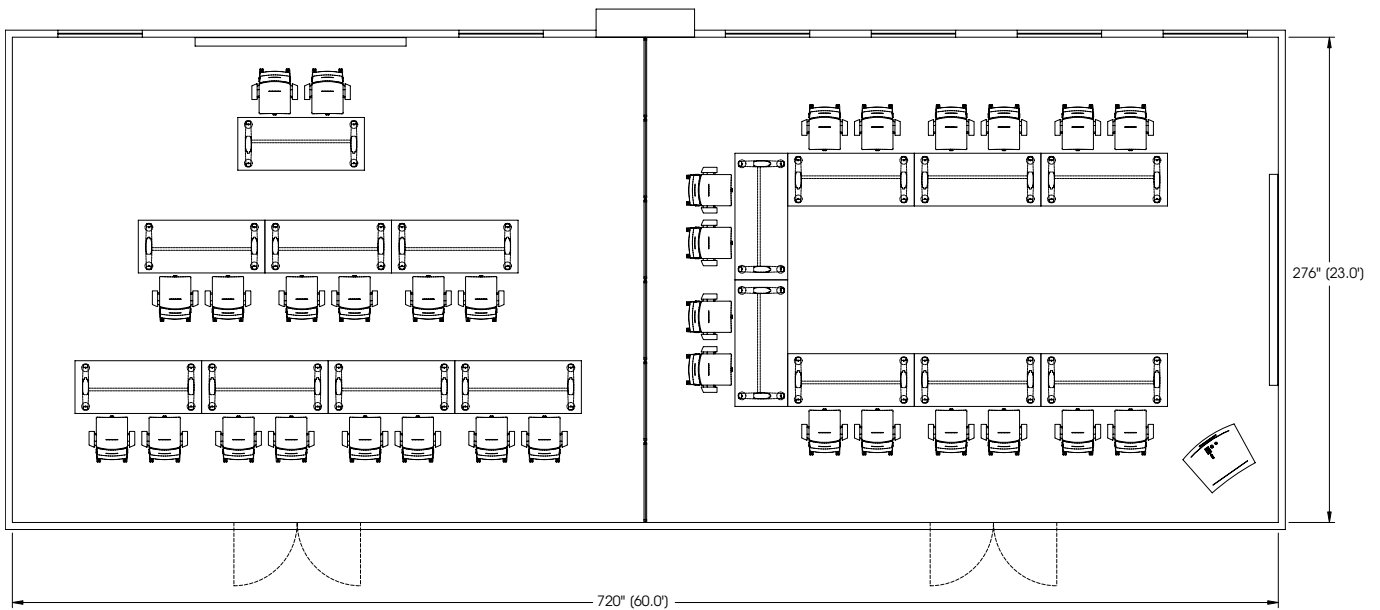

Product Name	Model Number	List Price
16-Vox® FlipTop™ 72" x 30" tables	56135/2	76,725
1-Vox® Presenter's Lectern	23465	9,685
2-120" Vox® Presentation Walls	23494/2	16,810
32-NOW® Conference Chairs, with casters	13022	67,900
Total		171,120

VOX® MEETING ROOM LAYOUTS

FLUSH LEGS **DRAWINGS NOT TO SCALE**

ROOM2 – LAYOUT B1

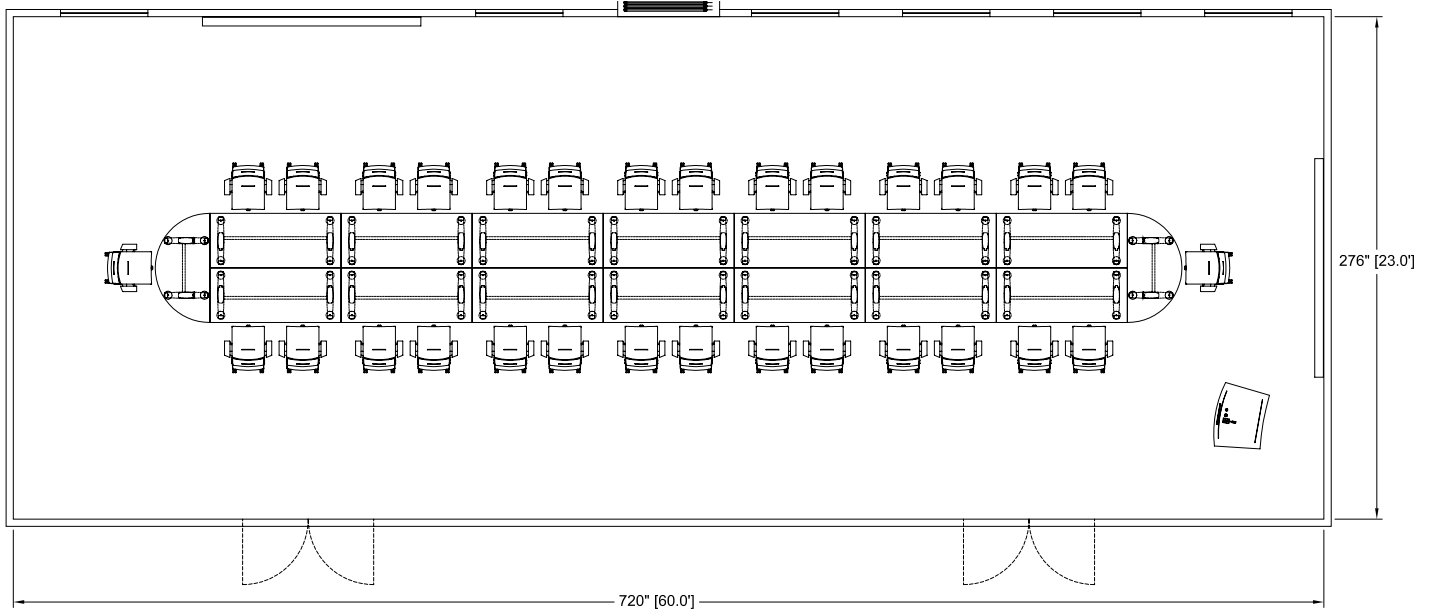

ROOM2 – LAYOUT B2

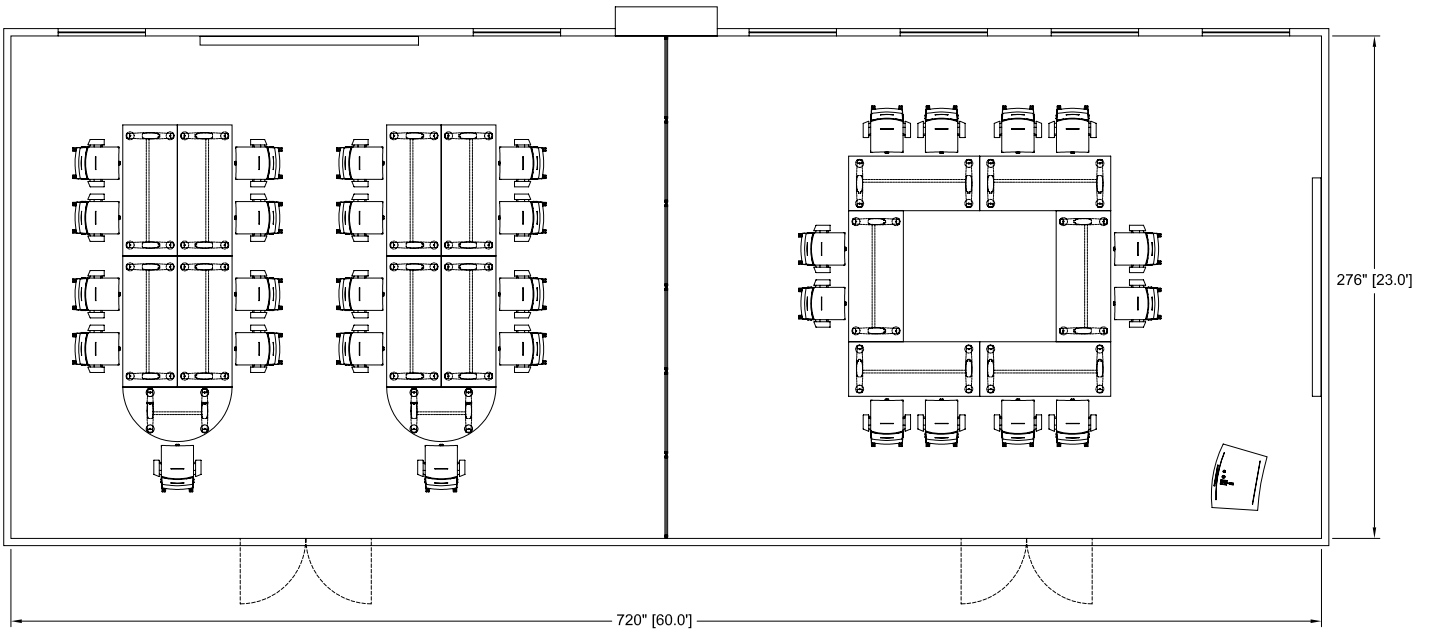

Product Name	Model Number	List Price
14-Vox®FlipTop™ 72" x 30" tables	56135/2	67,140
2-Vox®FlipTop™ Half Round 60" x 30" tables	56171/2	9,045
1-Vox® Presenter's Lectern	23465	9,685
2-120" Vox® Presentation Walls	23494/2	16,810
30-NOW® Conference Chairs, with casters	13022	63,655
Total		166,335

**VOX® FLIPTOP™ MEETING TABLES
WITH INSETLEGS**

PLANNING WITH VOX® FLIPTOP™ TABLES

INSET LEGS VS FLUSH LEGS DESIGN - MARK MÜLLER

Simple and effective tools are available for any space planning required. You can access a full set of PDF and ACAD files for Vox FlipTop tables by following the links below.

Type www.nienkamper.com in your browser

Pick the Vox® tab heading, (top left)

Select the Vox FlipTop™ Table category

Select CAD Drawings tab

Drawings based on seating quantities are listed from 6 to 30 seats and offer a plan view of all options available.

Sample file to seat 10:

IGFgroup

nienkämper

VOX® FLIPTOP™ TABLES

10 SEATS

(BASED ON CHAIR WIDTH OF 26")

KEY: FL-OG-A1
 "FL" = FLUSH / "IN" = INSET
 SEATING QUANTITY
 TABLE DEPTH
 *A"=24" / *B"=30" / *C"=36"
 LAYOUT VERSION (1,2,3...)

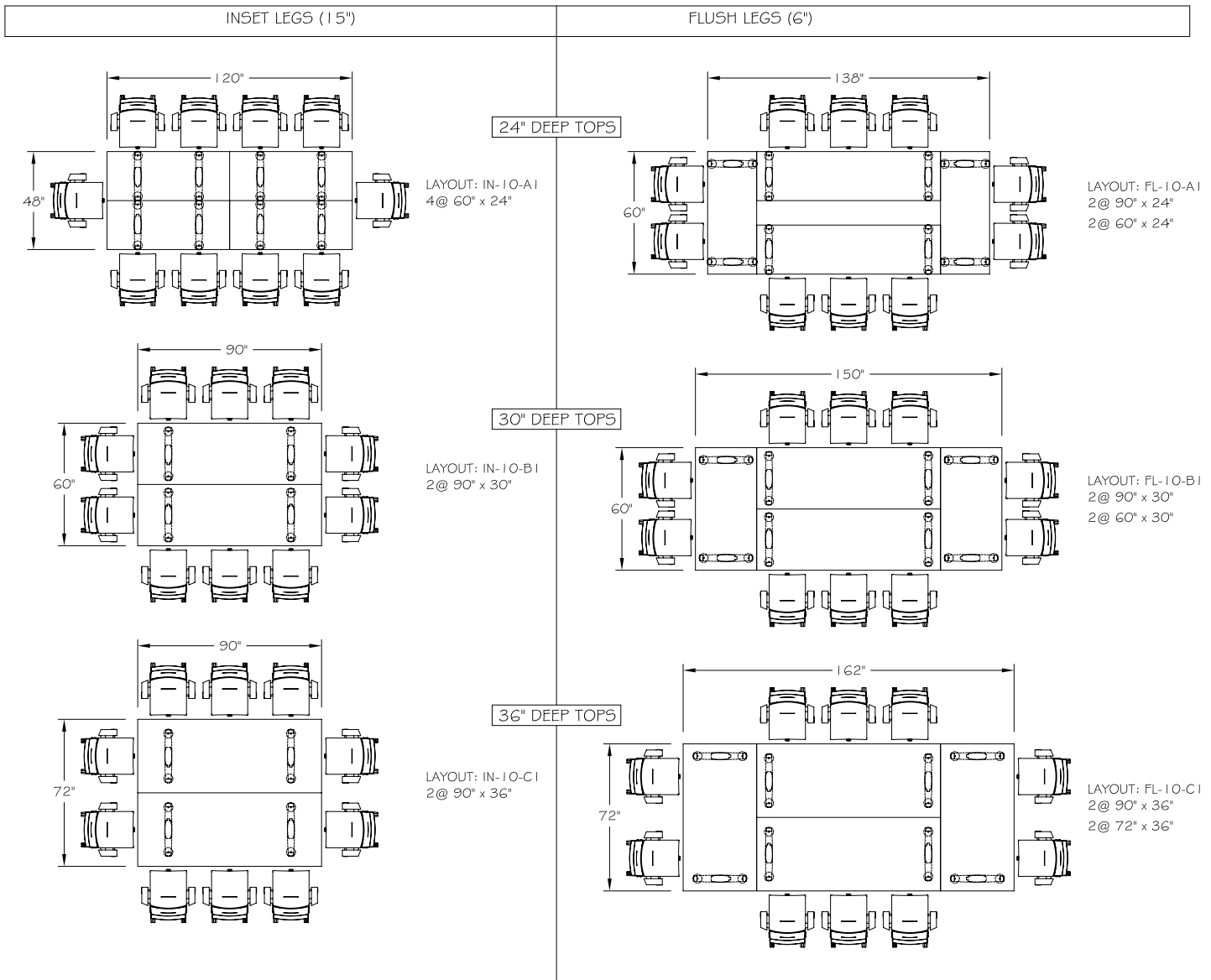

THIS DRAWING IS CONFIDENTIAL AND PROPRIETARY. NO PART OF THIS DRAWING MAY BE COPIED, DISCLOSED TO ANY THIRD PARTY OR USED FOR ANY PURPOSE WITHOUT THE EXPRESS WRITTEN AUTHORIZATION OF NIENKÄMPER FURNITURE & ACCESSORIES

VOX®FLIPTOP™ MEETING TABLE

INSET LEGS DESIGN – MARK MÜLLER

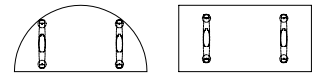

On this page:

Wood veneer tables are standard with a 1/8" solid wood edge that has a slight radius.

P-lam tables are standard with a 1/8" translucent edging that has a slight radius.

Mirror-polished

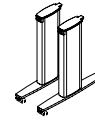

Anodized Finish

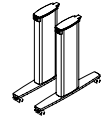

Tops are 1" Thick

	L" x D" x H"	Top Finish	Model Number	2 T-Bases	List Price	Model Number	2 T-Bases	List Price	
RECTANGLE TABLES									
 "Shown Flipped Down"	60 x 24 x 29	Wood	56410/2	(2-24")	4,745	56416/2	(2-24")	4,245	
	60 x 24 x 29	P-Lam	56410/5	(2-24")	4,540	56416/5	(2-24")	4,045	
	66 x 24 x 29	Wood	56411/2	(2-24")	4,840	56417/2	(2-24")	4,345	
	66 x 24 x 29	P-Lam	56411/5	(2-24")	4,625	56417/5	(2-24")	4,130	
	72 x 24 x 29	Wood	56412/2	(2-24")	4,965	56418/2	(2-24")	4,480	
	72 x 24 x 29	P-Lam	56412/5	(2-24")	4,725	56418/5	(2-24")	4,235	
	78 x 24 x 29	Wood	56413/2	(2-24")	5,060	56419/2	(2-24")	4,570	
	78 x 24 x 29	P-Lam	56413/5	(2-24")	4,805	56419/5	(2-24")	4,315	
	84 x 24 x 29	Wood	56414/2	(2-24")	5,160	56420/2	(2-24")	4,670	
	84 x 24 x 29	P-Lam	56414/5	(2-24")	4,880	56420/5	(2-24")	4,390	
 "Shown Flipped Up"	90 x 24 x 29	Wood	56415/2	(2-24")	5,265	56421/2	(2-24")	4,760	
	90 x 24 x 29	P-Lam	56415/5	(2-24")	4,960	56421/5	(2-24")	4,470	
	60 x 30 x 29	Wood	56422/2	(2-26")	5,025	56428/2	(2-26")	4,525	
	60 x 30 x 29	P-Lam	56422/5	(2-26")	4,760	56428/5	(2-26")	4,270	
	66 x 30 x 29	Wood	56423/2	(2-26")	5,135	56429/2	(2-26")	4,635	
	66 x 30 x 29	P-Lam	56423/5	(2-26")	4,860	56429/5	(2-26")	4,355	
	72 x 30 x 29	Wood	56424/2	(2-26")	5,295	56430/2	(2-26")	4,800	
	72 x 30 x 29	P-Lam	56424/5	(2-26")	5,000	56430/5	(2-26")	4,500	
	78 x 30 x 29	Wood	56425/2	(2-26")	5,415	56431/2	(2-26")	4,920	
	78 x 30 x 29	P-Lam	56425/5	(2-26")	5,095	56431/5	(2-26")	4,595	
HALF-ROUND TABLES	84 x 30 x 29	Wood	56426/2	(2-26")	5,515	56432/2	(2-26")	5,020	
	84 x 30 x 29	P-Lam	56426/5	(2-26")	5,160	56432/5	(2-26")	4,670	
	90 x 30 x 29	Wood	56427/2	(2-26")	5,605	56433/2	(2-26")	5,115	
	90 x 30 x 29	P-Lam	56427/5	(2-26")	5,235	56433/5	(2-26")	4,745	
	60 x 36 x 29	Wood	56434/2	(2-26")	5,300	56440/2	(2-26")	4,805	
	60 x 36 x 29	P-Lam	56434/5	(2-26")	4,985	56440/5	(2-26")	4,495	
	66 x 36 x 29	Wood	56435/2	(2-26")	5,425	56441/2	(2-26")	4,935	
	66 x 36 x 29	P-Lam	56435/5	(2-26")	5,085	56441/5	(2-26")	4,585	
	72 x 36 x 29	Wood	56436/2	(2-26")	5,620	56442/2	(2-26")	5,125	
	72 x 36 x 29	P-Lam	56436/5	(2-26")	5,265	56442/5	(2-26")	4,760	
 "Shown Flipped Down"	78 x 36 x 29	Wood	56437/2	(2-26")	5,765	56443/2	(2-26")	5,280	
	78 x 36 x 29	P-Lam	56437/5	(2-26")	5,375	56443/5	(2-26")	4,880	
	84 x 36 x 29	Wood	56438/2	(2-26")	5,865	56444/2	(2-26")	5,365	
	84 x 36 x 29	P-Lam	56438/5	(2-26")	5,440	56444/5	(2-26")	4,945	
	90 x 36 x 29	Wood	56439/2	(2-26")	5,950	56445/2	(2-26")	5,460	
	90 x 36 x 29	P-Lam	56439/5	(2-26")	5,525	56445/5	(2-26")	5,025	
	 "Shown Flipped Up"	30 x 60 x 29	Wood	56161/2	(2-24")	5,025	56171/2	(2-24")	4,525
		30 x 60 x 29	P-Lam	56162/5	(2-24")	4,760	56172/5	(2-24")	4,270
	 "Shown Flipped Up"	36 x 72 x 29	Wood	56163/2	(2-26")	5,160	56173/2	(2-26")	4,670
		36 x 72 x 29	P-Lam	56164/5	(2-26")	4,880	56174/5	(2-26")	4,390

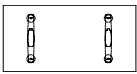

VOX® FLIPTOP™ MEETING TABLE

INSET LEGS WITH WOOD OR P-LAM MODESTY PANEL DESIGN - MARK MÜLLER

On this page:

Wood veneer tables are standard with a 1/8" solid wood edge that has a slight radius and a with wood veneer modesty panel that is self edged

P-lam tables are standard with a 1/8" translucent edging that has a slight radius and a plastic laminate modesty panel with translucent edging to match the top

Tops are 1" Thick

Mirror-polished

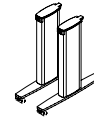

Anodized Finish

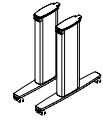

RECTANGLE TABLES		L" x D" x H"	Top Finish	Model Number	2 T-Bases	List Price	Model Number	2 T-Bases	List Price	
<p>"Shown Flipped Down"</p>	60	24	29	Wood	56410/2P	(2-24")	5,500	56416/2P	(2-24")	5,000
	60	24	29	P-Lam	56410/5P	(2-24")	5,220	56416/5P	(2-24")	4,725
	66	24	29	Wood	56411/2P	(2-24")	5,590	56417/2P	(2-24")	5,100
	66	24	29	P-Lam	56411/5P	(2-24")	5,315	56417/5P	(2-24")	4,825
	72	24	29	Wood	56412/2P	(2-24")	5,730	56418/2P	(2-24")	5,225
	72	24	29	P-Lam	56412/5P	(2-24")	5,425	56418/5P	(2-24")	4,935
	78	24	29	Wood	56413/2P	(2-24")	5,850	56419/2P	(2-24")	5,350
	78	24	29	P-Lam	56413/5P	(2-24")	5,515	56419/5P	(2-24")	5,020
	84	24	29	Wood	56414/2P	(2-24")	5,935	56420/2P	(2-24")	5,450
	84	24	29	P-Lam	56414/5P	(2-24")	5,590	56420/5P	(2-24")	5,100
<p>"Shown Flipped Up"</p>	90	24	29	Wood	56415/2P	(2-24")	6,060	56421/2P	(2-24")	5,550
	90	24	29	P-Lam	56415/5P	(2-24")	5,685	56421/5P	(2-24")	5,185
	60	30	29	Wood	56422/2P	(2-26")	5,760	56428/2P	(2-26")	5,275
	60	30	29	P-Lam	56422/5P	(2-26")	5,450	56428/5P	(2-26")	4,950
	66	30	29	Wood	56423/2P	(2-26")	5,895	56429/2P	(2-26")	5,385
	66	30	29	P-Lam	56423/5P	(2-26")	5,545	56429/5P	(2-26")	5,050
	72	30	29	Wood	56424/2P	(2-26")	6,065	56430/2P	(2-26")	5,555
	72	30	29	P-Lam	56424/5P	(2-26")	5,700	56430/5P	(2-26")	5,200
	78	30	29	Wood	56425/2P	(2-26")	6,180	56431/2P	(2-26")	5,705
	78	30	29	P-Lam	56425/5P	(2-26")	5,790	56431/5P	(2-26")	5,300
84	30	29	Wood	56426/2P	(2-26")	6,290	56432/2P	(2-26")	5,790	
84	30	29	P-Lam	56426/5P	(2-26")	5,880	56432/5P	(2-26")	5,375	
90	30	29	Wood	56427/2P	(2-26")	6,410	56433/2P	(2-26")	5,905	
90	30	29	P-Lam	56427/5P	(2-26")	5,950	56433/5P	(2-26")	5,460	
60	36	29	Wood	56434/2P	(2-26")	6,060	56440/2P	(2-26")	5,550	
60	36	29	P-Lam	56434/5P	(2-26")	5,680	56440/5P	(2-26")	5,180	
66	36	29	Wood	56435/2P	(2-26")	6,165	56441/2P	(2-26")	5,690	
66	36	29	P-Lam	56435/5P	(2-26")	5,765	56441/5P	(2-26")	5,280	
72	36	29	Wood	56436/2P	(2-26")	6,370	56442/2P	(2-26")	5,895	
72	36	29	P-Lam	56436/5P	(2-26")	5,950	56442/5P	(2-26")	5,460	
78	36	29	Wood	56437/2P	(2-26")	6,540	56443/2P	(2-26")	6,065	
78	36	29	P-Lam	56437/5P	(2-26")	6,085	56443/5P	(2-26")	5,580	
84	36	29	Wood	56438/2P	(2-26")	6,640	56444/2P	(2-26")	6,140	
84	36	29	P-Lam	56438/5P	(2-26")	6,145	56444/5P	(2-26")	5,665	
90	36	29	Wood	56439/2P	(2-26")	6,740	56445/2P	(2-26")	6,255	
90	36	29	P-Lam	56439/5P	(2-26")	6,245	56445/5P	(2-26")	5,740	

VOX® FLIPTOP™ MEETING TABLE

INSET LEGS WITH ALUMINUM MODESTY PANEL DESIGN – MARK MÜLLER

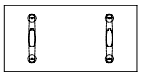

On this page

Wood veneer tables are standard with a 1/8" solid wood edge that has a slight radius and an aluminium modesty panel with grey plastic edging

P-lam tables are standard with a 1/8" translucent edging that has a slight radius and an aluminium modesty panel with grey plastic edging

Tops are 1" Thick

Mirror-polished

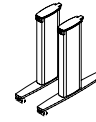

Anodized Finish

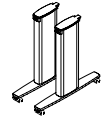

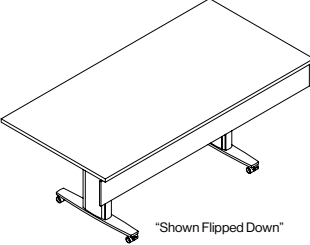
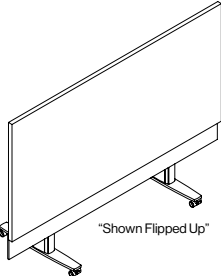
	L"	x	D"	x	H"	Top Finish	Model Number	2 T-Bases	List Price	Model Number	2 T-Bases	List Price
RECTANGLE TABLES	60	24	29	Wood	56410/2AP	(2-24")	5,530	56416/2AP	(2-24")	5,030		
	60	24	29	P-Lam	56410/5AP	(2-24")	5,265	56416/5AP	(2-24")	4,760		
 "Shown Flipped Down"	66	24	29	Wood	56411/2AP	(2-24")	5,625	56417/2AP	(2-24")	5,135		
	66	24	29	P-Lam	56411/5AP	(2-24")	5,355	56417/5AP	(2-24")	4,860		
 "Shown Flipped Up"	72	24	29	Wood	56412/2AP	(2-24")	5,755	56418/2AP	(2-24")	5,270		
	72	24	29	P-Lam	56412/5AP	(2-24")	5,460	56418/5AP	(2-24")	4,965		
	78	24	29	Wood	56413/2AP	(2-24")	5,880	56419/2AP	(2-24")	5,375		
	78	24	29	P-Lam	56413/5AP	(2-24")	5,545	56419/5AP	(2-24")	5,050		
	84	24	29	Wood	56414/2AP	(2-24")	5,970	56420/2AP	(2-24")	5,480		
	84	24	29	P-Lam	56414/5AP	(2-24")	5,625	56420/5AP	(2-24")	5,135		
	90	24	29	Wood	56415/2AP	(2-24")	6,085	56421/2AP	(2-24")	5,580		
	90	24	29	P-Lam	56415/5AP	(2-24")	5,715	56421/5AP	(2-24")	5,215		
	60	30	29	Wood	56422/2AP	(2-26")	5,800	56428/2AP	(2-26")	5,305		
	60	30	29	P-Lam	56422/5AP	(2-26")	5,480	56428/5AP	(2-26")	4,985		
	66	30	29	Wood	56423/2AP	(2-26")	5,920	56429/2AP	(2-26")	5,425		
	66	30	29	P-Lam	56423/5AP	(2-26")	5,575	56429/5AP	(2-26")	5,085		
	72	30	29	Wood	56424/2AP	(2-26")	6,090	56430/2AP	(2-26")	5,590		
	72	30	29	P-Lam	56424/5AP	(2-26")	5,730	56430/5AP	(2-26")	5,225		
	78	30	29	Wood	56425/2AP	(2-26")	6,240	56431/2AP	(2-26")	5,735		
	78	30	29	P-Lam	56425/5AP	(2-26")	5,835	56431/5AP	(2-26")	5,340		
	84	30	29	Wood	56426/2AP	(2-26")	6,320	56432/2AP	(2-26")	5,835		
	84	30	29	P-Lam	56426/5AP	(2-26")	5,910	56432/5AP	(2-26")	5,410		
	90	30	29	Wood	56427/2AP	(2-26")	6,435	56433/2AP	(2-26")	5,930		
	90	30	29	P-Lam	56427/5AP	(2-26")	5,985	56433/5AP	(2-26")	5,505		
	60	36	29	Wood	56434/2AP	(2-26")	6,085	56440/2AP	(2-26")	5,580		
	60	36	29	P-Lam	56434/5AP	(2-26")	5,710	56440/5AP	(2-26")	5,210		
	66	36	29	Wood	56435/2AP	(2-26")	6,230	56441/2AP	(2-26")	5,720		
	66	36	29	P-Lam	56435/5AP	(2-26")	5,810	56441/5AP	(2-26")	5,315		
	72	36	29	Wood	56436/2AP	(2-26")	6,425	56442/2AP	(2-26")	5,920		
	72	36	29	P-Lam	56436/5AP	(2-26")	5,985	56442/5AP	(2-26")	5,505		
	78	36	29	Wood	56437/2AP	(2-26")	6,585	56443/2AP	(2-26")	6,090		
	78	36	29	P-Lam	56437/5AP	(2-26")	6,110	56443/5AP	(2-26")	5,620		
	84	36	29	Wood	56438/2AP	(2-26")	6,675	56444/2AP	(2-26")	6,165		
	84	36	29	P-Lam	56438/5AP	(2-26")	6,170	56444/5AP	(2-26")	5,700		
	90	36	29	Wood	56439/2AP	(2-26")	6,785	56445/2AP	(2-26")	6,285		
	90	36	29	P-Lam	56439/5AP	(2-26")	6,270	56445/5AP	(2-26")	5,765		

VOX® MEETING ROOM LAYOUTS

INSET LEGS DRAWINGS NOT TO SCALE

ROOM1-LAYOUT C1

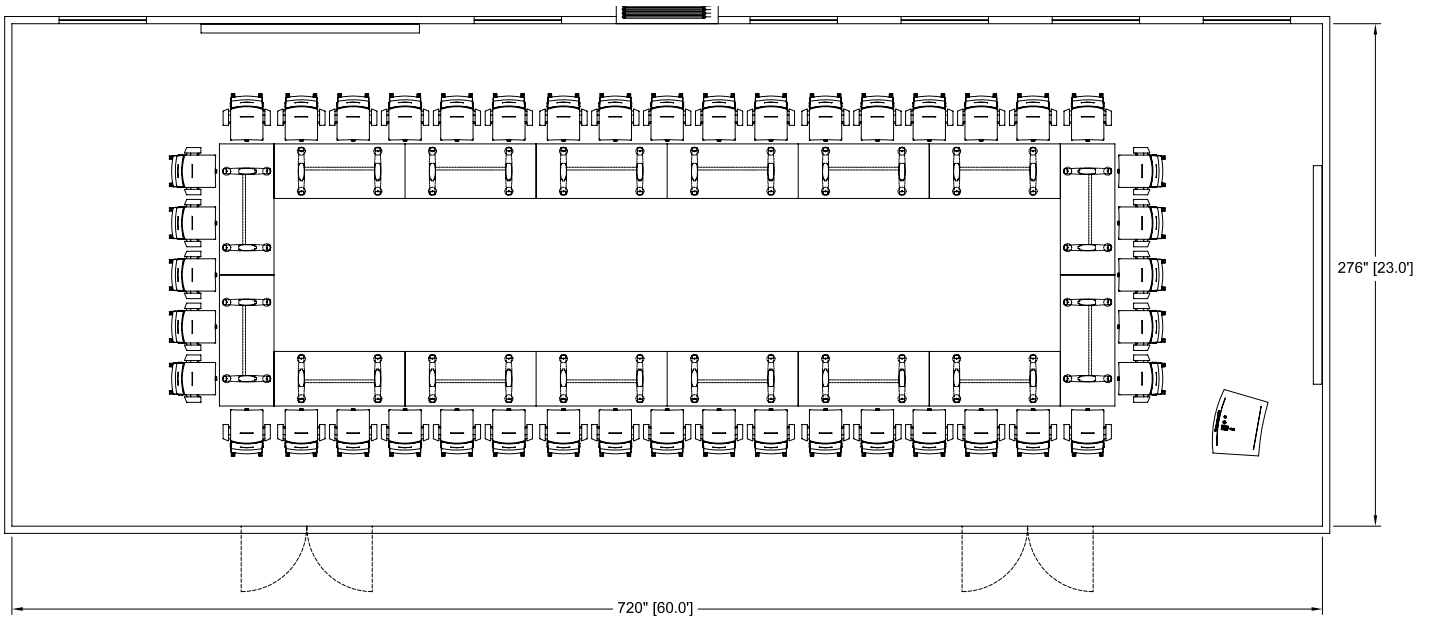

ROOM1-LAYOUT C2

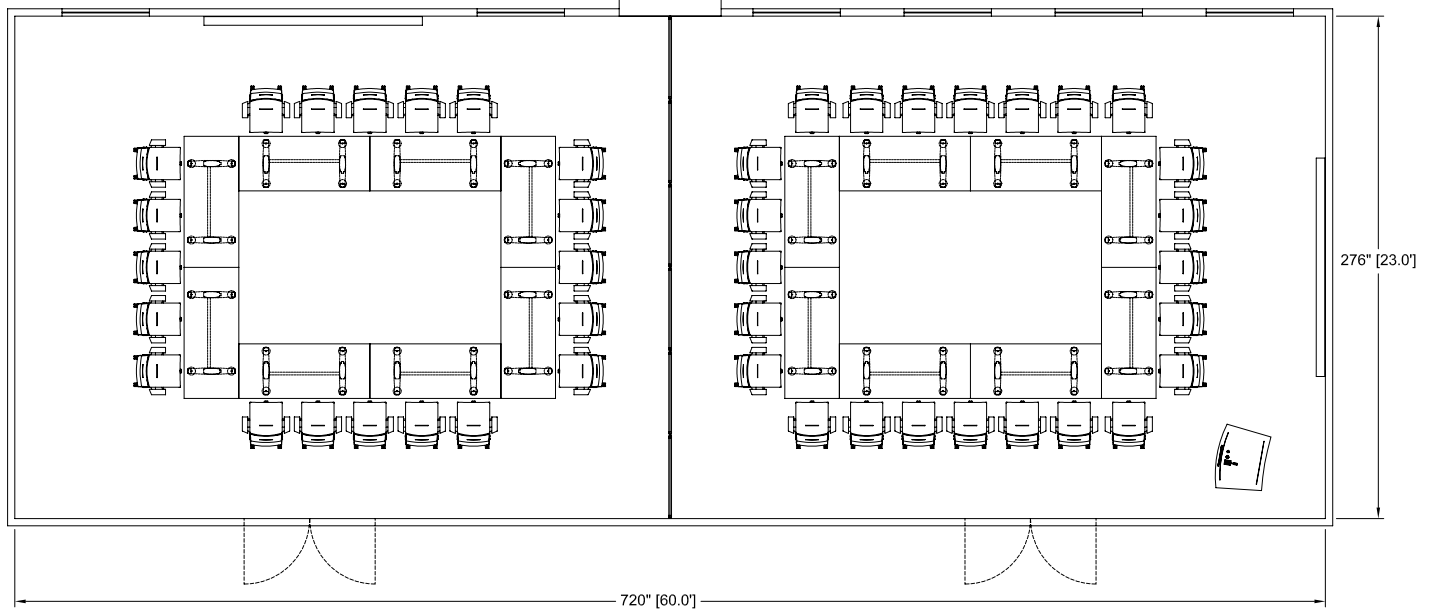

Product Name	Model Number	List Price
16-Vox® FlipTop™ 72" x 30" tables	56430/2	76,725
1-Vox® Presenter's Lectern	23465	9,685
2-120" Vox® Presentation Walls	23494/2	16,810
44-NOW® Conference Chairs, with casters	13022	93,360
Total		196,580

VOX® MEETING ROOM LAYOUTS

INSET LEGS DRAWINGS NOT TO SCALE

ROOM1-LAYOUT C3

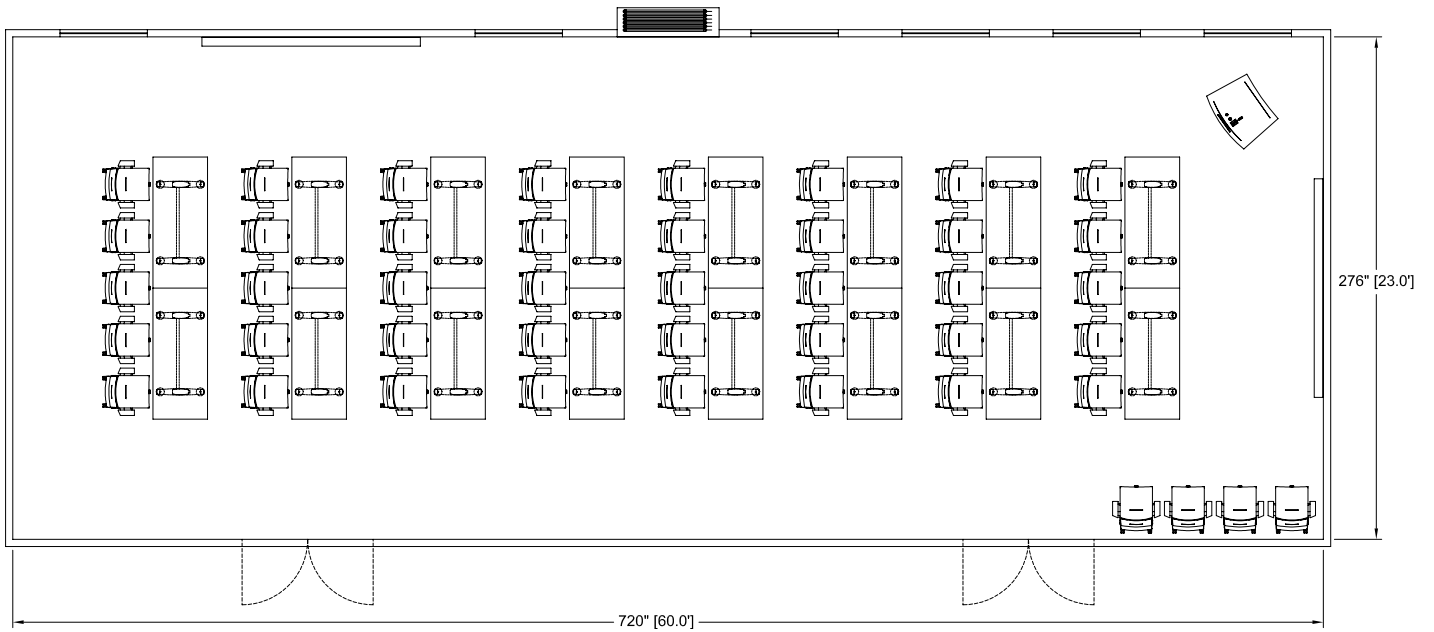

ROOM1-LAYOUT C4

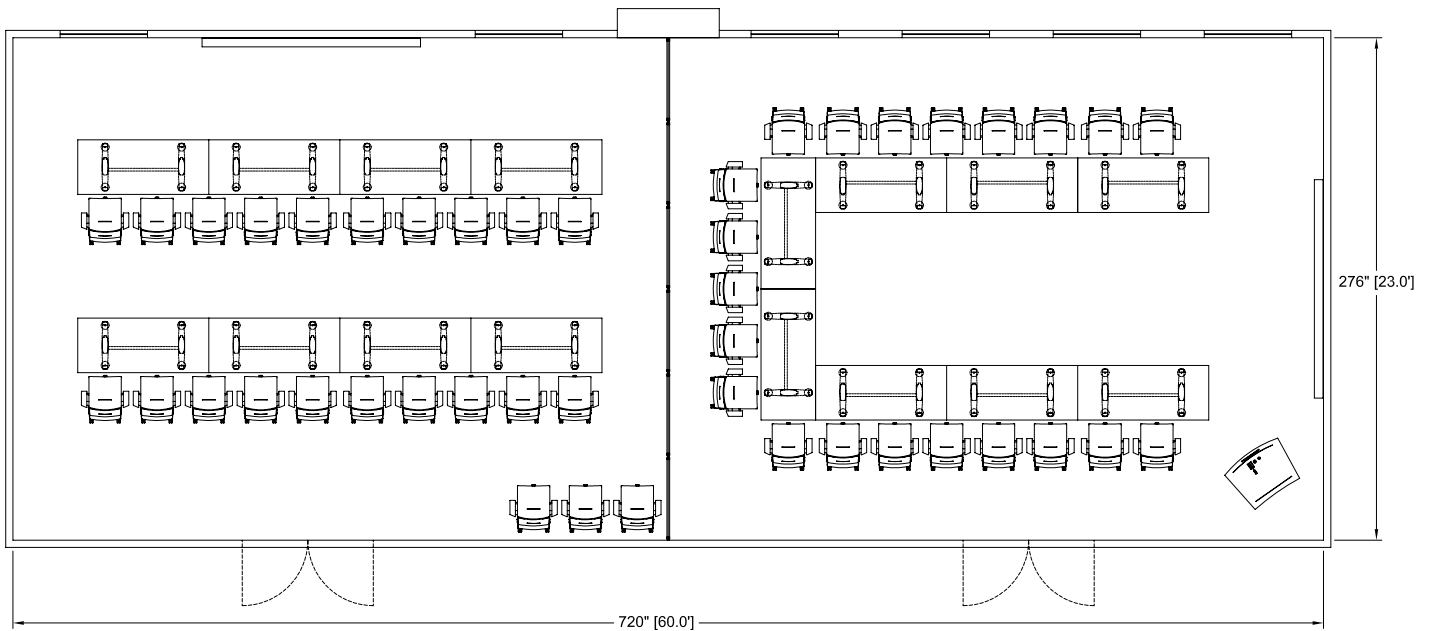

Product Name	Model Number	List Price
16-Vox® FlipTop™ 72" x 30" tables	56430/2	76,725
1-Vox® Presenter's Lectern	23465	9,685
2-120" Vox® Presentation Walls	23494/2	16,810
44-NOW® Conference Chairs, with casters	13022	93,360
Total		196,580

VOX® MEETING ROOM LAYOUTS

INSET LEGS DRAWINGS NOT TO SCALE

ROOM2-LAYOUT D1

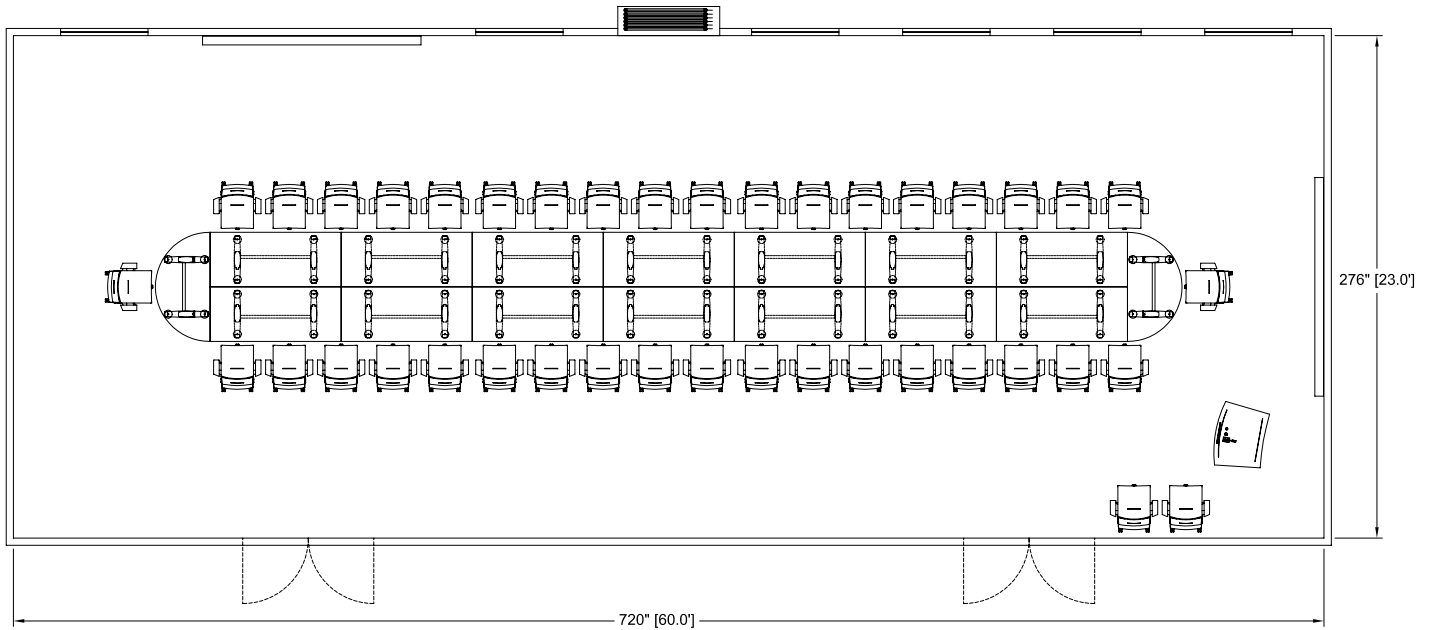

ROOM2-LAYOUT D2

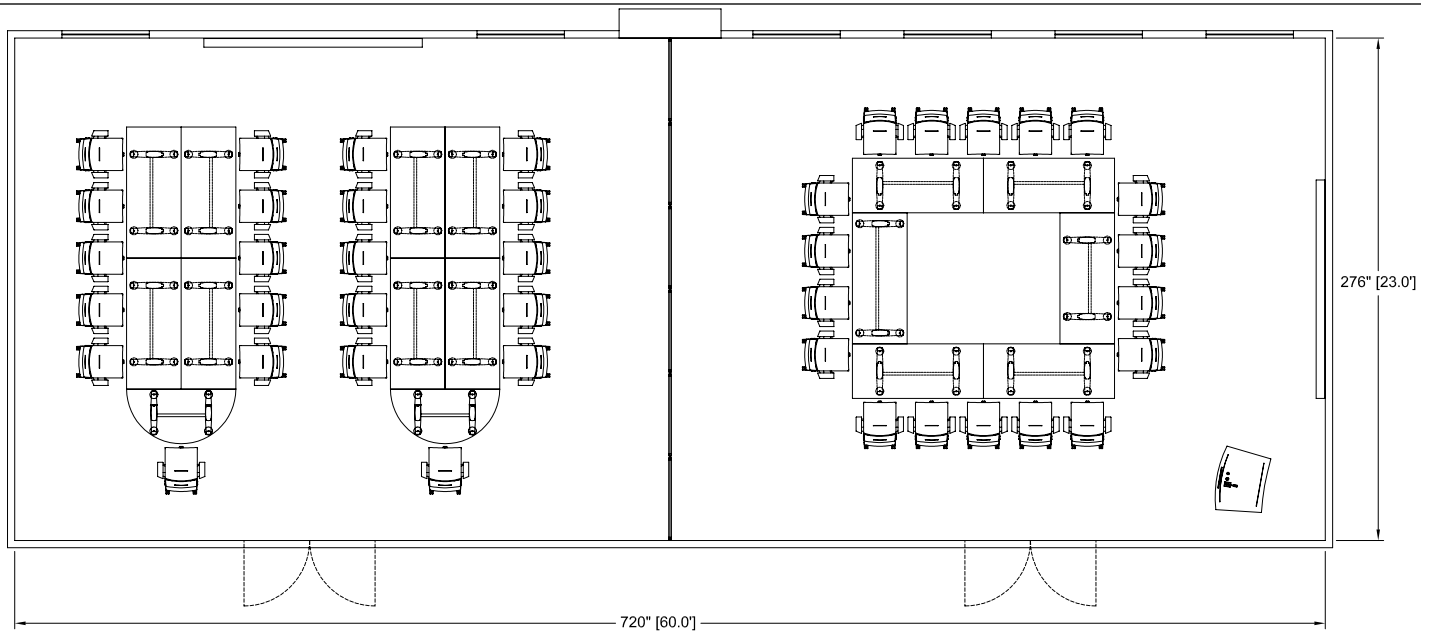

Product Name	Model Number	List Price
14-Vox® FlipTop™ 72" x 30" tables	56430/2	67,140
2-Vox® FlipTop™ Half Round 60" x 30" tables	56171/2	9,045
1-Vox® Presenter's Lectern	23465	9,685
2-120" Vox® Presentation Walls	23494/2	16,810
40-NOW® Conference Chairs, with casters	13022	84,875
Total		120,415

VOX[®] FLIPTOP[™] CONFERENCE TABLES

VOX®FLIPTOP™ CONFERENCE TABLES

EDGE DETAILS DESIGN - MARK MÜLLER

All Vox®FlipTop™ conference tables are available with three edge profiles on user side, to select:

Facet Edge add "FC" after the table model number

Taper Edge add "TE" after the table model number

Flowform Edge add "FF" after the table model number

Flowform Edge is a 5% upcharge

Flowform tops are not available with plastic laminate

- All other edges of the top are Self Edged.
- All Vox®FlipTop™ conference table tops are 1/4" thick, edges are manufactured with a solid wood edge that is profiled and then veneer wrapped.

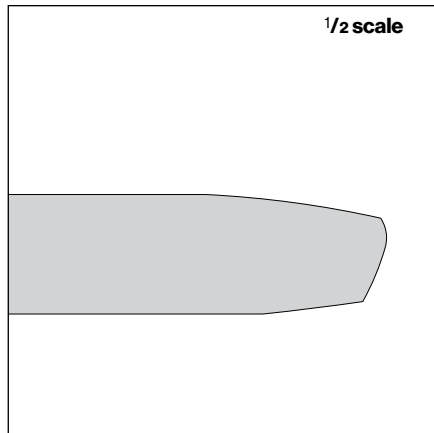
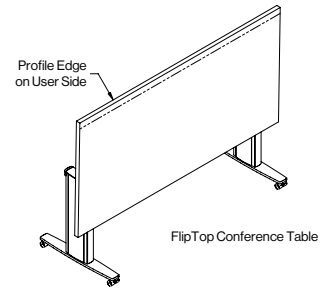

Facet Edge "FC"

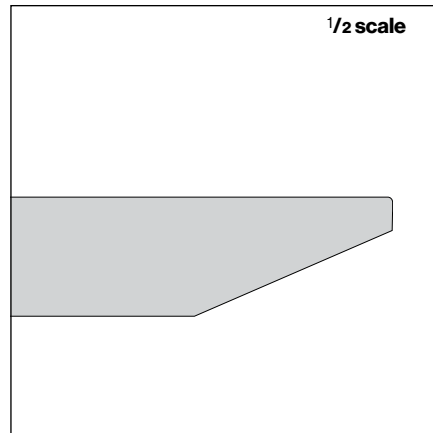

Taper Edge "TE"

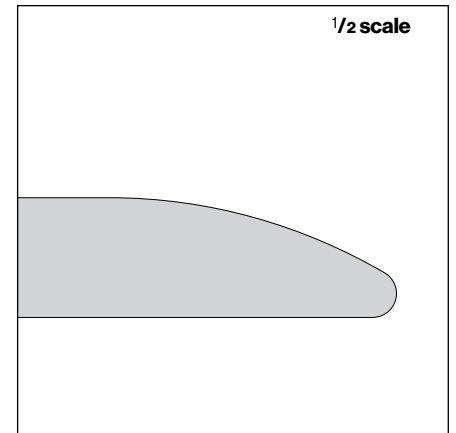

Flowform Edge "FF"

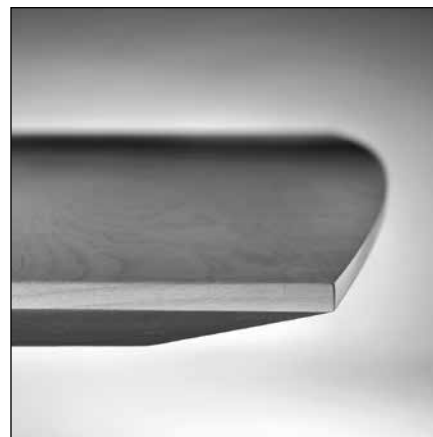

Vox® Infil FlipTop™ tables can be specified with Pre-wired "S-Series" Forums in a range of configurations. A rail joining the two table legs acts as a stabilizer for the table and along with wire management clips provide a convenient place to store cables. For complete Vox®Forum™ details refer to the 2007 Vox®Conference™ Price List or simply download the information at: www.nienkamper.com/downloads/Price%20List/US_VoxForums.pdf

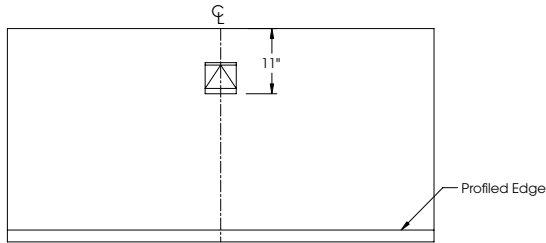

Rectangular Shape

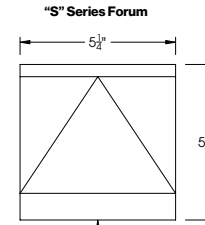

Models A,B,C,G and H

"S" Series Vox® Forums

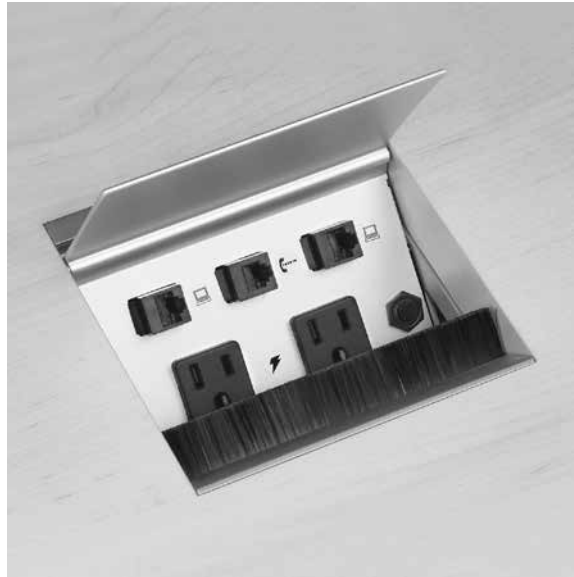

The "S-Series"Forum is available in 2 sizes: 5 1/4" W or 12" W. Fourteen models from A to I with eight data configurations to satisfy most requirements.

VOX® INFILL FLIPTOP™ TABLES

USED WITH CONFERENCE TABLES (PGS 34 – 35) DESIGN – MARK MÜLLER



Specify edge type; add the two letter code after the model number.



Facet Edge "FC"
on user side only



Taper Edge "TE"
on user side only



Flowform Edge "FF"
on user side only
5% upcharge
laminate not available

Mirror-polished

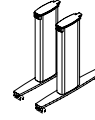

Anodized Finish

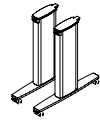

Tops are 1 1/4" Thick

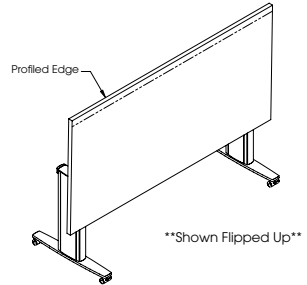
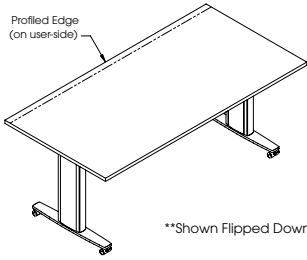

	L" x D" x H"	Top Finish	Model Number	2 T-Bases	List Price	Model Number	2 T-Bases	List Price
	60 x 24 x 28 1/2	Wood	56201/2	(2-24")	4,745	56211/2	(2-24")	4,245
	60 x 24 x 28 1/2	P-Lam	56202/5	(2-24")	4,540	56212/5	(2-24")	4,045
	66 x 24 x 28 1/2	Wood	56203/2	(2-24")	4,840	56213/2	(2-24")	4,345
	66 x 24 x 28 1/2	P-Lam	56204/5	(2-24")	4,625	56214/5	(2-24")	4,130
	72 x 24 x 28 1/2	Wood	56205/2	(2-24")	4,965	56215/2	(2-24")	4,480
	72 x 24 x 28 1/2	P-Lam	56206/5	(2-24")	4,725	56216/5	(2-24")	4,235
	78 x 24 x 28 1/2	Wood	56207/2	(2-24")	5,060	56217/2	(2-24")	4,570
	78 x 24 x 28 1/2	P-Lam	56208/5	(2-24")	4,805	56218/5	(2-24")	4,315
	84 x 24 x 28 1/2	Wood	56209/2	(2-24")	5,160	56219/2	(2-24")	4,670
	84 x 24 x 28 1/2	P-Lam	56210/5	(2-24")	4,880	56220/5	(2-24")	4,390
	60 x 27 x 28 1/2	Wood	56221/2	(2-24")	4,880	56231/2	(2-24")	4,390
	60 x 27 x 28 1/2	P-Lam	56222/5	(2-24")	4,660	56232/5	(2-24")	4,160
	66 x 27 x 28 1/2	Wood	56223/2	(2-24")	4,985	56233/2	(2-24")	4,495
	66 x 27 x 28 1/2	P-Lam	56224/5	(2-24")	4,735	56234/5	(2-24")	4,240
	72 x 27 x 28 1/2	Wood	56225/2	(2-24")	5,125	56235/2	(2-24")	4,630
	72 x 27 x 28 1/2	P-Lam	56226/5	(2-24")	4,865	56236/5	(2-24")	4,360
	78 x 27 x 28 1/2	Wood	56227/2	(2-24")	5,235	56237/2	(2-24")	4,745
	78 x 27 x 28 1/2	P-Lam	56228/5	(2-24")	4,945	56238/5	(2-24")	4,445
	84 x 27 x 28 1/2	Wood	56229/2	(2-24")	5,340	56239/2	(2-24")	4,840
	84 x 27 x 28 1/2	P-Lam	56230/5	(2-24")	5,025	56240/5	(2-24")	4,525
	60 x 30 x 28 1/2	Wood	56241/2	(2-26")	5,025	56251/2	(2-26")	4,525
	60 x 30 x 28 1/2	P-Lam	56242/5	(2-26")	4,760	56252/5	(2-26")	4,270
	66 x 30 x 28 1/2	Wood	56243/2	(2-26")	5,135	56253/2	(2-26")	4,635
	66 x 30 x 28 1/2	P-Lam	56244/5	(2-26")	4,860	56254/5	(2-26")	4,355
	72 x 30 x 28 1/2	Wood	56245/2	(2-26")	5,295	56255/2	(2-26")	4,800
	72 x 30 x 28 1/2	P-Lam	56246/5	(2-26")	5,000	56256/5	(2-26")	4,500
	78 x 30 x 28 1/2	Wood	56247/2	(2-26")	5,415	56257/2	(2-26")	4,920
	78 x 30 x 28 1/2	P-Lam	56248/5	(2-26")	5,095	56258/5	(2-26")	4,595
	84 x 30 x 28 1/2	Wood	56249/2	(2-26")	5,515	56259/2	(2-26")	5,020
	84 x 30 x 28 1/2	P-Lam	56250/5	(2-26")	5,160	56260/5	(2-26")	4,670
	60 x 33 x 28 1/2	Wood	56261/2	(2-26")	5,160	56271/2	(2-26")	4,670
	60 x 33 x 28 1/2	P-Lam	56262/5	(2-26")	4,875	56272/5	(2-26")	4,375
	66 x 33 x 28 1/2	Wood	56263/2	(2-26")	5,280	56273/2	(2-26")	4,785
	66 x 33 x 28 1/2	P-Lam	56264/5	(2-26")	4,965	56274/5	(2-26")	4,480
	72 x 33 x 28 1/2	Wood	56265/2	(2-26")	5,455	56275/2	(2-26")	4,960
	72 x 33 x 28 1/2	P-Lam	56266/5	(2-26")	5,125	56276/5	(2-26")	4,630
	78 x 33 x 28 1/2	Wood	56267/2	(2-26")	5,590	56277/2	(2-26")	5,100
	78 x 33 x 28 1/2	P-Lam	56268/5	(2-26")	5,225	56278/5	(2-26")	4,735
	84 x 33 x 28 1/2	Wood	56269/2	(2-26")	5,690	56279/2	(2-26")	5,195
	84 x 33 x 28 1/2	P-Lam	56270/5	(2-26")	5,300	56280/5	(2-26")	4,805
	60 x 36 x 28 1/2	Wood	56281/2	(2-26")	5,300	56291/2	(2-26")	4,805
	60 x 36 x 28 1/2	P-Lam	56282/5	(2-26")	4,985	56292/5	(2-26")	4,495
	66 x 36 x 28 1/2	Wood	56283/2	(2-26")	5,425	56293/2	(2-26")	4,935
	66 x 36 x 28 1/2	P-Lam	56284/5	(2-26")	5,085	56294/5	(2-26")	4,585
	72 x 36 x 28 1/2	Wood	56285/2	(2-26")	5,620	56295/2	(2-26")	5,125
	72 x 36 x 28 1/2	P-Lam	56286/5	(2-26")	5,265	56296/5	(2-26")	4,760
	78 x 36 x 28 1/2	Wood	56287/2	(2-26")	5,765	56297/2	(2-26")	5,280
	78 x 36 x 28 1/2	P-Lam	56288/5	(2-26")	5,375	56298/5	(2-26")	4,880
	84 x 36 x 28 1/2	Wood	56289/2	(2-26")	5,865	56299/2	(2-26")	5,365
	84 x 36 x 28 1/2	P-Lam	56290/5	(2-26")	5,440	56300/5	(2-26")	4,945

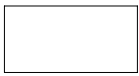

VOX® CONFERENCE TABLES

USED WITH INFILL FLIPTOP™ TABLES (PGS 33) DESIGN - MARK MÜLLER

Specify edge type; add the two letter code after the model number.

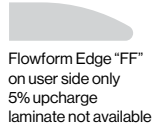
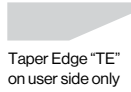
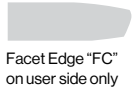

Mirror-polished

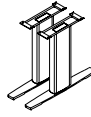

Anodized Finish

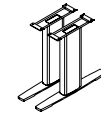

Tops are 1/4" Thick

* Based on a chair width of 25".

L" x D"	Sugg Seat Capacity*	Top Finish	Top Sections	Model Number	2 T-Bases	List Price	Model Number	2 T-Bases	List Price
96 x 48	6 - 8	Wood	1	56301/2	(2-28")	8,690	56341/2	(2-28")	7,180
96 x 48	6 - 8	P-Lam	1	56302/5	(2-28")	7,425	56342/5	(2-28")	5,915
108 x 48	8 - 10	Wood	1	56303/2	(2-28")	9,345	56343/2	(2-28")	7,845
108 x 48	8 - 10	P-Lam	1	56304/5	(2-28")	7,920	56344/5	(2-28")	6,430
120 x 48	8 - 10	Wood	2	56305/2	(2-28")	10,760	56345/2	(2-28")	9,255
120 x 48	8 - 10	P-Lam	2	56306/5	(2-28")	9,180	56346/5	(2-28")	7,675
120 x 54	8 - 10	Wood	2	56307/2	(2-30")	12,000	56347/2	(2-30")	10,395
132 x 48	8 - 10	Wood	2	56308/2	(2-28")	11,665	56348/2	(2-28")	10,175
132 x 54	8 - 10	Wood	2	56309/2	(2-30")	12,900	56349/2	(2-30")	11,315

These models are constructed without support rails – bases are attached directly to tops.

Mirror-polished

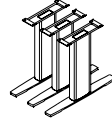

Anodized Finish

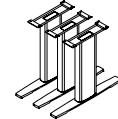

Tops are 1/4" Thick

* Based on a chair width of 25".

L" x D"	Sugg Seat Capacity*	Top Finish	Top Sections	Model Number	3 T-Bases	List Price	Model Number	3 T-Bases	List Price
144 x 48	10 - 12	Wood	2	56310/2	(3-28")	14,130	56350/2	(3-28")	11,880
144 x 54	10 - 12	Wood	2	56311/2	(3-30")	15,655	56351/2	(3-30")	13,240
144 x 60	10 - 12	Wood	2	56312/2	(3-32")	16,730	56352/2	(3-32")	14,305
156 x 48	10 - 12	Wood	2	56313/2	(3-28")	15,020	56353/2	(3-28")	12,765
156 x 54	12 - 14	Wood	2	56314/2	(3-30")	16,635	56354/2	(3-30")	14,225
156 x 60	12 - 14	Wood	2	56315/2	(3-32")	17,845	56355/2	(3-32")	15,415
156 x 66	12 - 14	Wood	2	56316/2	(3-34")	19,115	56356/2	(3-34")	16,575
168 x 48	12 - 14	Wood	2	56317/2	(3-28")	16,605	56357/2	(3-28")	14,345
168 x 54	12 - 14	Wood	2	56318/2	(3-30")	18,335	56358/2	(3-30")	15,930
168 x 60	12 - 14	Wood	2	56319/2	(3-32")	19,655	56359/2	(3-32")	17,230
168 x 66	12 - 14	Wood	2	56320/2	(3-34")	21,055	56360/2	(3-34")	18,495
180 x 48	12 - 14	Wood	3	56321/2	(3-28")	17,315	56361/2	(3-28")	15,050
180 x 60	14 - 16	Wood	3	56322/2	(3-32")	20,540	56362/2	(3-32")	18,110
180 x 66	14 - 16	Wood	3	56323/2	(3-34")	22,020	56363/2	(3-34")	19,470
180 x 72	14 - 16	Wood	3	56324/2	(3-36")	24,005	56364/2	(3-36")	21,170

TABLE DIMENSIONING LAYOUT

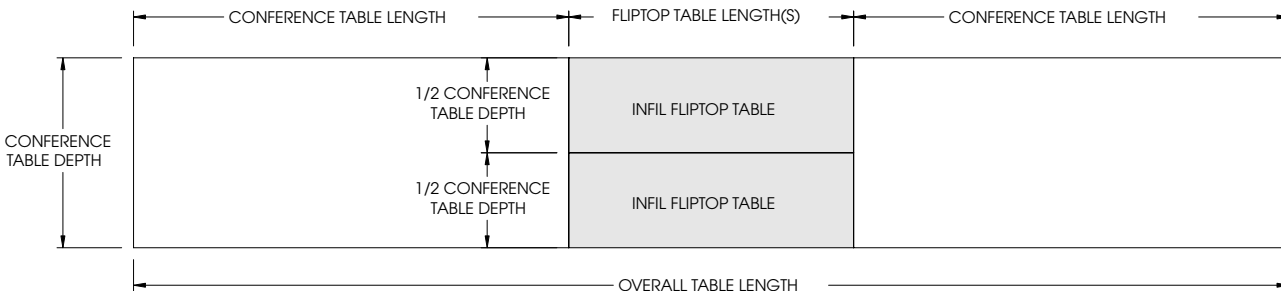

VOX® CONFERENCE TABLES

USED WITH INFILL FLIPTOP™ TABLES (PGS 33) DESIGN - MARK MÜLLER



Specify edge type; add the two letter code after the model number.

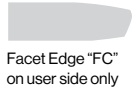

Facet Edge "FC"
on user side only

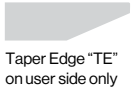

Taper Edge "TE"
on user side only



Flowform Edge "FF"
on user side only
5% upcharge
laminates not available

Mirror-polished

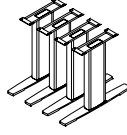

Anodized Finish

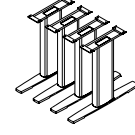

Tops are 1/4" Thick

* Based on a chair width of 25".

L" x D"	Sugg Seat Capacity*	Top Finish	Top Sections	Model Number	4 T-Bases	List Price	Model Number	4 T-Bases	List Price
192 x 54	14 - 16	Wood	4	56325/2	(3-30")	22,290	56365/2	(3-30")	19,070
192 x 60	14 - 16	Wood	4	56326/2	(3-32")	23,870	56366/2	(3-32")	20,620
192 x 66	14 - 16	Wood	4	56327/2	(3-34")	25,545	56367/2	(3-34")	22,135
192 x 72	14 - 16	Wood	4	56328/2	(3-36")	27,865	56368/2	(3-36")	24,095
204 x 54	14 - 16	Wood	4	56329/2	(4-30")	23,105	56369/2	(4-30")	19,880
204 x 60	16 - 18	Wood	4	56330/2	(4-32")	24,785	56370/2	(4-32")	21,530
204 x 66	16 - 18	Wood	4	56331/2	(4-34")	26,545	56371/2	(4-34")	23,145
204 x 72	16 - 18	Wood	4	56332/2	(4-36")	28,955	56372/2	(4-36")	25,175
216 x 54	16 - 18	Wood	4	56333/2	(4-30")	24,525	56373/2	(4-30")	21,315
216 x 60	16 - 18	Wood	4	56334/2	(4-32")	26,335	56374/2	(4-32")	23,095
216 x 66	16 - 18	Wood	4	56335/2	(4-34")	28,240	56375/2	(4-34")	24,850
216 x 72	16 - 18	Wood	4	56336/2	(4-36")	30,815	56376/2	(4-36")	27,015
228 x 54	16 - 18	Wood	4	56337/2	(4-30")	25,540	56377/2	(4-30")	22,325
228 x 60	16 - 18	Wood	4	56338/2	(4-32")	27,465	56378/2	(4-32")	24,225
228 x 66	18 - 20	Wood	4	56339/2	(4-34")	30,070	56379/2	(4-34")	26,690
228 x 72	18 - 20	Wood	4	56340/2	(4-36")	32,155	56380/2	(4-36")	28,380

EDGE PROFILING

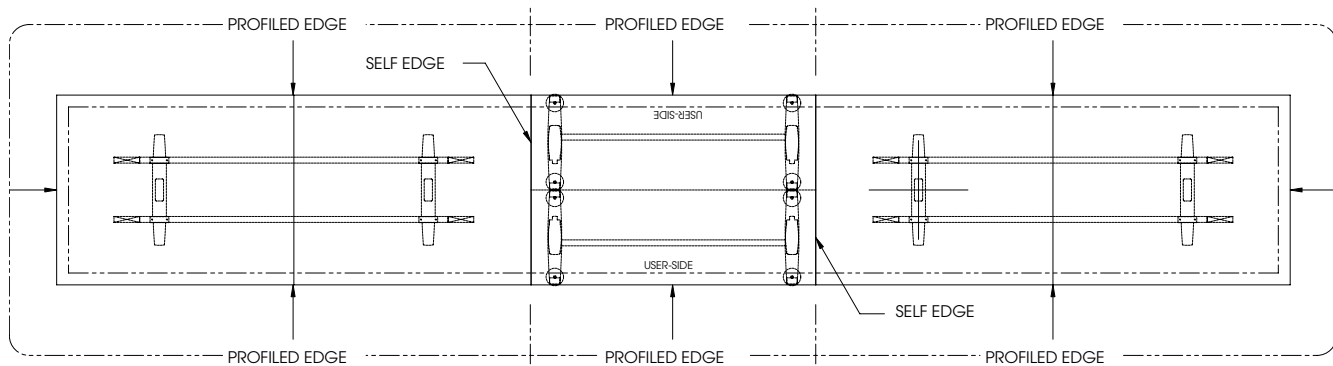

VOX® CONFERENCE ROOM LAYOUTS

DRAWINGS NOT TO SCALE

ROOM 3 – LAYOUT A1: LARGE BOARDROOM INTEGRATION

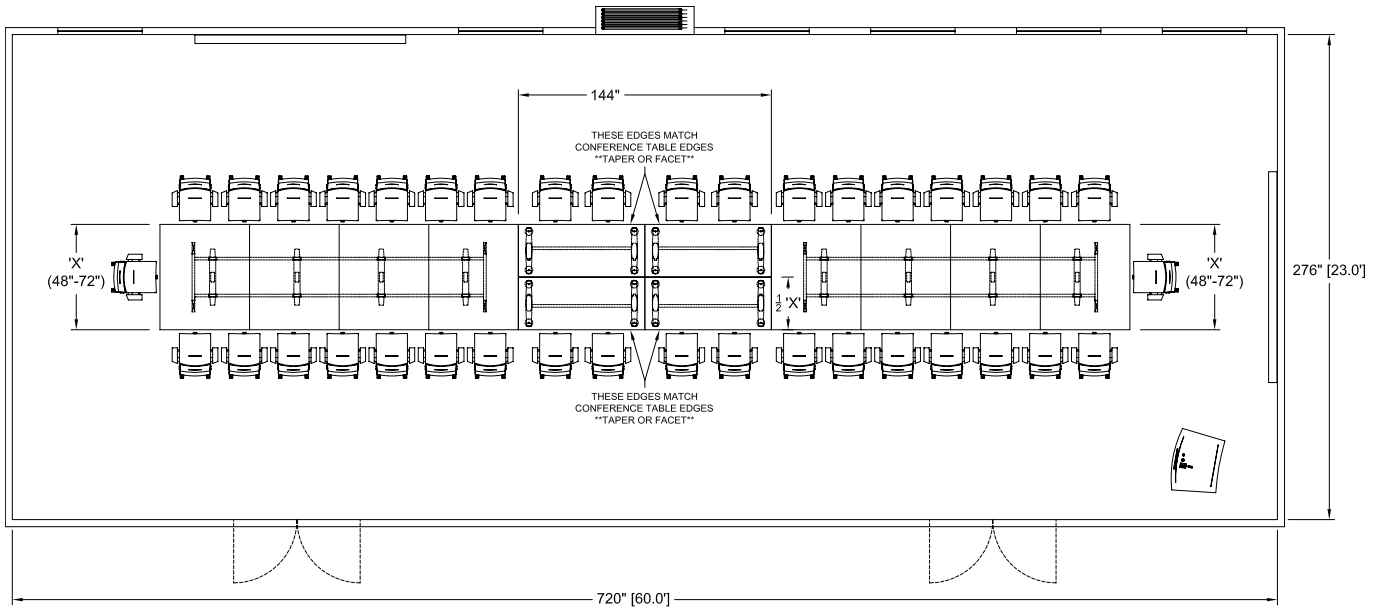

ROOM 3 – LAYOUT A2

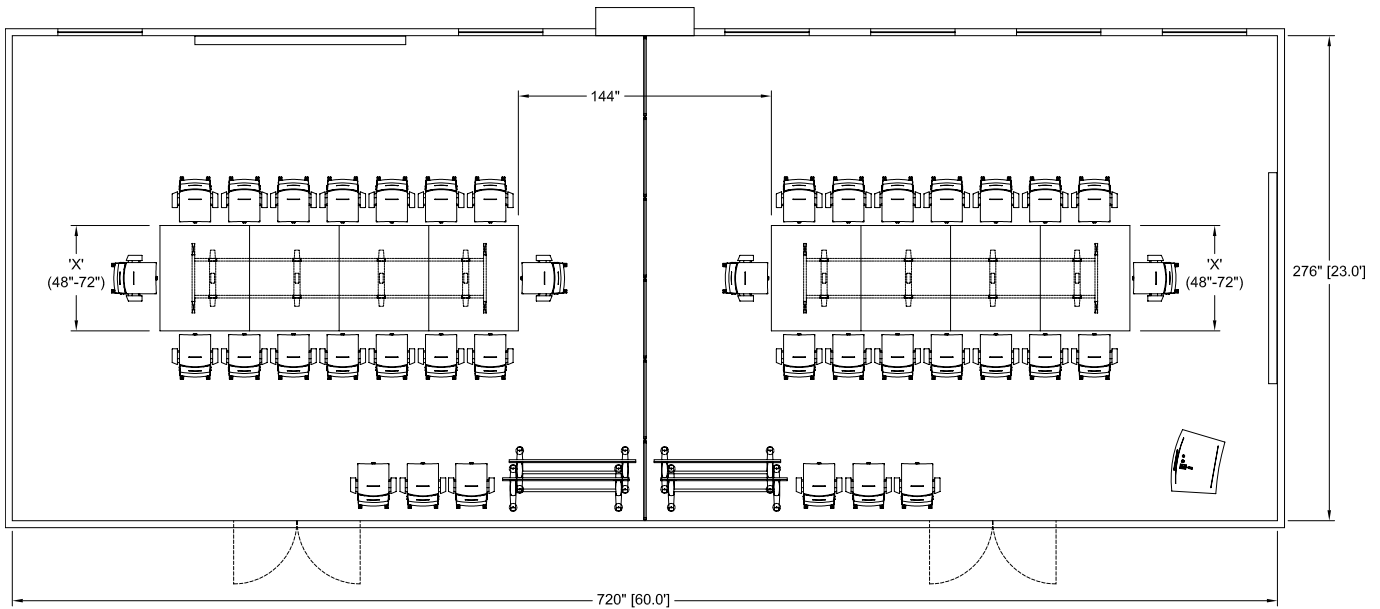

Product Name	Model Number	List Price
4-Vox® FlipTop™ 72" x 30" tables	56255/2	19,185
2-Vox® Rectangle Shape Conference tables, 204" x 60", with T-Bases	56370/2	43,055
1-Vox® Presenter's Lectern	23465	9,685
2-120" Vox® Presentation Walls	23494/2	16,810
38-NOW® Conference Chairs, with casters	13022	80,630
Total		169,365

ROOM 4 – LAYOUT B1: SMALL BOARDROOM INTEGRATION

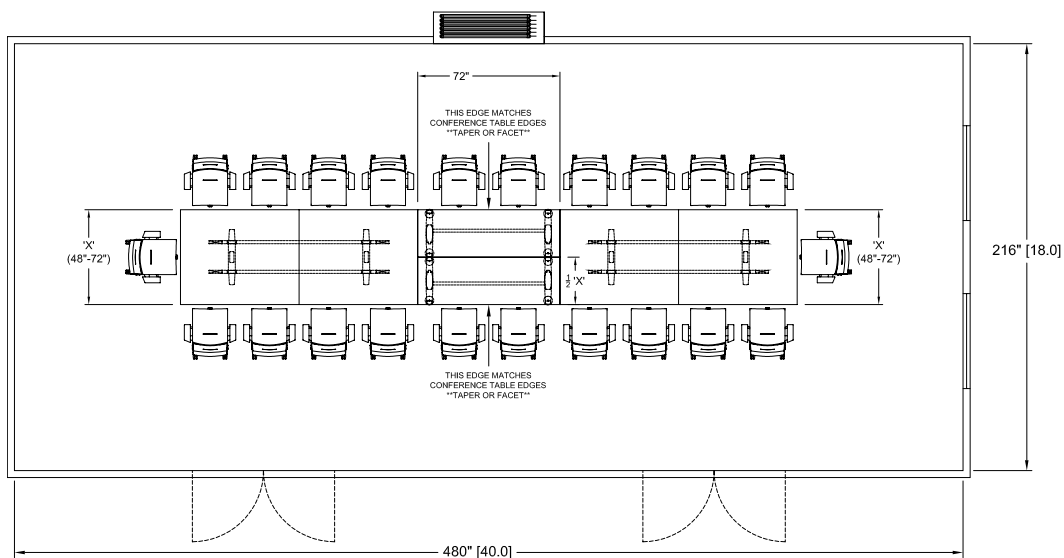

ROOM 4 – LAYOUT B2

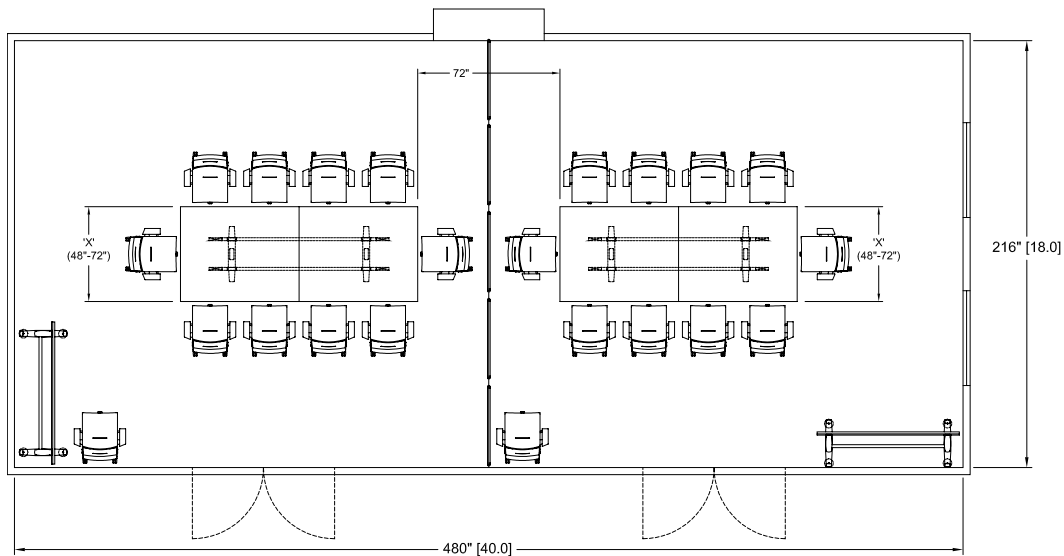

Product Name	Model Number	List Price
2-Vox®FlipTop™ 72" x 24" tables	56215/2	8,950
2-Vox® Rectangle Shape Conference tables, 120" x 48", with T-Bases	56345/2	18,505
22-NOW® Conference Chairs, with casters	13022	46,680
Total		74,135

TERMS AND CONDITIONS OF SALE

PRICES

All prices are list prices, freight included, blanket-wrapped, dock delivered, from the manufacturing source to any location in the contiguous United States.

Brokerage is paid by Nienkämper for product shipped to the United States.

Due to existing conditions in regard to cost of labor and materials, we reserve the right to change prices without notice.

TERMS

Net 30 days from date of invoice to accredited buyers. Two per cent (2%) interest charged monthly on overdue accounts. Deposit of 50% is required with order. Terms will be established upon credit evaluation. Due to delays in processing references, first orders may be treated as C.B.D. orders.

ORDER CONFIRMATION

Orders are accepted upon issuance of our order confirmation and are subject to the terms set forth therein; notwithstanding any variance from the terms of the buyer's order form.

Nienkämper is not liable for any delay or failure to deliver caused by labor or transportation difficulties, accidents, acts of God, failure of sources of supply, or other causes beyond our control, and changes will affect the delivery date.

CHANGE OF ORDERS OR CANCELLATIONS

Changes or cancellations are subject to our ability to conform. A charge will be levied against cancelled or changed orders based on costs already incurred by Nienkämper. All changes must be in writing and submitted on a revised purchase order. Changes will affect the delivery date.

STORAGE

If goods cannot be accepted when ready, we may transfer them to storage (which is to be deemed as delivery for invoice purposes). The customer accepts risks and will be charged at prevailing rates.

FREIGHT

Prices include freight charges, blanket-wrapped, dock delivered, from the manufacturing source to any location in the contiguous United States. Packing and/or crating are available, if required, upcharges apply.

CLAIMS

All furniture is given to the carrier and signed for in good condition. It is the responsibility of the receiver to sign for the goods in the presence of the carrier and note the condition in which they are received. Freight claims should be filed with the carrier.

WARRANTY

There are no express or implied warranties, conditions and obligations of the manufacturer, whether statutory or otherwise that extend beyond the description on the face hereof. Our furniture is made to the highest standard and is warranted free from defects of material and workmanship for five years from the date of delivery. During the warranty period we will repair or replace such merchandise as shall prove to be defective, during normal usage in accordance with manufacturer's specifications. The manufacturer shall not be liable for defect wholly attributable to normal manufacturing process. Replacement or repair of the Product shall be the sole remedy of the Customer, and the manufacturer shall not be liable for any direct, indirect, incidental, or consequential loss or damage suffered by the Customer by reason of any defect in workmanship or manufacture of the Product or inability to use the Product. Moreover, this warranty does not cover accidental damage, abuse, alteration, ordinary wear and tear of Goods, negligence and misuse nor variations over which we have no control such as heat or humidity or damage to which the Goods are connected that is not attributable to the failure of the goods themselves. This warranty is null and void when the product is installed with hardware other than that supplied and/or when installed differently than recommended in the installation guide. Modification to the product or hardware may result in failure of the product and cause damage and/or injury.

WOOD FINISHES

Nienkämper offers a wide variety of standard light finishes on cherry, mahogany and figured anigre wood veneers, and a clear natural finish on figured anigre, figured sycamore, maple, bird's eye maple and curly maple.

Light finishes do not mask the grain and other characteristics of each wood species. It is important to understand that pieces of the same type of wood will not look identical when a light finish is used. The appearance of the finish will also depend on the natural color of the veneer. Cherry darkens over time as the wood ages. Pin knots and gum pockets are inherent traits.

Wood is a naturally variable raw material; its variances are not within the furniture manufacturer's control and are therefore not considered defects under this warranty.



VOX FLIPTOP

